



Free Downloads of Build Instructions,
Assembly Booklets & How To Guides

BuildInstructions.com

£7.99

AUS: 19.99 Inc. GST

NZS: 19.99 Inc. GST



MORTAL REALMS



BATTLE GAMES IN THE AGE OF SIGMAR

- XANDRIA AZUREBOLT •
- LEARN ABOUT KNIGHTS-INCANTOR •
- PLAY A GAME WITH YOUR NEW HERO •



Contents: 1x Plastic Miniature
Product Code: 60242399014

Manufactured by:
Games Workshop, Willow Road,
Nottingham, NG7 2WS, UK
Represented by:
Games Workshop Deutschland GmbH,
Am Wehrbahn 32, 40211 Düsseldorf, Deutschland



Not suitable for children under 12 years. For use under adult supervision. Read the instructions before use. Follow them and keep them for reference. Small parts. Sharp points. Retain packaging for future reference. Paint contains CMIT/MIT / CAS No. 55963-84-9.

HOW TO BUILD XANDRIA AZUREBOLT

Below is a simple stage-by-stage guide to building Xandria Azurebolt. Follow the guide carefully and make sure you take care when clipping the model from the frame and assembling it.

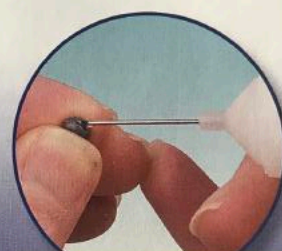

CAREFUL CLIPPING Clip out the fragile parts first to reduce the strain on the thinnest sections.

CAREFUL GLUEING If you use too much glue, excess can be soaked up with a bit of kitchen towel.



CLIPPER AND GLUE SAFETY

To remove your models from their sprues, you will need a set of modelling clippers. Games Workshop sells a set of clippers specially designed for this job, with flat-edged blades. You must follow all the instructions and guidance provided with the clippers.



Hold your clippers like so, with your fingers cushioning one arm and your thumb to apply pressure on the other. To cut a component from the sprue, gently squeeze until the blades meet.



This model will need to be glued together. Apply glue to the areas highlighted in yellow on the reverse of this page. Apply glue in a well-ventilated area and try not to use too much of it.

XANDRIA AZUREBOLT

Each component has its own number, which is shown on the sprue next to that component.
Use these numbers to find the right bits to make Xandria Azurebolt, as shown below.

1

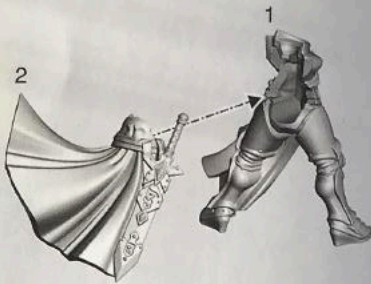

2

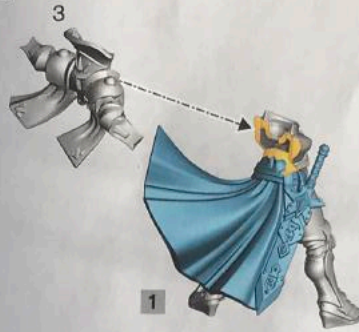

3

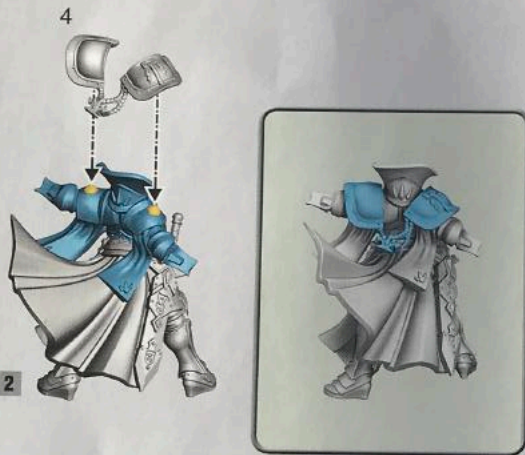

4



5





HOW TO PAINT

XANDRIA AZUREBOLT



RETRIBUTOR ARMOUR

In this paint guide you will be applying a basecoat of Retributor Armour to your new miniature. Follow the guide carefully and ensure you coat the model completely and end up with a smooth and even gold finish.

You will need your pot of Retributor Armour paint, your paint brush, and some water.



1 Thin your paint slightly with water before applying it. If the paint is too thick it may clog up and obscure details.

FIRST COAT



2 You won't need to paint the base on this model. Don't worry if you get some gold paint on it though, as you'll paint over it later.

SECOND COAT



3 Make sure you get the brush into the recesses and fine details as well. This will be much easier with thinned paint.

FINAL COAT



The first coat of gold may not cover all of the grey plastic. Let it dry before applying another.



After the second coat, the model looks much more gold, but is still a little dull. One more coat should do it.



A third coat has done the trick. The model looks suitable shiny and gold without any detail being obscured.

YOUR FINISHED MODEL... FOR NOW!

You're finished! With Xandria Azurebolt primed, you can set her aside to dry and then get ready to use her in your next playthrough. We'll be returning to this model soon to add more paint and colours to make sure she looks as impressive as a Knight-Incantor should!



Make sure no bare plastic still shows. If you do need to apply another coat to some areas, make sure the model is dry first.



PAINTING BRINGS YOUR MODELS TO LIFE!