



Free Downloads of Build Instructions,  
Assembly Booklets & How To Guides

**BuildInstructions.com**

# WARHAMMER™

## THE OLD WORLD

WARRIORS OF CHAOS  
WARPFIRE DRAGON





**Components**

- 1. Plastic Right Wing
- 2. Plastic Left Wing
- 3. Plastic Left Body
- 4. Plastic Right Body
- 5. Head
- 6. Neck

- 7. Left Arm
- 8. Right Leg
- 9. Left Leg
- 10. Spinal Plate
- 11. Right Arm
- 12. Tail Fin

- 13. Spine A
- 14. Spine B
- 15. Spine C
- 16. Base and Tail

Before assembling the model, wash each part thoroughly with an abrasive brush, such as a toothbrush, to remove any model release agent that may still be on the surface of the parts. Then, remove any excess resin such as mould lines, casting gates, vents and shims. For a more detailed guide to working with resin models, go to the Downloads section of the Warhammer Community website.

To glue resin pieces together or resin and plastic pieces together, use super glue.



1

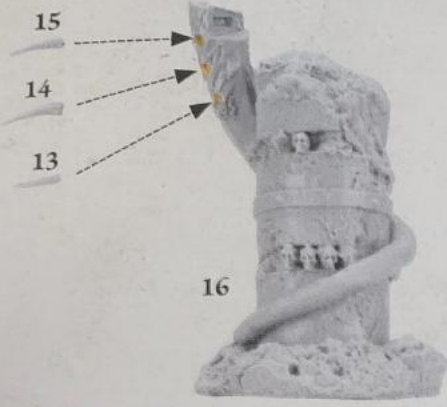

2

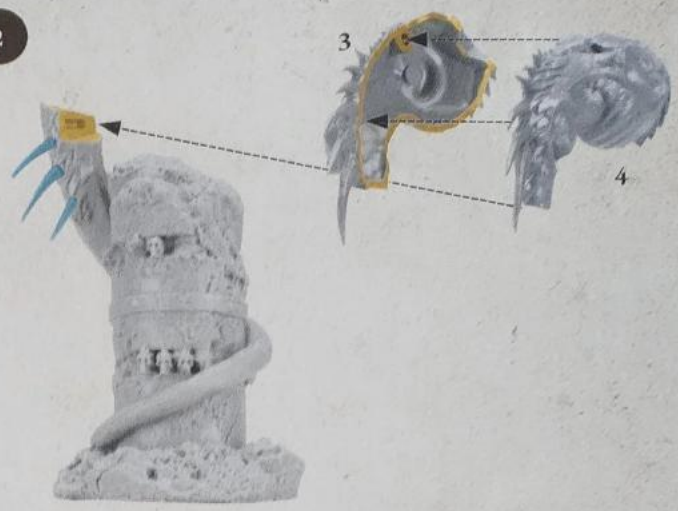

3



4



5



6







© Copyright Games Workshop Limited 2024.  
Warhammer: the Old World, Citadel, Forge World, Games Workshop, GW, Warhammer, the 'winged-hammer'  
Warhammer logo, and all associated logos, names, races, vehicles, weapons and characters are either  
® or TM, and/or © Games Workshop Limited. All Rights Reserved.



993227010054