

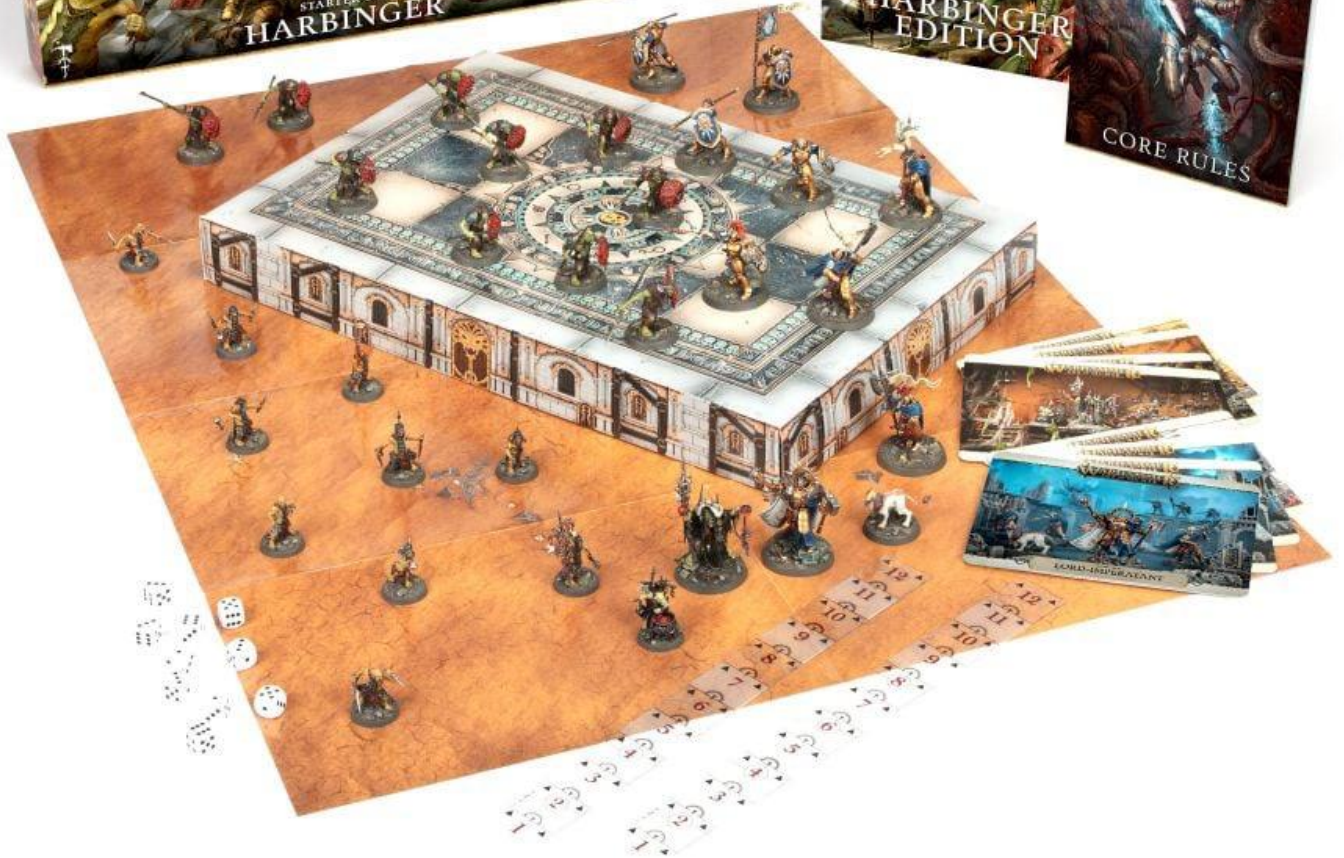

Free Downloads of Build Instructions,
Assembly Booklets & How To Guides

BuildInstructions.com

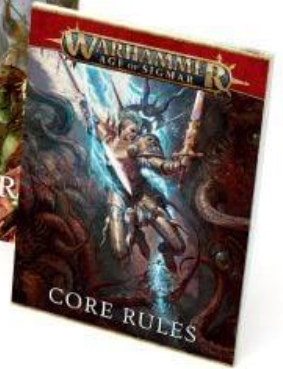
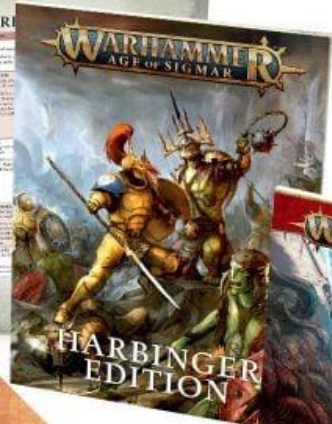
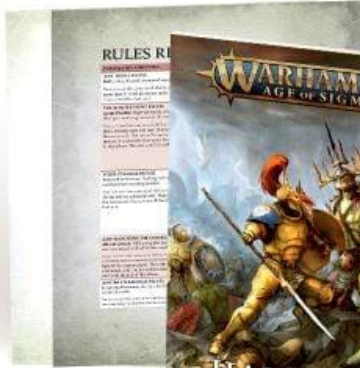

2 a

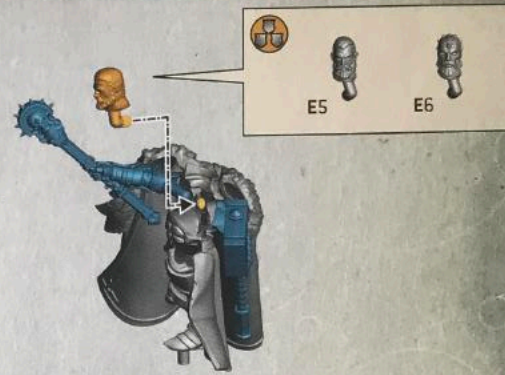
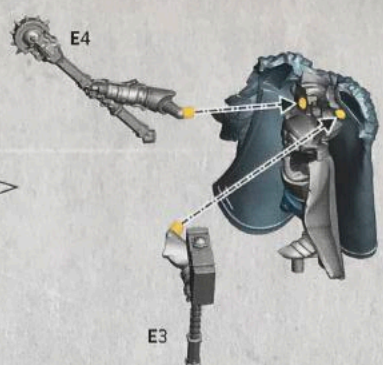
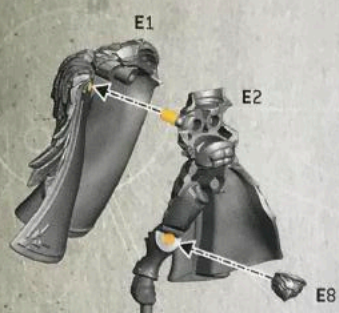

2 b

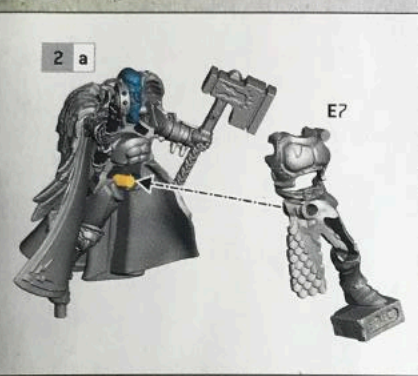

2 c

• Gryph-hound • Gryph-dog • Grifomastin • Gryphhund • Grifo-segugio
• グリフハウンド • 獅鷲犬

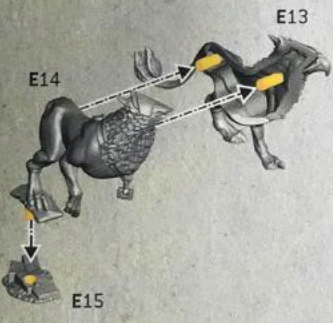

6 PRAETORS

• Praetors • Praectors • Pretores • Praectoren • Praector • プラエトール • 执行官

6 a

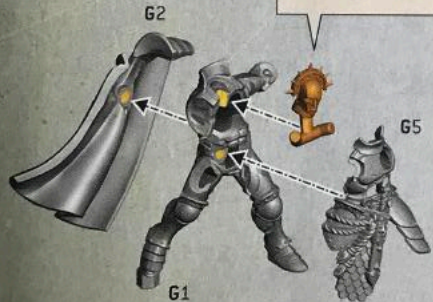

6 b

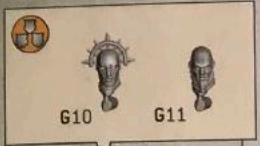

!



- Choose the variant you want to build
- Choisissez la variante à assembler
- Elige qué versión quieres montar
- Wähle die Variante, die du bauen möchtest
- Scegli la variante che vuoi assemblare
- 組み立てバリエーションの選択
- 选择你喜欢的拼装方式

6 c



• Praetor-Prime • Praetor-Prime • Pretor Mayor • Erster Praetor
 • Praetor Primus • プラエトール・プライム • 执行官精兵

6 c



• Praetors • Praetors • Pretores • Praetoren • Praetor • プラエトール • 执行官

6 c



6 c

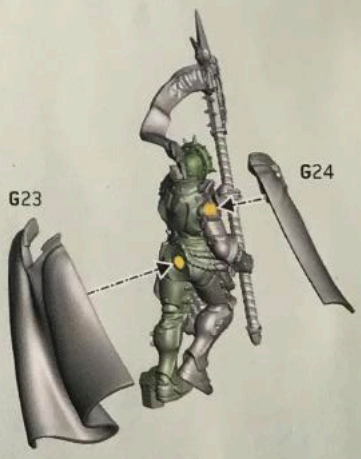
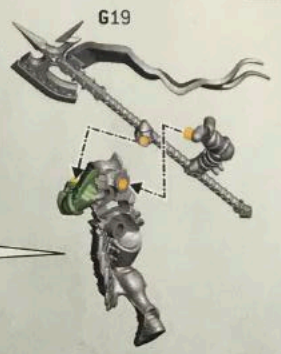

6 d x3



G8

G16

G25

6 a-c

ø 40mm



7 VINDICTORS

• Vindictors • Vindictors • Vindicadores • Vindictoren • Vindictor • ヴィンディクター • 悪悪者

7 a x1

• Azyrite Signifier • Signifere Azyrite • Portaemblema Azyrita • Azyritischer Symbolträger
• Portatore dell'Icona Azyrita • アズィライト・シグニファイア • 艾兹尔化身



B41

B42

B40

B48

B47

B46

B49

7 b x1



B41

B42

B40

B43

B45

B44

B46

B49

7 c x2



B27

B28

B22

B23

B24

B25

B26



7 d x2

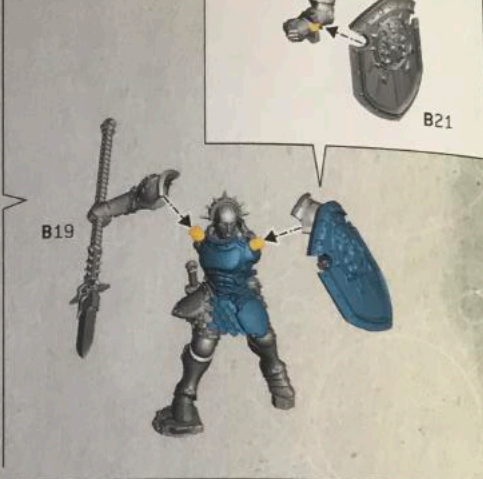
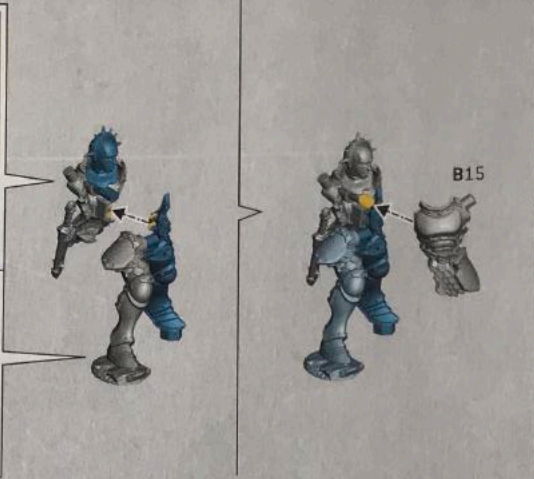
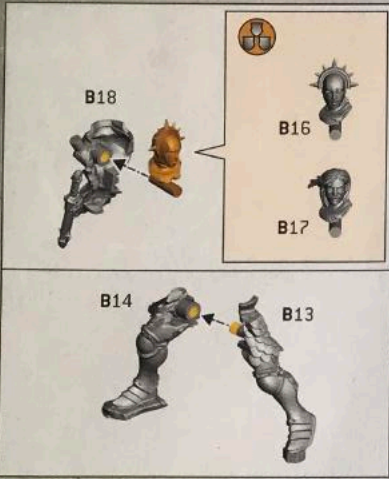

x1 • Vindictor-Prime • Vindictor-Prime • Vindicador Mayor • Erster Vindictor • Vindictor Primus • ヴインディクター・プライム • 悪悪者精兵

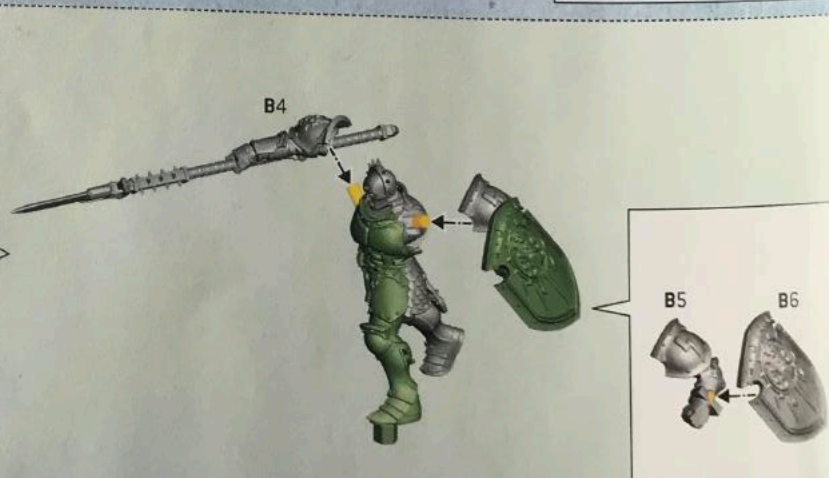
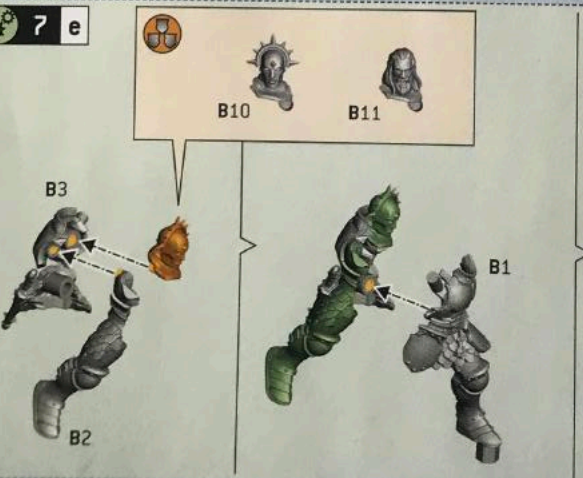
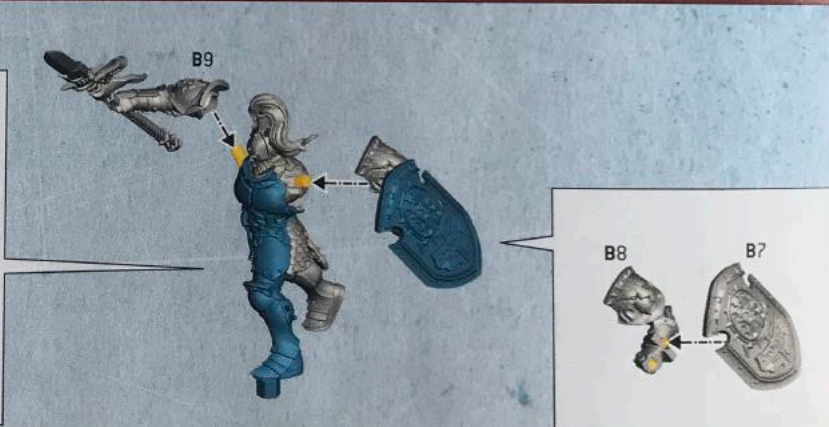
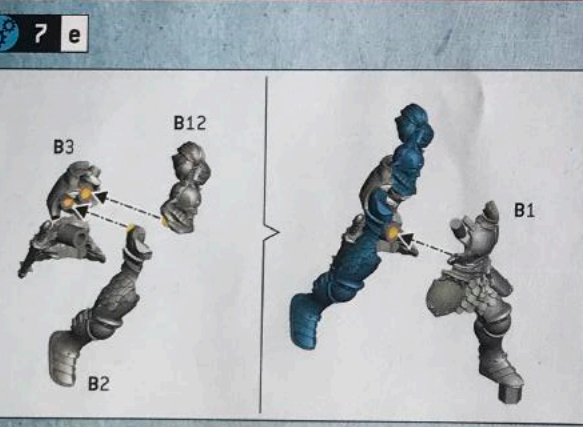
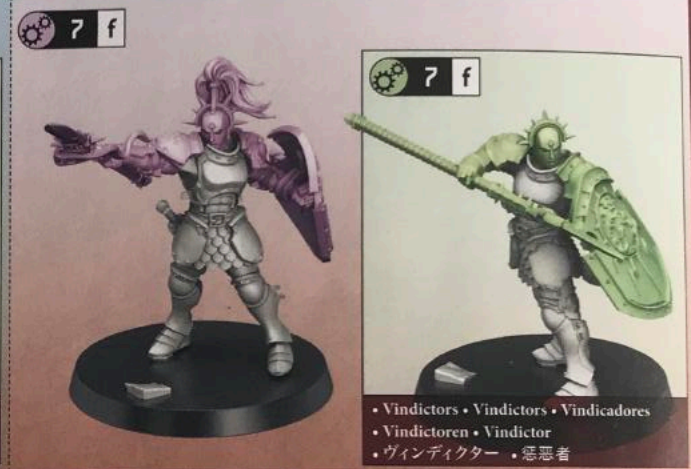

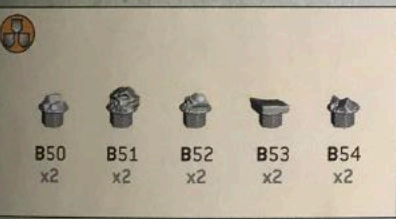
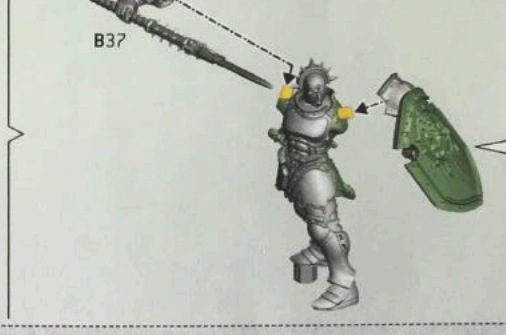
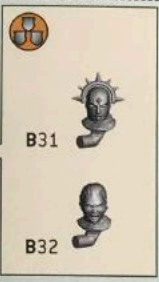
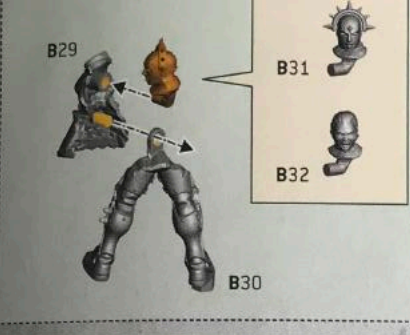
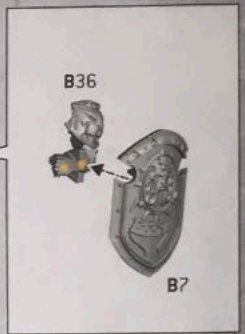
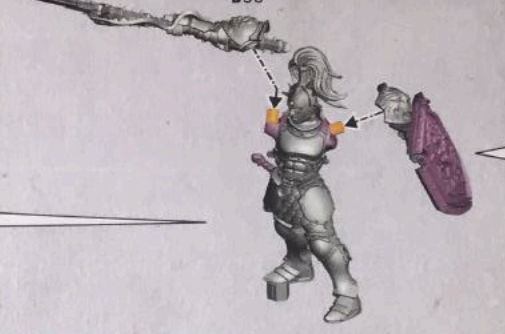
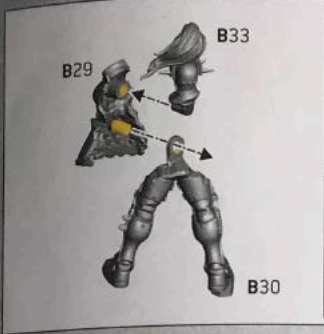

7 a-f

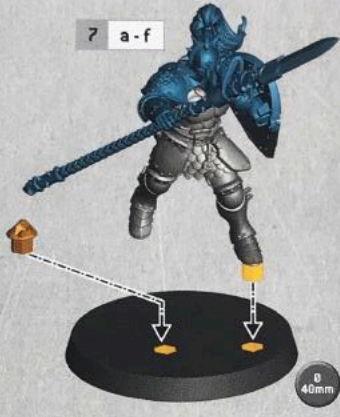

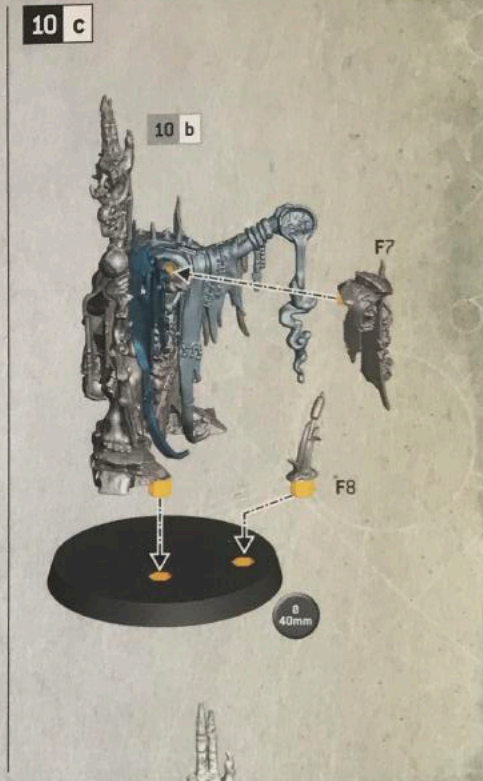
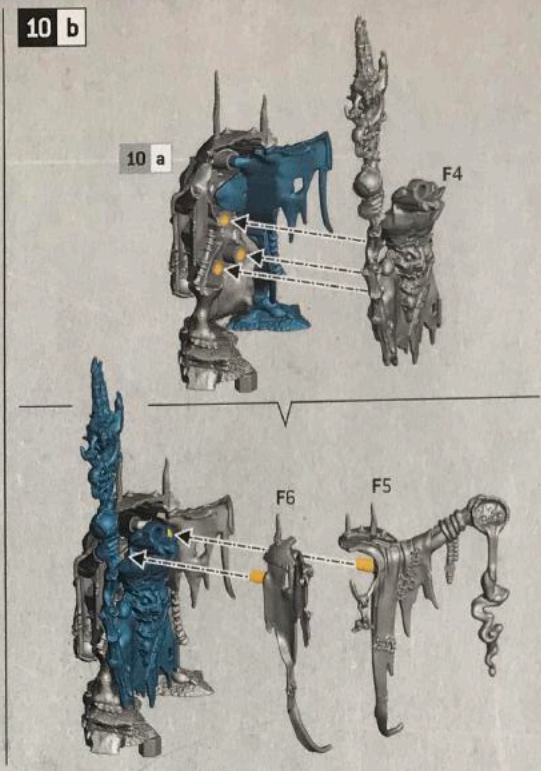
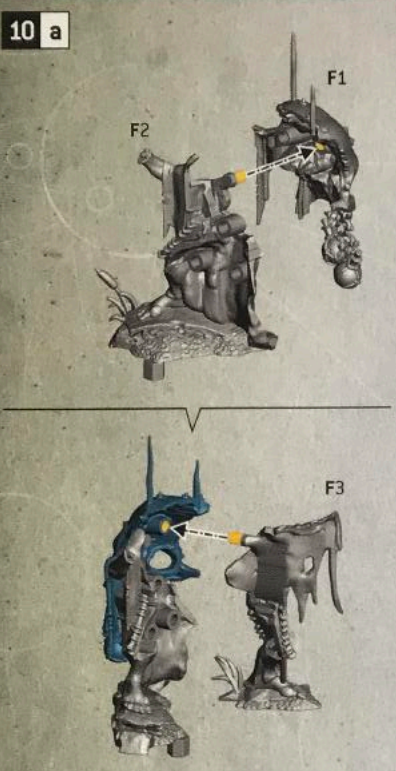

10 d • Pot-grot • Grot Touilleur • Grotikario • Topfgrot • Kakkola Kuciniera • ポットグロット • 授罐地精

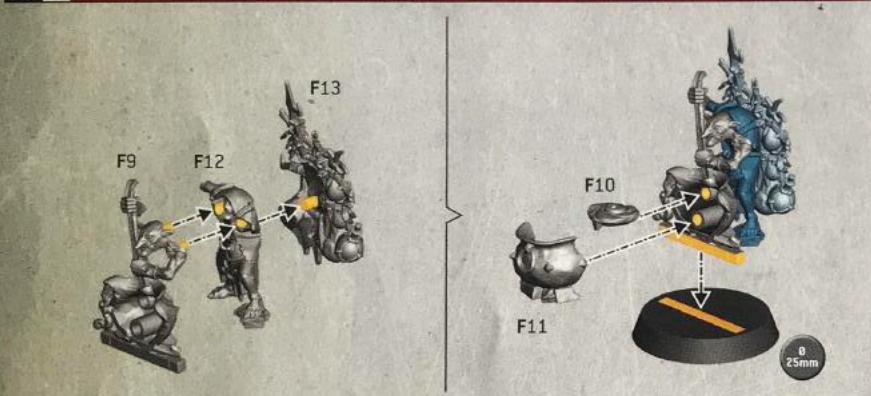

13 GUTRIPPAZ • Eventreurs • Klavatripaz • Wanstreißa • Zventrapanze • ガットスティッカ • 开膛手

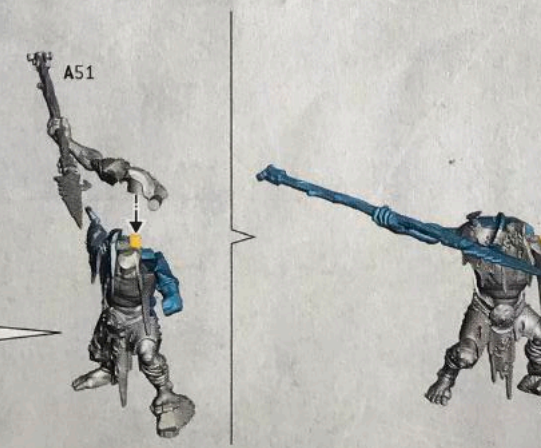
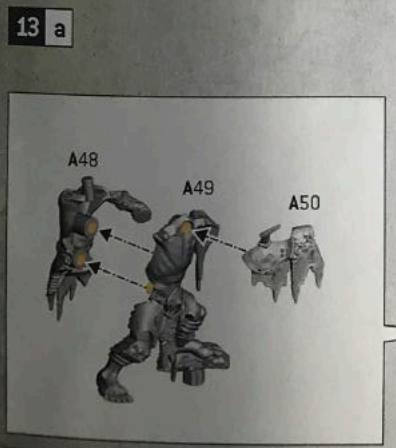

13 b

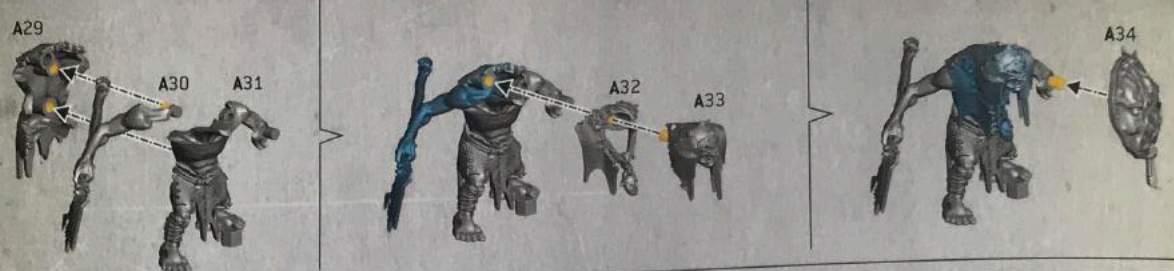

13 c

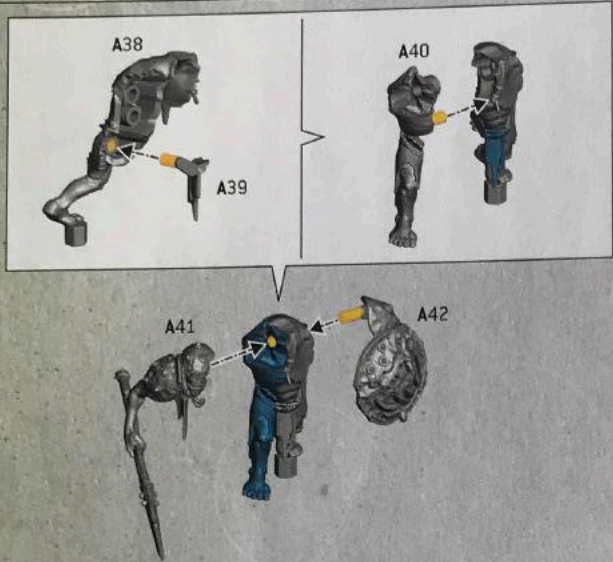

13 d

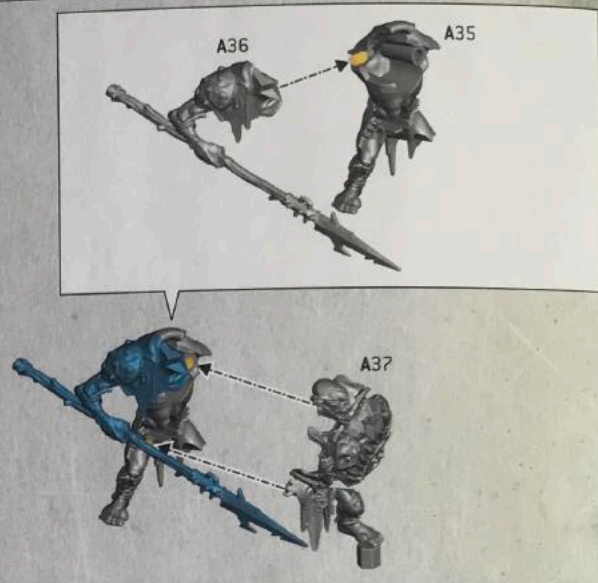

13 e



13 f

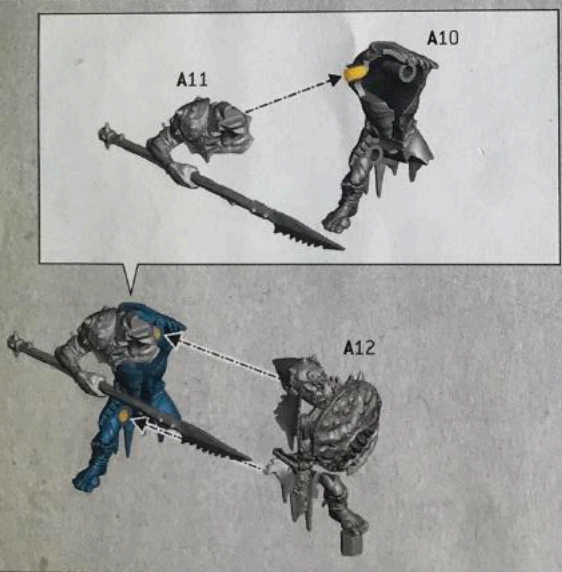

13 g

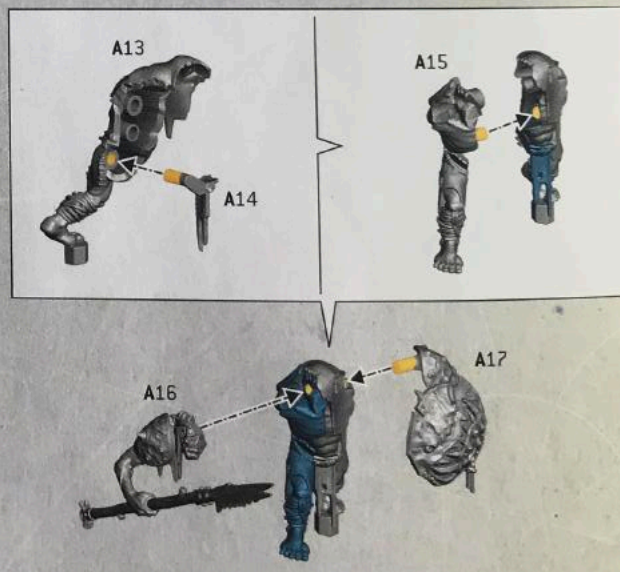

13 h



13 i

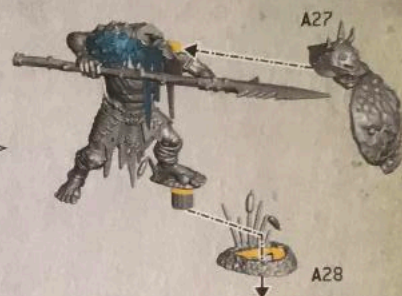
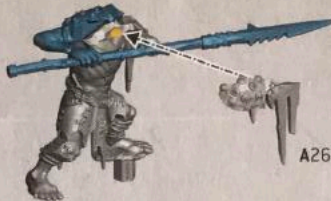
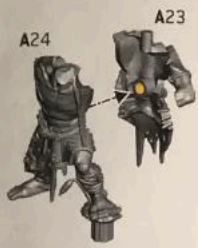

- Choose the variant you want to build
- Choisissez la variante à assembler
- Elige qué versión quieres montar
- Wähle die Variante, die du bauen möchtest
- Scegli la variante che vuoi assemblare
- 組み立てバリエーションの選択
- 选择你喜欢的拼装方式

13 j



• Gutrippa Boss • Boss Éventreur • Jefe Klavatripaz • Wanstreifa-Boss
 • Kapo Zventrapanze • ガットリッパボス • 开膛手头目

13 j



• Gutrippaz • Éventreurs • Klavatripaz • Wanstreifa • Zventrapanze
 • ガットリッパ • 开膛手

13 j

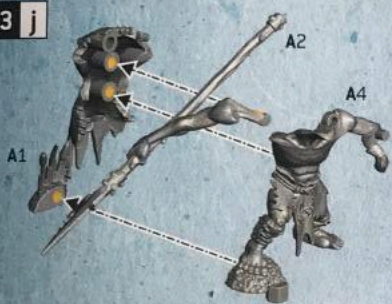

13 j

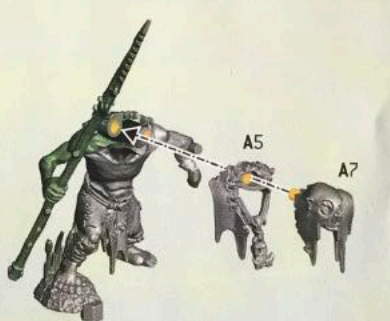
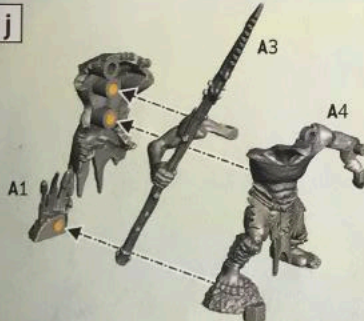

13 k x10



13 a-j



32mm



14 a • Hobgrot Boss • Boss Hobgrot • Jefe Hobgrot • Hobgrot-Boss • Grankakkola Kapo • ホブグロット・ボス • 搗乱地精頭目

- ! x1
- Choose the variant you want to build
- Choisissez la variante à assembler
- Elige qué versión quieres montar
- Wähle die Variante, die du bauen möchtest
- Scegli la variante che vuoi assemblare
- 組み立てバリエーションの選択
- 选择你喜欢的拼装方式

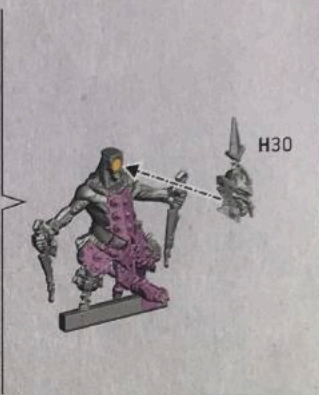
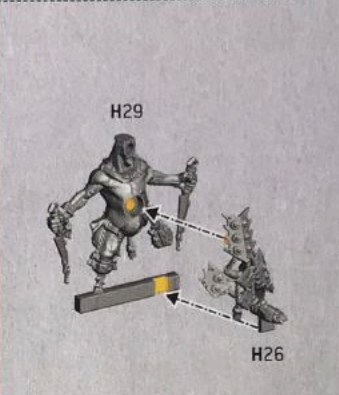
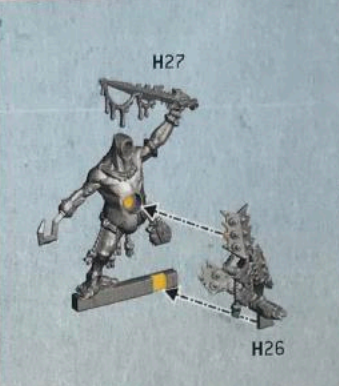

14 b-c • Scrap Totem Bearer • Porte-totem • Portacztandarte de Reztosz • Krcmpeltotemträger • Porta Zkartotem • スクラップ・トーテムベアラー • 废料图腾携带者

14 b

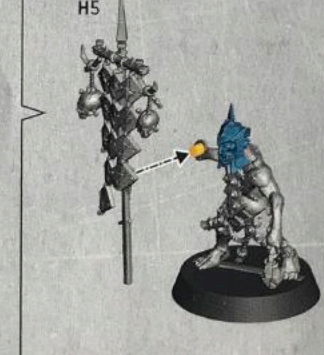
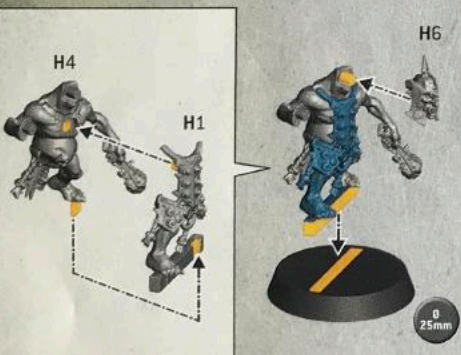

14 c

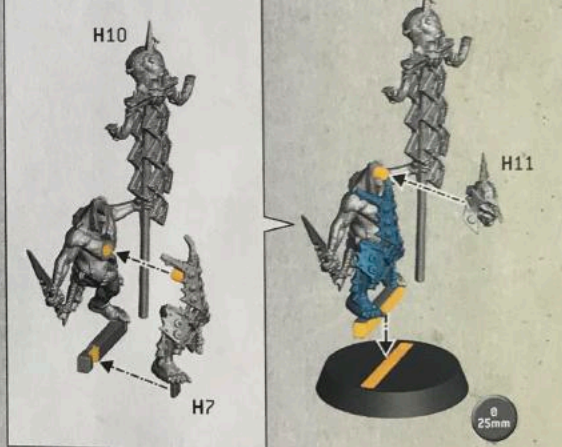

14 d-e • Noisc-maker • Tapageur • Ruidozo • Krachmacher • Kazinizta • ノイズメイカー • 噪音制造者

14 d

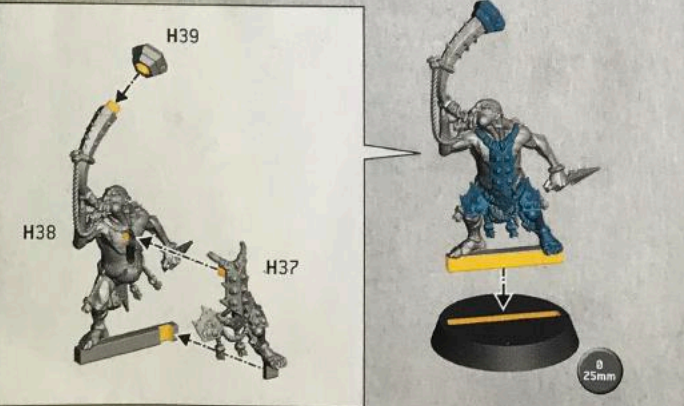

14 e

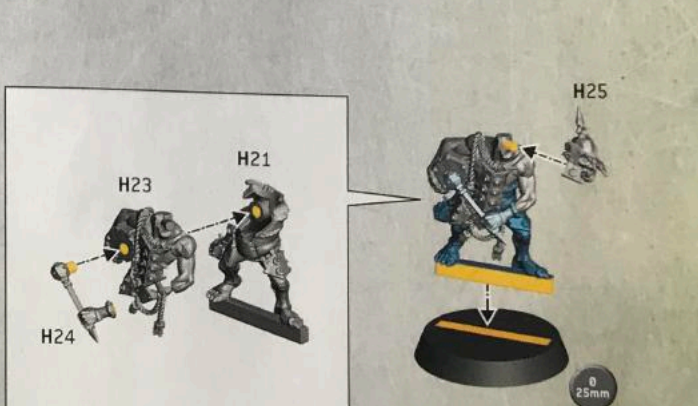

14 f

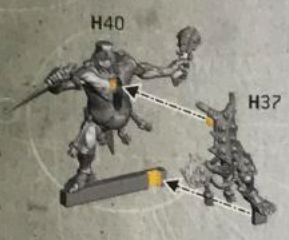

H41



Ø 25mm

14 g



H22



Ø 25mm

14 h

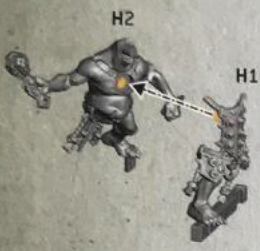

H3



Ø 25mm

14 i

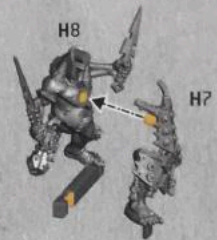

H9



Ø 25mm

14 j

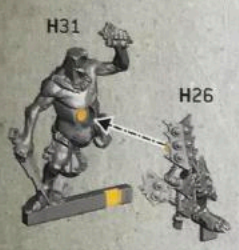

14 k x2

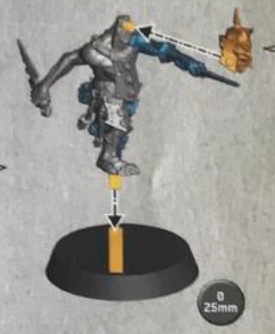
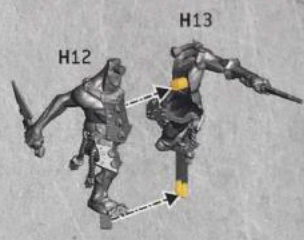

Ø 25mm

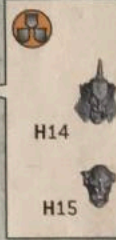

14 l x2

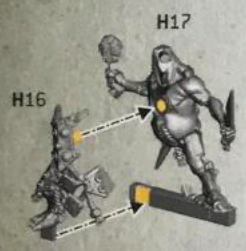

Ø 25mm

14 m x2



Ø 25mm

14 n x2

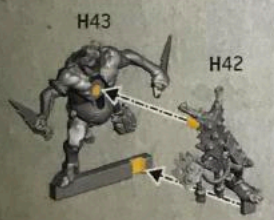

Ø 25mm

14 o x2

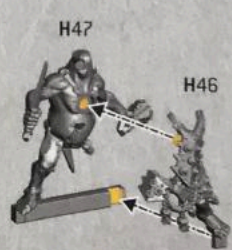
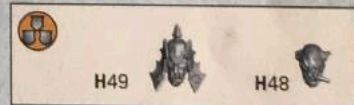

Ø 25mm

