



Free Downloads of Build Instructions,
Assembly Booklets & How To Guides

BuildInstructions.com



HOW TO BUILD PRIMARIS LIEUTENANT

- 1** First, slot the head into position on component 3, and carefully push components 2 and 3 together.

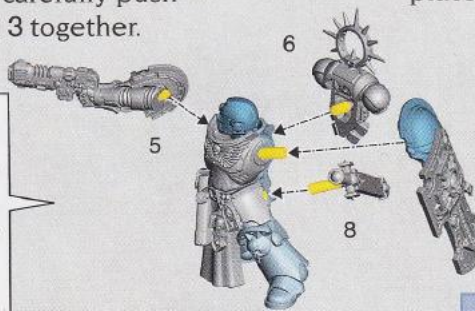
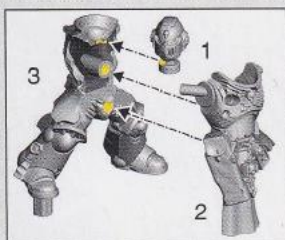

The sword must be pushed into place before the shield arm.

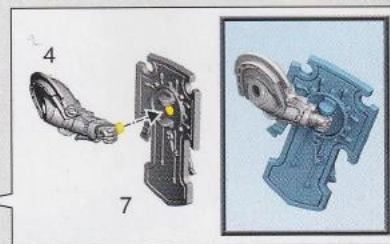

NUMBERING

Component numbers can be found on the sprue, next to each component.

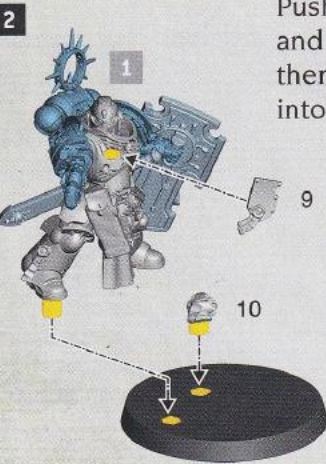

Push components 9 and 10 into place, then push the model into the base.



 Your Primaris Lieutenant is now fully assembled.



40mm

40MM BASE

Attach the Primaris Lieutenant to the 40mm base. This is the larger of the two bases.

HOW TO BUILD THE ASSAULT INTERCESSOR SERGEANT

The Assault Intercessor Sergeant is the leader of your squad of Assault Intercessors. There are two ways to assemble this miniature, and these options are explained below. In order to play the missions later in this book, we recommend that you construct your miniature using Option A.

OPTION A – HEAVY BOLT PISTOL

To build the Assault Intercessor Sergeant that features in the missions in this book, follow the instructions below. If you intend to later change your miniature's equipment to Option B, make sure that you don't glue components A11, A12 or A13 in place during assembly.

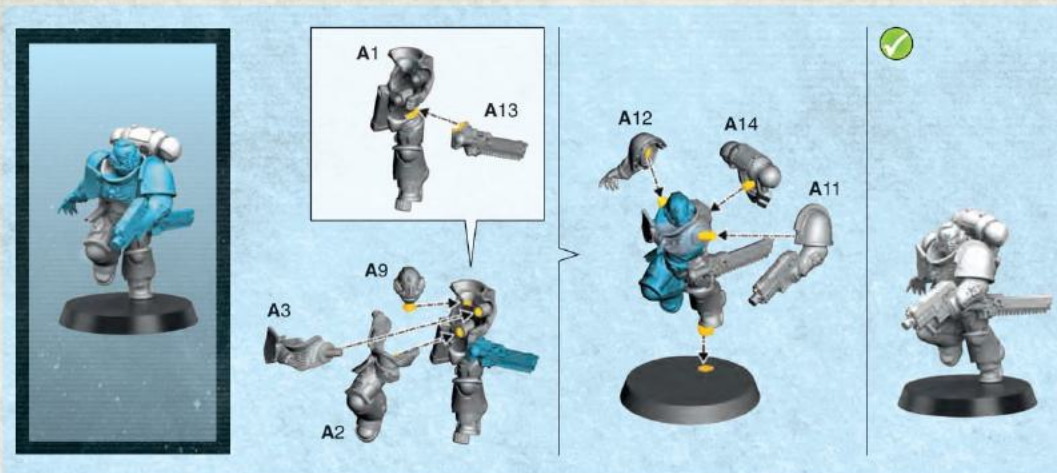

OPTION B – PLASMA PISTOL AND CHAINSWORD

To build your Assault Intercessor Sergeant with a powerful plasma pistol and a chainsword, follow the instructions below. If you wish to play the missions in this booklet, but then equip your Assault Intercessor Sergeant with these weapons later on, then we recommend not using glue when initially assembling the miniature. That way, you can clip out components A6 and A7 later and attach them instead.

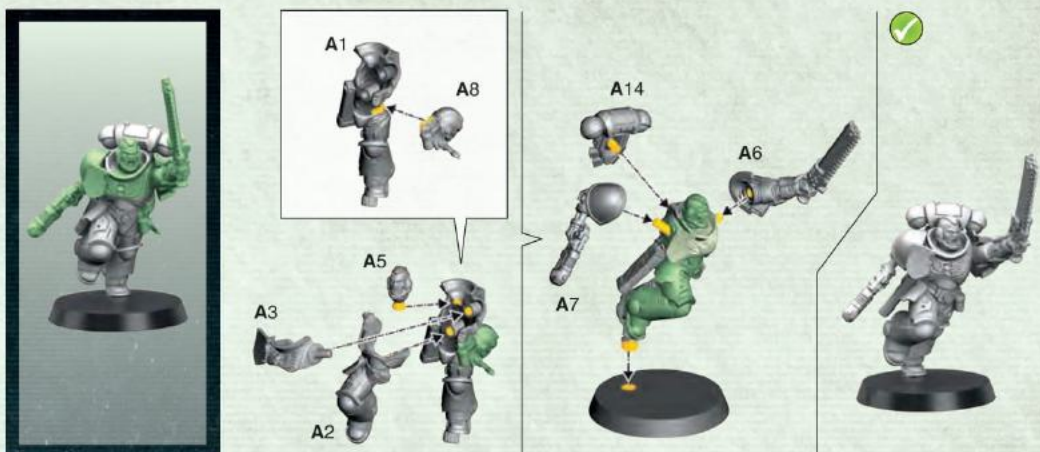

HOW TO BUILD THE ASSAULT INTERCESSORS

Below, you can find a simple, stage-by-stage guide to building the Assault Intercessors models that come in your Command Set. Building Citadel miniatures is a major part of the Warhammer 40,000 hobby, and one of the most satisfying aspects of it. Nearly all Citadel miniatures come in kit form on plastic frames called sprues, and are intended to be assembled using modelling tools and glue. Once built, they can then be painted in a range of colours in order to really bring them to life. To this end, Games Workshop produces a range of miniature assembly tools and a huge selection of specially formulated Citadel paints. Of course, if you are new to this hobby and have never built or painted miniatures before, this impressive range of assembly and painting resources might seem a bit daunting. Fortunately, by simply following the instructions on the following pages you will have all the information you need to get started. Then, you can dive into the wider world of collecting, building and painting at your own pace.

The miniatures in your Command set are designed to be push-fit. This means that they can be assembled without needing to use glue. Instead, simply push the components together as shown, gently but firmly. That said, if you wish to make your miniatures that bit more resilient, we recommend using Citadel plastic glue, which will fuse the plastic together for a permanent connection. The areas where this will be most effective are marked in yellow on the diagrams below.

CLIPPING OUT YOUR MODELS

To remove your model components from their sprues, you should use a set of Citadel fine detail cutters. Make sure to follow the instructions shown below, keeping the flat side of your cutting blades towards the sprue, and ensure that you always use this tool safely.



Hold your clippers like so, with your fingers cushioning one arm and your thumb applying pressure on the other.



To cut a component from its sprue, gently but firmly squeeze the clippers shut as shown, until the blades meet.

BUILDING YOUR FIRST MINIATURE

1



Before assembling your miniature, carefully clip all the pieces from the sprue, making sure not to leave any little bits of sprue – known as ‘tabs’ – attached. Before you assemble each miniature, it is a good idea to lay the components out and make sure you have everything. The components needed for this miniature are labelled on the diagrams above. For this first step, you will need the components A34, A35 and A36. You will find that these are clearly labelled on the sprue itself.

To start building your Assault Intercessor, first push the pin on component A36 – the helmet – into the socket shown on A34 – rear torso and right leg. Then, push the pin on A35 – front torso and left leg – into the other socket on A34. You now have the helmet, legs and torso complete!



Now you'll want to attach both arms and the backpack to your Assault Intercessor as shown above. The sockets on parts A37 – chainsword arm – and A38 – gun arm – will push onto the pegs on the torso, and A39 – backpack – will push into the socket in the back, as shown.

Finally, the miniature will need to be attached to its base. An Assault Intercessor goes on a 32 millimetre base, the size of which is shown to the right. Just push the peg on the foot into the hole on the base.

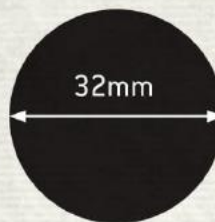

Congratulations, you have just assembled your first Citadel miniature and begun your Warhammer 40,000 collection! Above is a fully assembled, painted example of an Assault Intercessor just like the one you have built.

On the pages that follow you will find more assembly guides like this one. As any new concepts are introduced, they will be explained when you need them. Have fun assembling your miniatures!

2



3



4



11 a

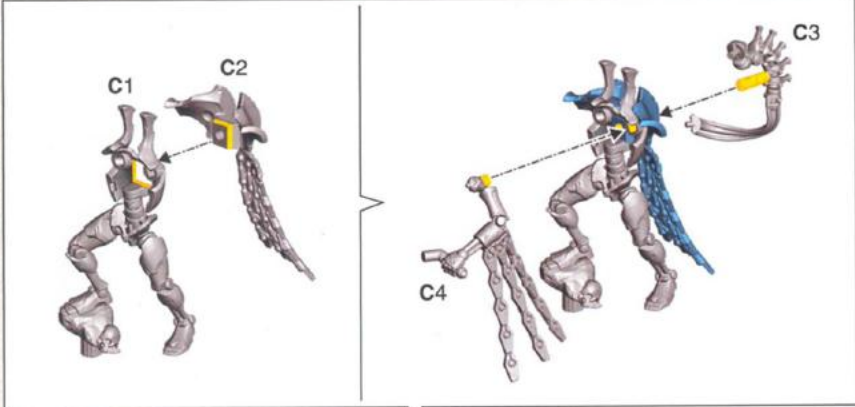

11 b

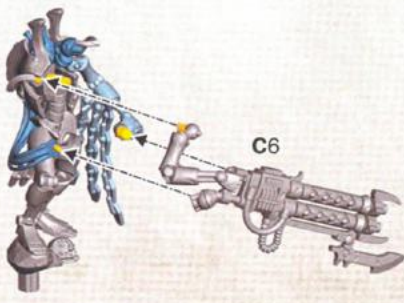
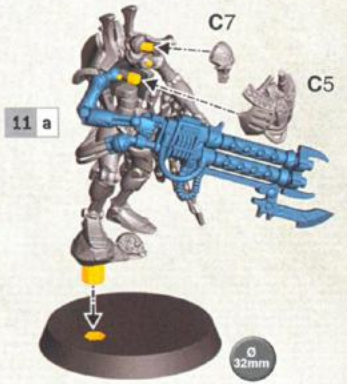

HOW TO BUILD THE NECRON WARRIORS

Below, you will find step-by-step guides to help you assemble a unit of Necron Warriors. These miniatures can be assembled in more than one way. Should you wish to be able to swap options later, remember not to glue the components in place during assembly.

WEAPON OPTIONS

Each Necron Warrior can be constructed with one of two weapon options – the gauss flayer or the gauss reaper. The missions in this book are designed to be played with Necron Warriors with gauss flayers, and this is how we recommend you build your miniatures. Should you opt to build your miniatures differently, you can have a mixture of gauss flayers and gauss reapers in the same unit.

HEAD OPTIONS

Each Necron Warrior can choose between two different types of head. The appropriate heads for each miniature are specified in their individual instructions.

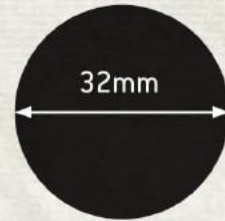

These miniatures should be assembled on a 32mm base.

1

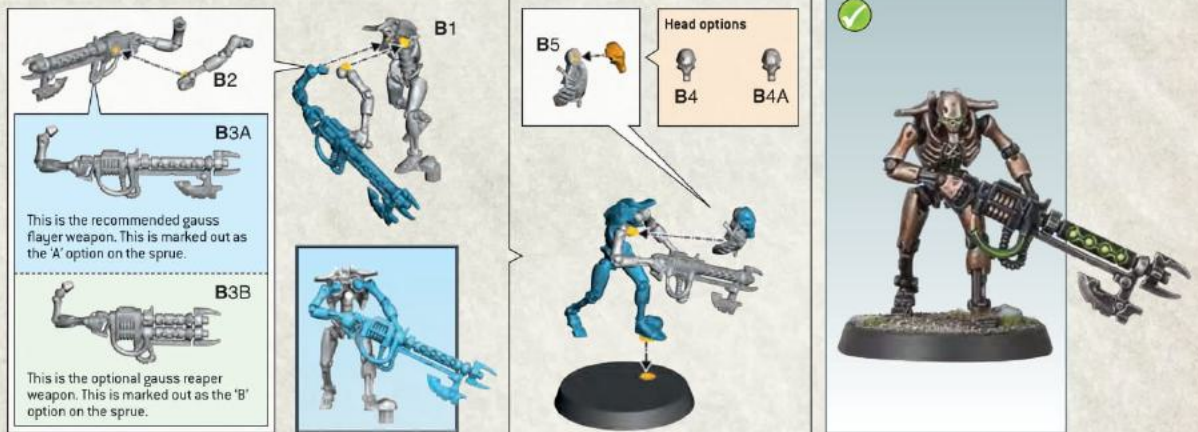

2



3



4

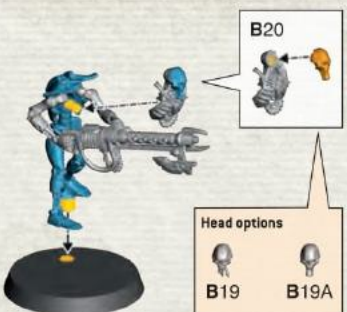
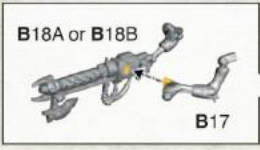

5

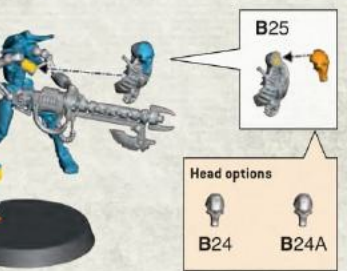
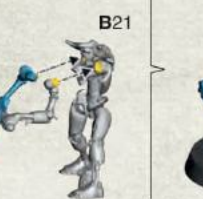
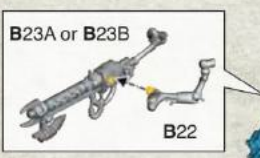

6

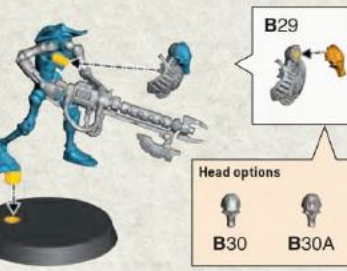
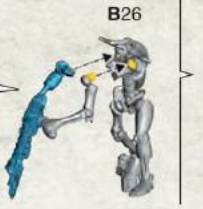
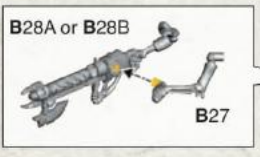

7

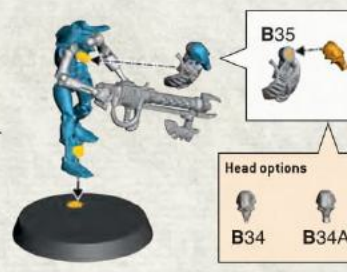

8

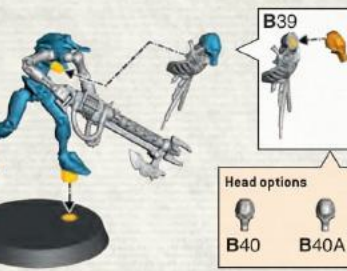
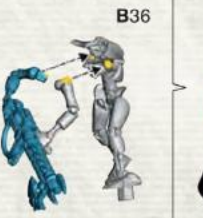

9

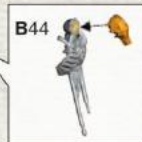

10

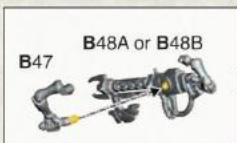

HOW TO BUILD THE CANOPTEK SCARAB SWARMS

Canoptek Scarab Swarm miniatures consist of multiple smaller models attached to a larger, 40 millimetre base, as displayed below. Simply follow the instructions shown here to construct your Canoptek Scarab Swarms.

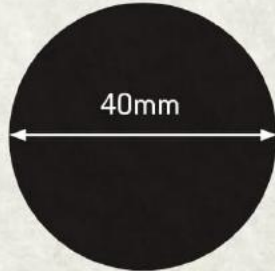
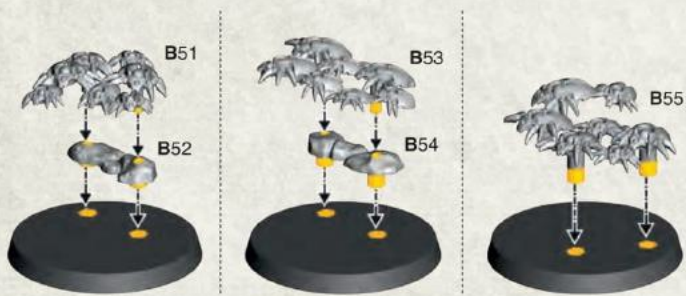

These miniatures should be assembled on a 40mm base.

