



Free Downloads of Build Instructions,
Assembly Booklets & How To Guides

BuildInstructions.com

SISTERS OF SILENCE

KHARON PATTERN ACQUISITOR

Built to approach its targets silently and with utmost stealth, the Kharon pattern Acquisitor is deliberately made to be a thing of mystery and terror when its presence is unveiled.

Used primarily in a paramilitary role by the Sisters of Silence, it can suppress civilian resistance with lethal effect, its heavy stubbers cutting through rampaging mobs and destroying makeshift barricades.

Against greater threats, various payloads of missiles can be deployed, including sophisticated anti-psyker warheads.

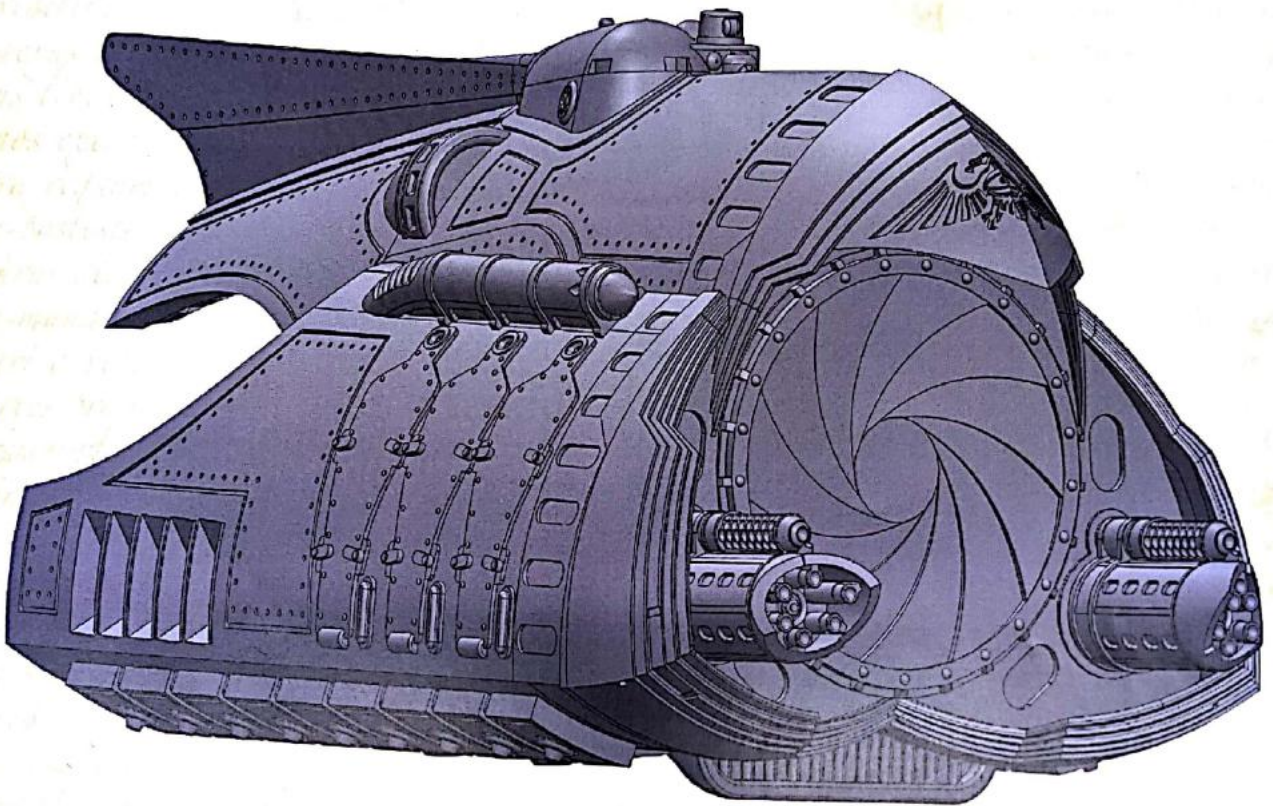

THIS IS NOT A TOY

Not suitable for children under 15 years of age.

WARNING: Resin dust can be harmful if inhaled. Always wear a dust mask or respirator when sanding or sawing resin parts.

www.forgeworld.co.uk



993201080226

Components

Before assembly, check that none of the components are missing.

1. Main Hull
2. Top Hull
3. Rear Hull
4. VTOL Vent
5. Vent Guard
6. Engine x2
7. Right Missile Launcher
8. Left Missile Launcher
9. Engine Intake
10. Open Access Hatch
11. Left Hellion Cannon
12. Right Hellion Cannon
13. Upper Hatch Door
14. Lower Left Hatch Door
15. Lower Right Hatch Door
16. Closed Access Hatch
17. Clear Flying Peg
18. Flying Base

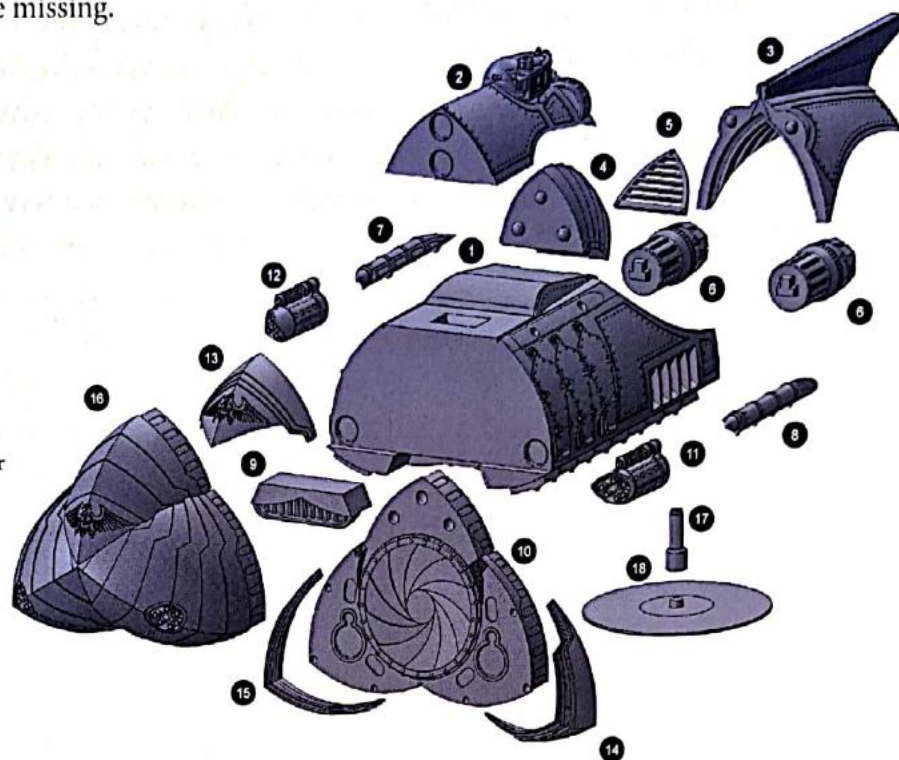

Assembly Legend

Parts for Assembly



Glue Contact Area



Remove Shim



Note



Reverse Angle



Insert



Preparing the Model for Assembly

Before assembling the model, wash each part thoroughly with an abrasive brush, such as a toothbrush, to remove any model release agent that may still be on the surface of the parts. Then, remove any excess resin such as mould lines, casting gates, vents and shims. For a more detailed guide to working with resin models, go to the Downloads section of the Forge World website.

This kit contains all the pieces required to construct a Kharon Pattern Aquisitor. To glue the resin pieces together, use Citadel Super Glue.

NOTE: We have cast this kit using advanced techniques and the best quality resin, but due to the nature of the casting process, your model may contain small air bubbles. These can easily be filled with model filler or super glue. Any slight warpage of thin parts can be corrected by immersing the part in hot tap water for about 1 minute, then carefully bending it back into shape.

If you need to contact the Forge World Customer Service team regarding this model, you can get in touch via email - forgeworld@gwplc.com - or call:

0115 900 4995 within the UK

011 44 115 900 4995 from the USA and Canada

0011 44 115 900 4995 from Australia

00 44 115 900 4995 from Europe and the rest of the world.

I

2. Top Hull

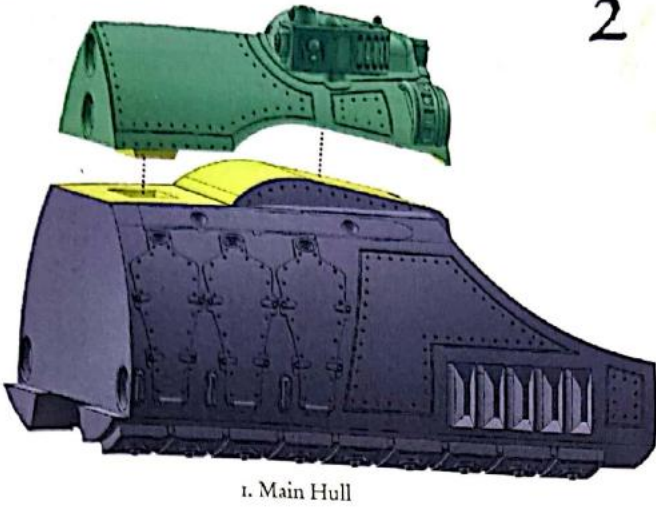

2

7. Right Missile Launcher

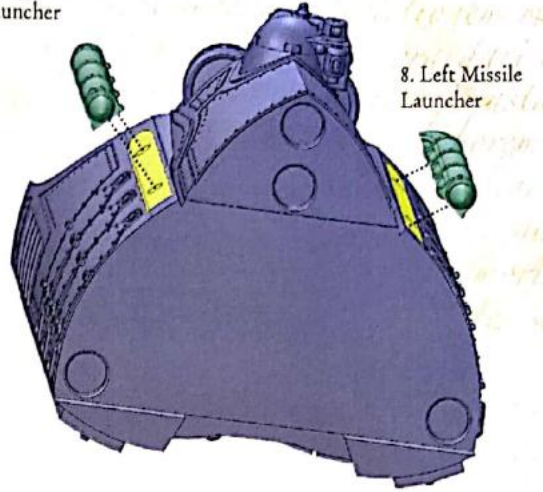

3

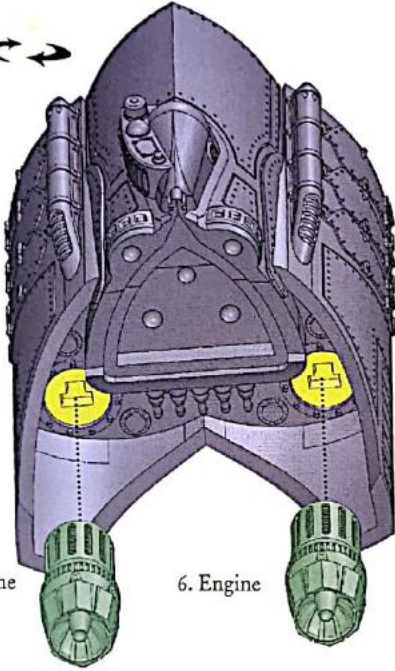

4

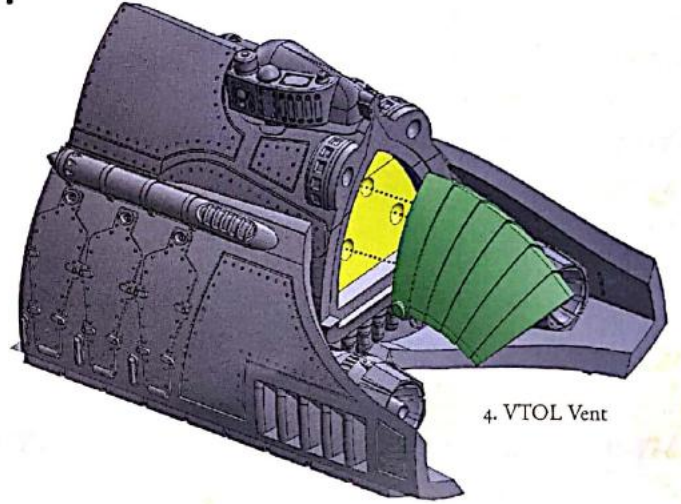

5

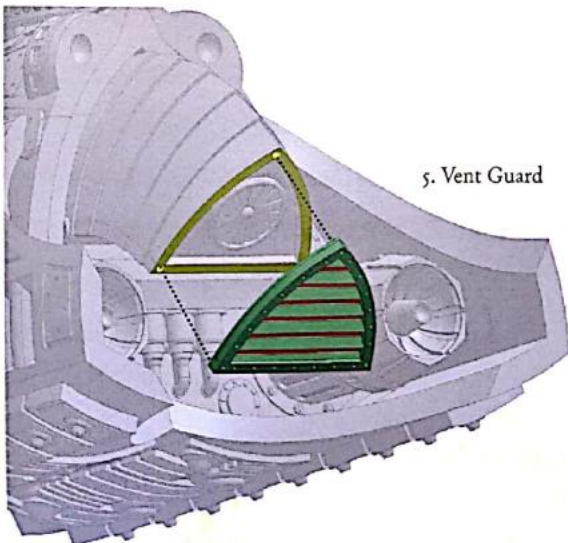

6

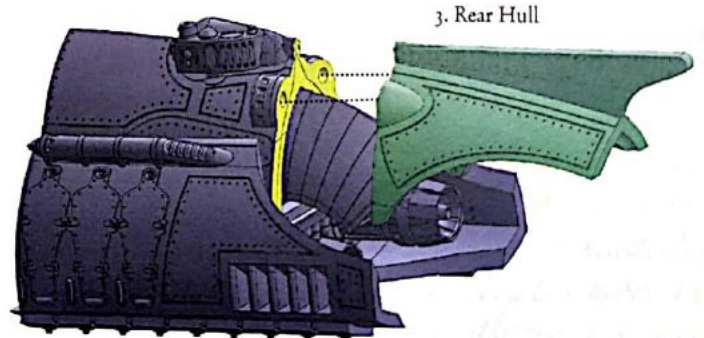

7

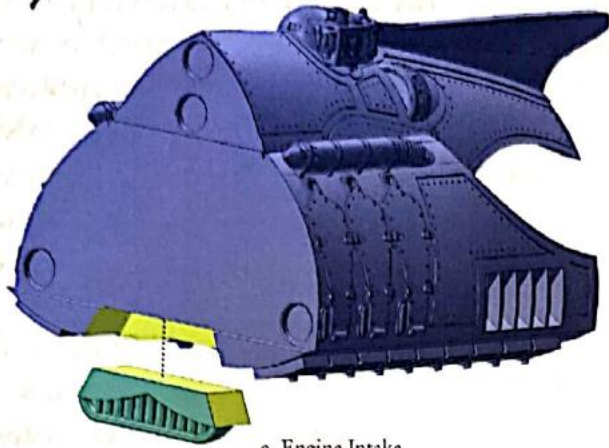

9. Engine Intake

8

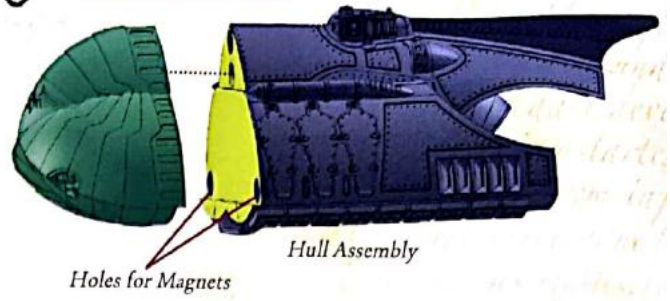

Holes for Magnets

Hull Assembly



As an option, instead of gluing the Access Hatch, the hull contains holes for inserting two 8mm magnets to allow you to switch between the Closed Access Hatch and the Open Access Hatch assembly.

9

10. Open Access Hatch

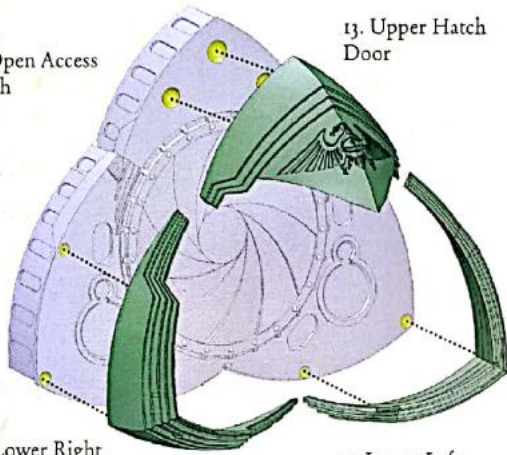

13. Upper Hatch Door

15. Lower Right Hatch Door

14. Lower Left Hatch Door

10

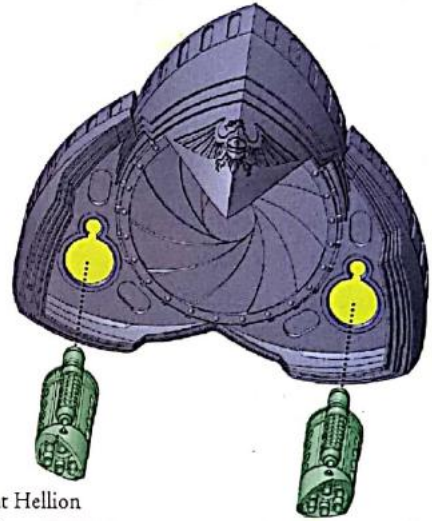

12. Right Hellion Cannon

11. Left Hellion Cannon

11

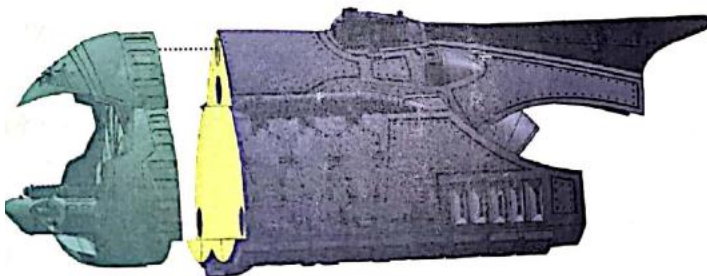

Open Access Hatch Assembly

Hull Assembly

12

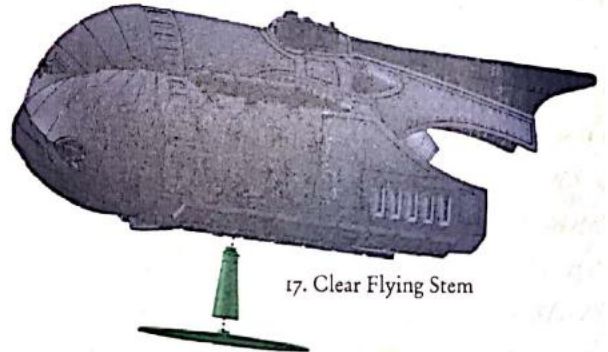

17. Clear Flying Stem

18. Flying Base