



Free Downloads of Build Instructions,
Assembly Booklets & How To Guides

BuildInstructions.com

IMPERIAL™ ARMOUR

ELDAR REVENANT TITAN WITH SONIC LANCES

COMPONENTS LIST

1. Head Crest
2. Head Mask
3. Cockpit
4. Decorations Sprue
5. Decorations Sprue
6. Halo-Fins
7. Primary Exhausts (x4)
8. Right Primary Engine
9. Left Primary Engine
10. Collar
11. Right Shoulder
12. Left Shoulder
13. Torso
14. Upper Arm (x2)
15. Shoulder Rings (x2)
16. Right Sonic Lance
17. Left Sonic Lance
18. Sonic Lance Cables (x2)
19. Abdominal Plate
20. Tertiary Exhausts (x2)
21. Hips
22. Sonic Lance Barrels (x2)
23. Leg Guards (x2)
24. Right Thigh
25. Left Thigh
26. Secondary Engines (x2)
27. Rear Guard
28. Pelvis
29. Front Guard
30. Knee (x2)
31. Leg Engines (x2)
32. Lower Leg (x2)
33. Heel Engine (x2)
34. Heel (x2)
35. Foot Arch (x2)
36. Toe (x2)

NOTE
This Model comes with a choice of 2 different head designs.

This kit contains all the pieces required to build the Eldar Revenant Titan with Sonic Lances
To glue the resin pieces together and to plastic kit parts use Citadel Super Glue.

NOTE: We have cast this kit using the most advanced techniques and the best quality resin, but due to the nature of the casting process your model may contain very slight air bubbles. These can easily be filled with model filler or super glue. Any slight warpage of thin parts can easily be corrected by immersing the part in hot tap water for about 1 minute then carefully bending it back into shape.

THIS IS NOT A TOY

Not suitable for children under 15 years of age.
WARNING: Resin dust can be harmful if inhaled. Always wear a dust mask or respirator when sanding or sawing resin parts.

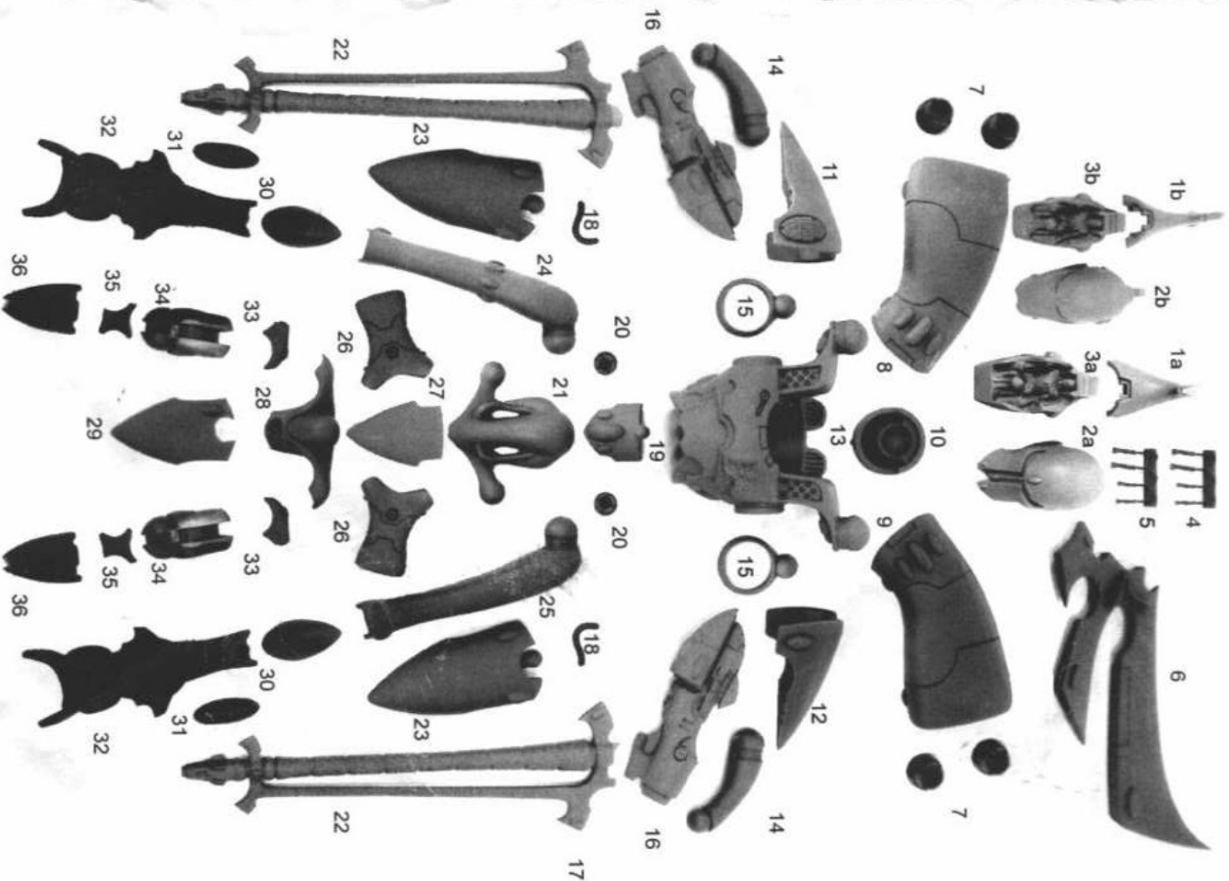

The copyright on the model designs and components within this box is the exclusive property of Games Workshop Ltd. Copyright Games Workshop Ltd., 2004. All rights reserved.

Product code : IA-TTN-E-006

NOTE
When constructing your Revenant Titan it is worthwhile to have the pose you want the Titan to be in decided before you begin. We recommend starting construction with the legs and working up.

HEEL ENGINE



HEEL

TOE

FOOT ARCH
NOTE: The gem stone faces the top



NOTE
When the foot is set to a flight position the Heel engine can slide down below the level of the heel as shown above.

RIGHT THIGH

LEG ENGINE

LOWER LEG

KNEE

TORSO

ABDOMINAL PLATE

RIGHT THIGH

LEFT THIGH

HIPS

PELVIS

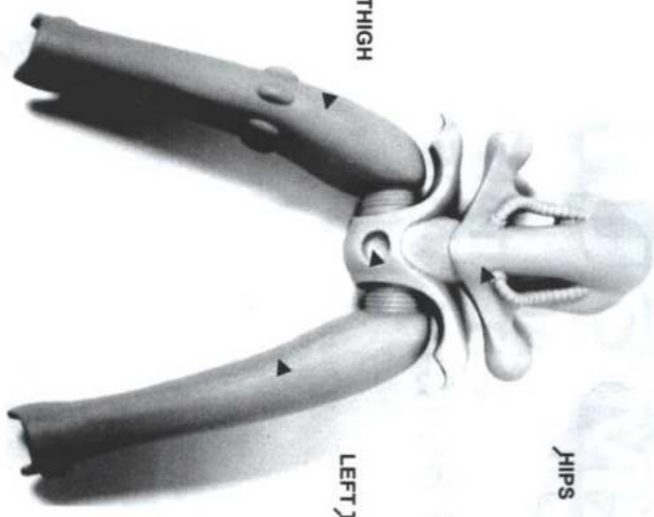



TORSO ASSEMBLY



HIPS ASSEMBLY



TORSO ASSEMBLY

UPPER ARM

SONIC LANCE CABLE

RIGHT SONIC LANCE

SECONDARY ENGINES

SHOULDER RING

NOTE: The Shoulder Ring is used to mount the Titan's Shoulder. It is worthwhile putting it in place before fixing on the arms, don't glue it however until the guns have been fitted. This is to allow the shoulder to be positioned correctly in relation to the gun.

HOLO FINS

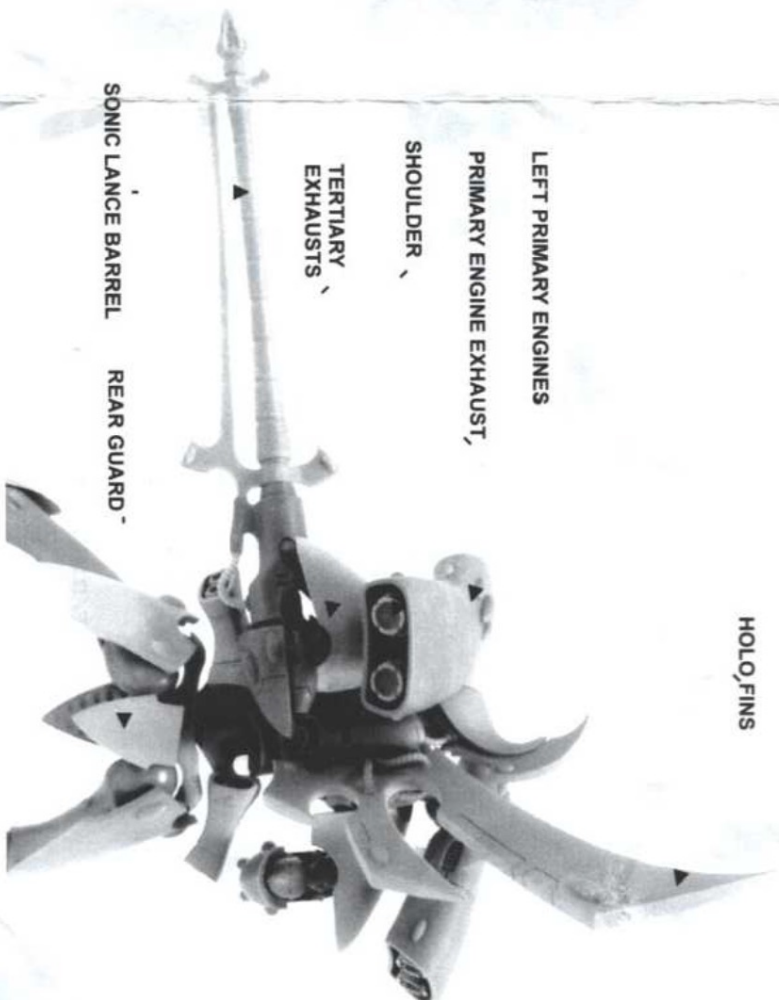

LEFT PRIMARY ENGINES

PRIMARY ENGINE EXHAUST,

SHOULDER,

TERTIARY EXHAUSTS

SONIC LANCE BARREL

REAR GUARD



COCKPIT

COLLAR

NOTE: Do not glue the Collar to the Torso until after the model is completed and painted. This will aid the head construction and painting as the head can easily be removed.

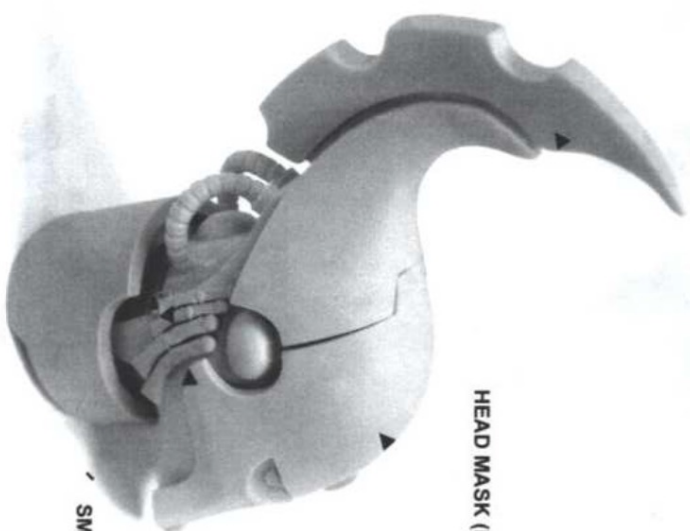

HEAD CREST

HEAD MASK (DO NOT GLUE)

LARGE DECORATION

SMALL DECORATION

DECORATIONS

These are a great way to represent movement on the head. They can be bent in to shape by holding with tweezers and gently heating with a hairdryer. Once heated bend to the desired shape that matches the direction of motion that the model has been posed in. The head shown above demonstrates backwards movement.

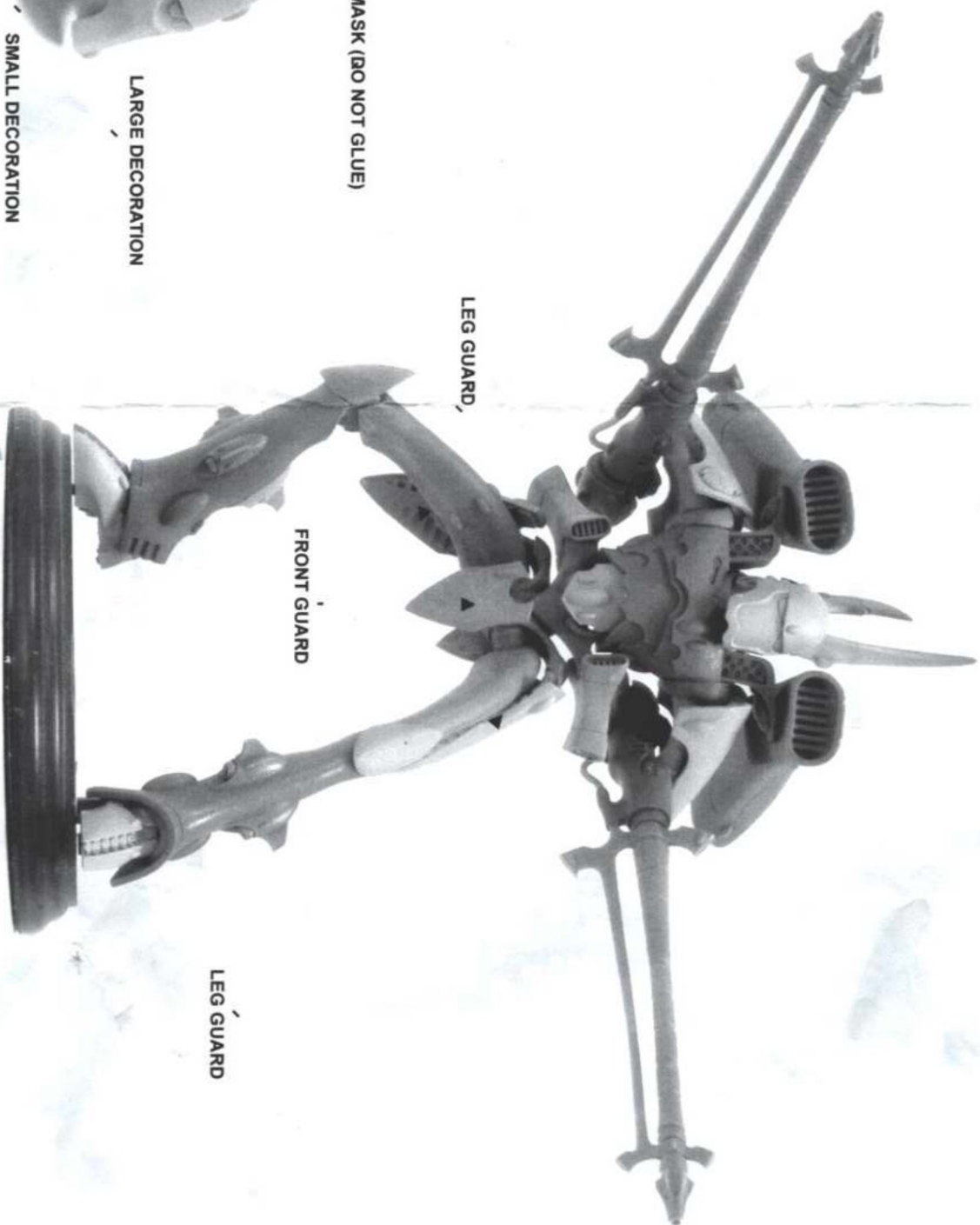

LEG GUARD,

FRONT GUARD

LEG GUARD

BASE NOT INCLUDED