



Free Downloads of Build Instructions,
Assembly Booklets & How To Guides

BuildInstructions.com

HOW TO BUILD REIKENOR THE GRIMHAILER

Although Reikenor the Grimhailer is an easy-to-build model and doesn't require glue, the kit does contain fragile components. Apply gentle but firm pressure when pushing them together.

⚠️ CLIPPER SAFETY

To remove your model from the sprue, you will need a set of modelling clippers. Games Workshop sells a set of clippers specially designed for this job, with flat-edged blades. You must follow all the instructions and guidance provided with the clippers.



Hold your clippers like so, with your fingers cushioning one arm and your thumb to apply pressure on the other. To cut a component from the sprue, gently squeeze until the blades meet.



1 Line the components up first and then gently but firmly push them together until there is no longer a gap between them.

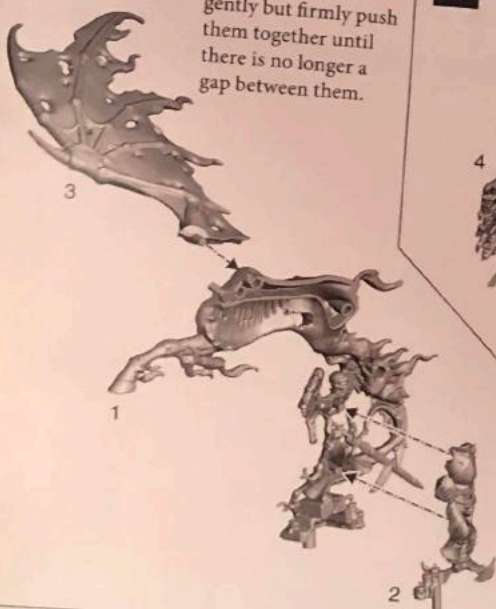

4 Make sure you position the head before pushing the body together. These components will be difficult to pry apart if you make an error.

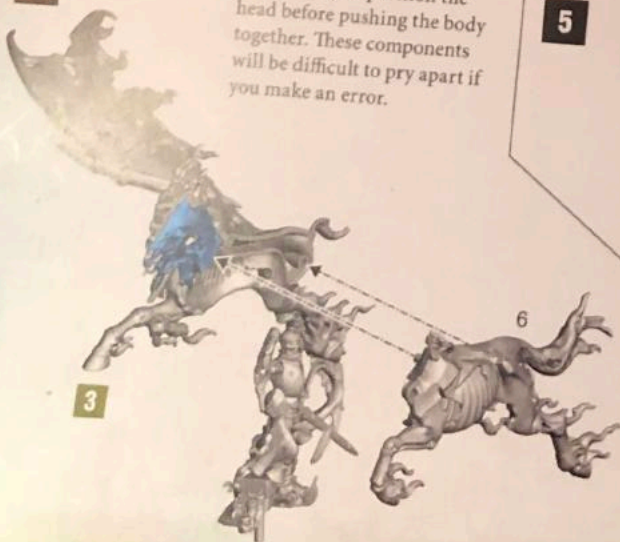

5 Push component 7 into position and then carefully slot the model into place on the base using the pegs at the base of the statue.

