



Free Downloads of Build Instructions,
Assembly Booklets & How To Guides

BuildInstructions.com

MASTODON

The Mastodon is one of the heaviest assault transports in the arsenal of the Legiones Astartes and one reserved for use against the most heavily fortified positions. Several times the size of a Land Raider, its transport bay can convey up to forty Space Marines through the most perilous of battlefields and protect them even from enemy Titans.

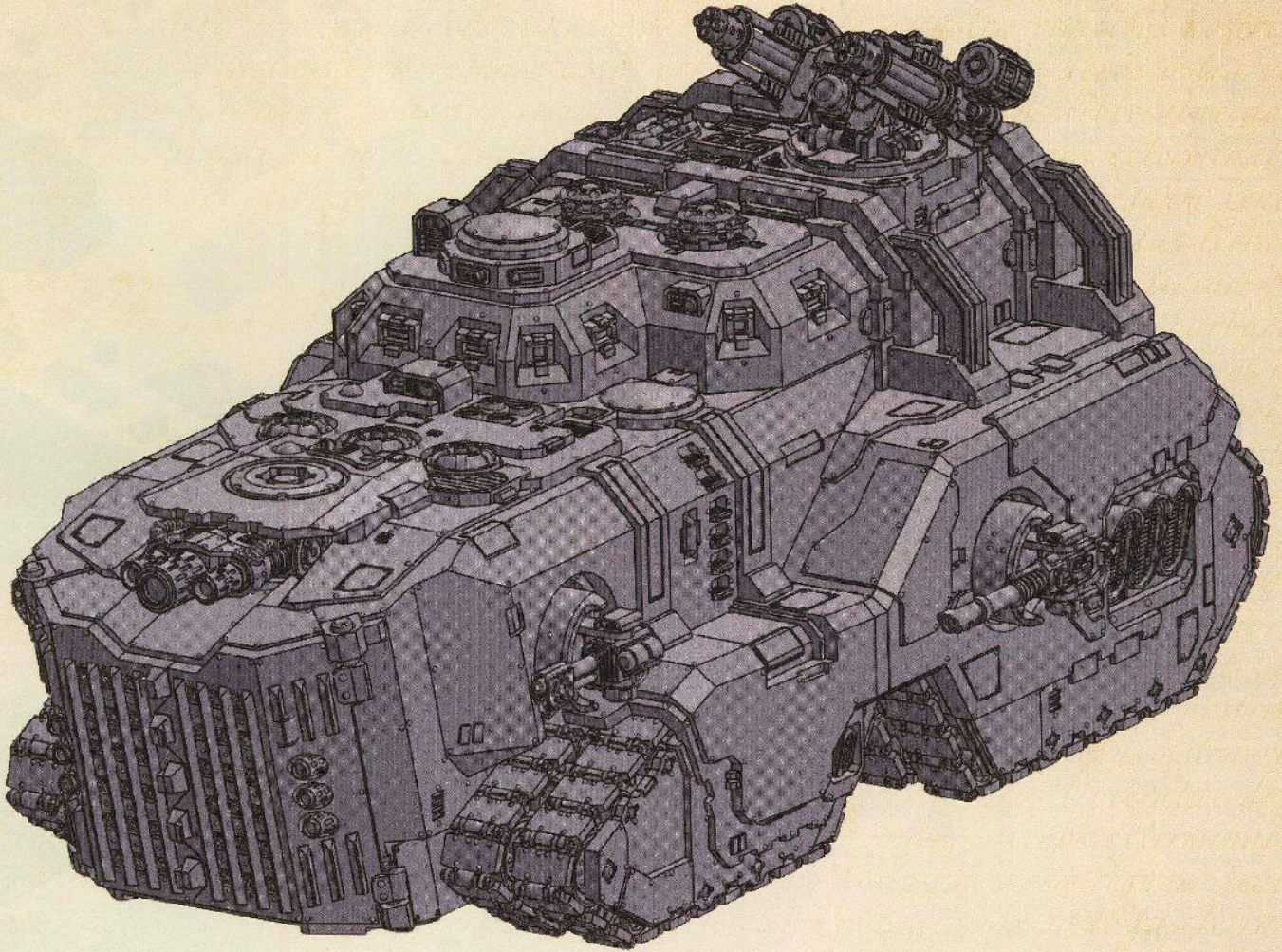

THIS IS NOT A TOY

Not suitable for children under 15 years of age.

WARNING: Resin dust can be harmful if inhaled. Always wear a dust mask or respirator when sanding or sawing resin parts.

www.forgeworld.co.uk



993201010025

Before assembly, check that none of the components are missing.

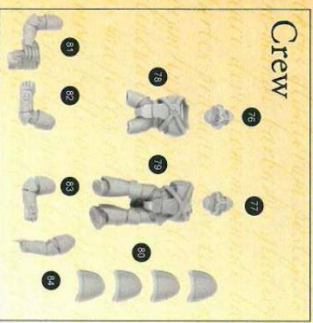

Crew

- | | |
|-------------------------------------|-------------------------------------|
| 1. Front Command Section | 27. Siege Mecha Array Turret |
| 2. Rear Command Section | 28. Siege Mecha Array Barris |
| 3. Inner Hull Left | 29. Hatch x2 |
| 4. Inner Hull Right | 30. Command Deck Hying buttress x4 |
| 5. Front Floor | 31. Void Shield Projector x2 |
| 6. Central Floor | 32. Command Door |
| 7. Rear Floor | 33. Platform |
| 8. Rear Door | 34. Secondary Mecha Barrel x6 |
| 9. Small bulkhead | 35. Left Lascannon |
| 10. Large bulkhead | 36. Right Lascannon |
| 11. Right Door | 37. Sponson |
| 12. Left Door | 38. Sponson Ring x4 |
| 13. Top Hull | 39. Sponson Mount for Lascannon x2 |
| 14. Upper Right Hinge | 40. Left Lascannon Targeter |
| 15. Upper Left Hinge | 41. Right Lascannon Targeter |
| 16. Siege Mecha Array Upper Plate | 42. Left Heavy Flamer Targeter |
| 17. Upper Hull Plate | 43. Right Heavy Flamer Targeter |
| 18. Left Track Unit | 44. Left Lascannon Cable Bracket x2 |
| 19. Right Track Unit | |
| 20. Lower Left Hinge | |
| 21. Lower Right Hinge | |
| 22. Front Track Links x4 | |
| 23. Rear Track Links x4 | |
| 24. Left Lower Piston Door Bracket | |
| 25. Right Lower Piston Door Bracket | |
| 26. Upper Piston Door Bracket x2 | |

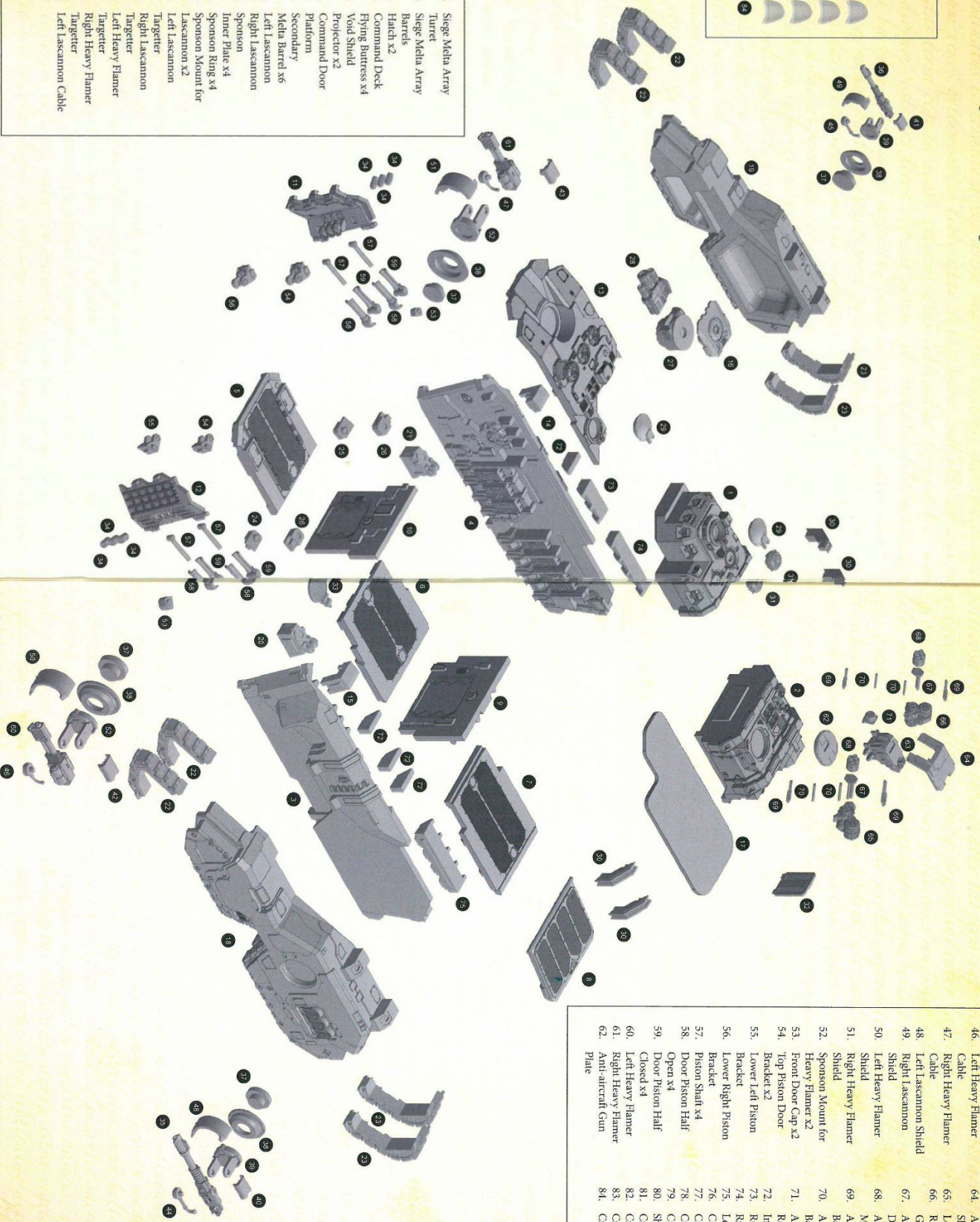

- | | |
|--|---|
| 45. Right Lascannon Cable | 63. Anti-aircraft Gun Turret |
| 46. Left Heavy Flamer Cable | 64. Anti-aircraft Gun Shield |
| 47. Right Heavy Flamer Cable | 65. Left Anti-aircraft Gun |
| 48. Left Lascannon Shield | 66. Right Anti-aircraft Gun |
| 49. Right Lascannon Shield | 67. Anti-aircraft Gun Double Barris x2 |
| 50. Left Heavy Flamer Shield | 68. Anti-aircraft Gun Muzzles x2 |
| 51. Right Heavy Flamer Shield | 69. Anti-aircraft Gun Barrel Support x4 |
| 52. Sponson Mount for Heavy Flamer x2 | 70. Anti-aircraft Gun Barrel x4 |
| 53. Front Door Cap x2 | 71. Anti-aircraft Gun Radar |
| 54. Top Piston Door Bracket x2 | 72. Internal Support x4 |
| 55. Lower Left Piston Bracket | 73. Right Internal Lights 1 |
| 56. Lower Right Piston Bracket | 74. Left Internal Lights 2 |
| 57. Piston Shaft x4 | 75. Left Internal Lights 2 |
| 58. Door Piston Half Open x4 | 76. Crew Head 1 |
| 59. Door Piston Half Closed x4 | 77. Crew Head 2 |
| 60. Left Heavy Flamer Anti-aircraft Gun Plate | 78. Crew Torso |
| 61. Right Heavy Flamer Anti-aircraft Gun Plate | 79. Crew Body |
| | 80. Shoulder Pads x4 |
| | 81. Crew Right Arm 1 |
| | 82. Crew Left Arm 1 |
| | 83. Crew Right Arm 2 |
| | 84. Crew Left Arm 2 |

Components

Before assembly, check that none of the components are missing.

Crew

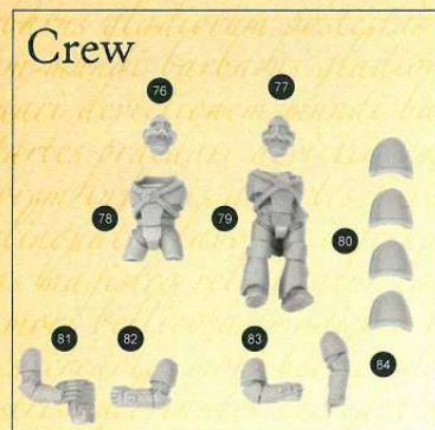



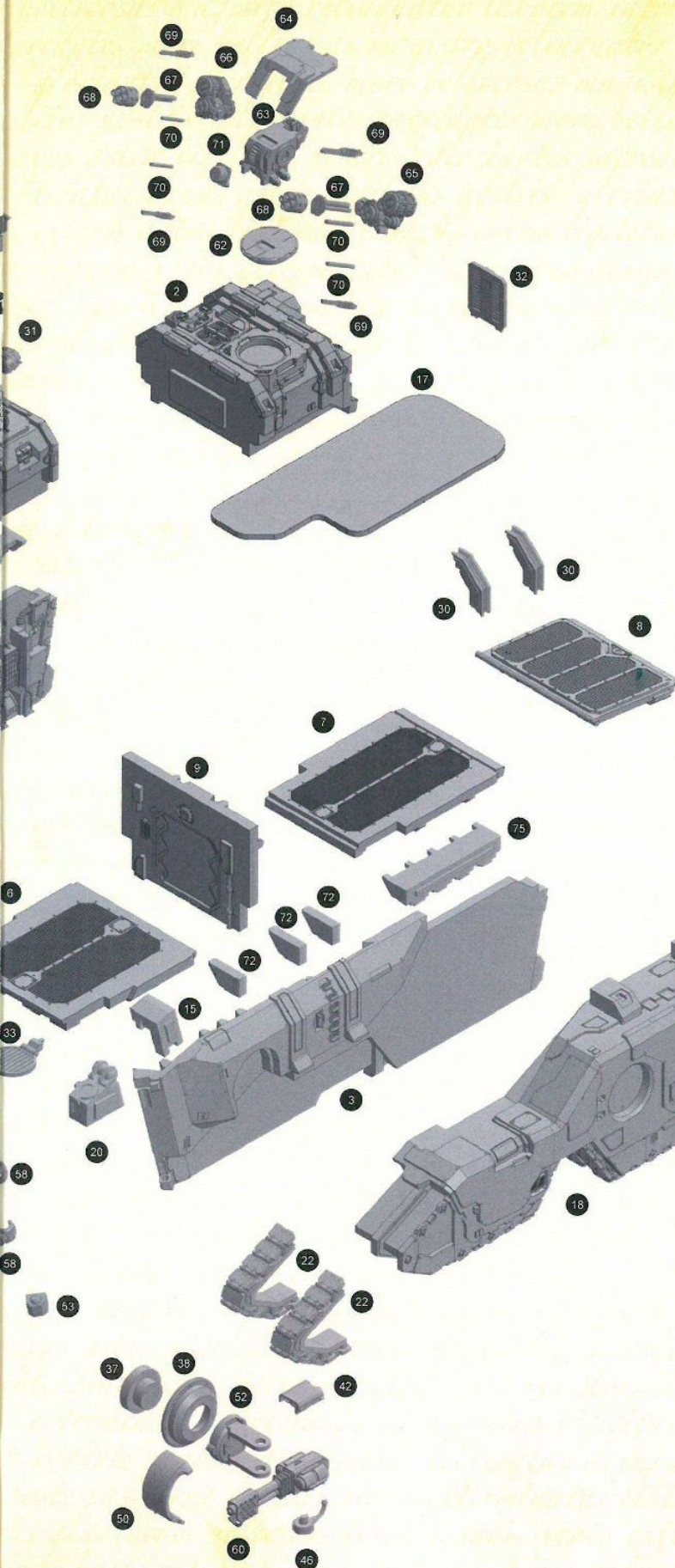





- | | |
|-------------------------------------|------------------------------------|
| 1. Front Command Section | 27. Siege Melta Array Turret |
| 2. Rear Command Section | 28. Siege Melta Array Barrels |
| 3. Inner Hull Left | 29. Hatch x2 |
| 4. Inner Hull Right | 30. Command Deck |
| 5. Front Floor | 31. Flying Buttress x4 |
| 6. Central Floor | 32. Void Shield |
| 7. Rear Floor | 33. Projector x2 |
| 8. Rear Door | 34. Command Door |
| 9. Small Bulkhead | 35. Platform |
| 10. Large Bulkhead | 36. Secondary Melta Barrel x6 |
| 11. Right Door | 37. Left Lascannon |
| 12. Left Door | 38. Right Lascannon |
| 13. Top Hull | 39. Sponson |
| 14. Upper Right Hinge | 40. Inner Plate x4 |
| 15. Upper Left Hinge | 41. Sponson Ring x4 |
| 16. Siege Melta Array Upper Plate | 42. Sponson Mount for Lascannon x2 |
| 17. Upper Hull Plate | 43. Left Lascannon Targetter |
| 18. Left Track Unit | 44. Right Lascannon Targetter |
| 19. Right Track Unit | 45. Left Heavy Flamer Targetter |
| 20. Lower Left Hinge | 46. Right Heavy Flamer Targetter |
| 21. Lower Right Hinge | 47. Left Lascannon Cable |
| 22. Front Track Links x4 | |
| 23. Rear Track Links x4 | |
| 24. Left Lower Piston Door Bracket | |
| 25. Right Lower Piston Door Bracket | |
| 26. Upper Piston Door Bracket x2 | |



- | | |
|---------------------------------------|---|
| 45. Right Lascannon Cable | 63. Anti-aircraft Gun Turret |
| 46. Left Heavy Flamer Cable | 64. Anti-aircraft Gun Shield |
| 47. Right Heavy Flamer Cable | 65. Left Anti-aircraft Gun |
| 48. Left Lascannon Shield | 66. Right Anti-aircraft Gun |
| 49. Right Lascannon Shield | 67. Anti-aircraft Gun Double Barrels x2 |
| 50. Left Heavy Flamer Shield | 68. Anti-aircraft Gun Muzzles x2 |
| 51. Right Heavy Flamer Shield | 69. Anti-aircraft Gun Barrel Support x4 |
| 52. Sponson Mount for Heavy Flamer x2 | 70. Anti-aircraft Gun Barrel x4 |
| 53. Front Door Cap x2 | 71. Anti-aircraft Gun Radar |
| 54. Top Piston Door Bracket x2 | 72. Internal Support x4 |
| 55. Lower Left Piston Bracket | 73. Right Internal Lights 1 |
| 56. Lower Right Piston Bracket | 74. Right Internal Lights 2 |
| 57. Piston Shaft x4 | 75. Left Internal Lights |
| 58. Door Piston Half Open x4 | 76. Crew Head 1 |
| 59. Door Piston Half Closed x4 | 77. Crew Head 2 |
| 60. Left Heavy Flamer | 78. Crew Torso |
| 61. Right Heavy Flamer | 79. Crew Body |
| 62. Anti-aircraft Gun Plate | 80. Shoulder Pads x4 |
| | 81. Crew Right Arm 1 |
| | 82. Crew Left Arm 1 |
| | 83. Crew Right Arm 2 |
| | 84. Crew Left Arm 2 |

Assembly Legend

Parts for Assembly	
Shim for Removal	
Note	
Glue Contact Area	
Reverse Angle	
Do Not Glue	
Insert	
Hidden Component	
Component Highlight	

Preparing the Model for Assembly

Before assembling the model, wash each part thoroughly with an abrasive brush, such as a toothbrush, to remove any model release agent that may still be on the surface of the parts. Then, remove any excess resin such as mould lines, casting gates, vents and shims. For a more detailed guide to working with resin models, go to the Downloads section of the Forge World website.

This kit contains all the pieces required to construct the Mastodon. To glue the resin pieces together, use Citadel Super Glue.

NOTE: We have cast this kit using advanced techniques and the best quality resin, but due to the nature of the casting process, your model may contain small air bubbles. These can easily be filled with model filler or super glue. Any slight warpage of thin parts can easily be corrected by immersing the part in hot water for about 1 minute, then bending it back into shape.

Building the Mastodon

Parts of the Mastodon kit have been designed to be movable, such as the front and rear doors and the weapons sponsons. If you want the vehicle to have some posability, care must be taken when gluing the pistons, door brackets and turret parts to the kit, and also when connecting the left and right halves of the kit around the Rear Door.

When it comes to building the Mastodon, it is a good idea to test fit the parts together to see how they go together once assembled. An adhesive putty may be helpful when it comes to testing the fit of certain components.

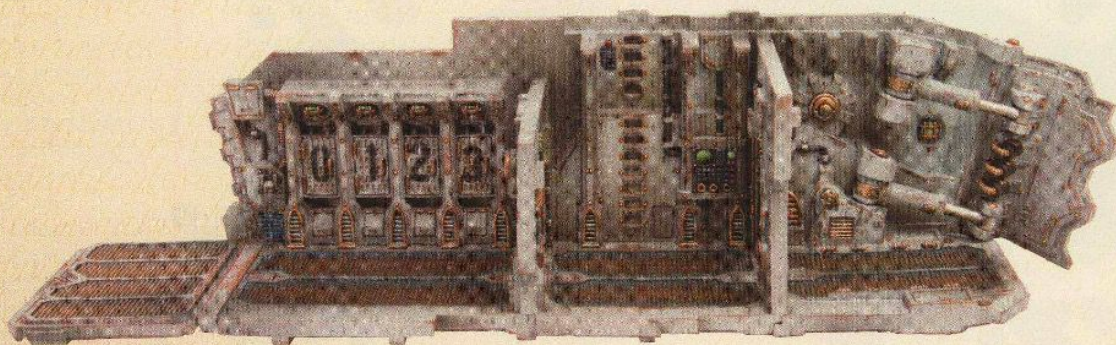

The cross-section image above demonstrates both the rear and front doors in an open position.

If you need to contact the Forge World Customer Service team regarding this model, you can get in touch via email - forgeworld@gwplc.com - or call:

0115 900 4995 within the UK

011 44 115 900 4995 from the USA and Canada

0011 44 115 900 4995 from Australia

011 44 115 900 4995 from Europe and the rest of the world.

I



12. Left Door

34. Secondary Melta Barrels

! Repeat this with part 11. Right Door and part 34. Secondary Melta Barrels.

2

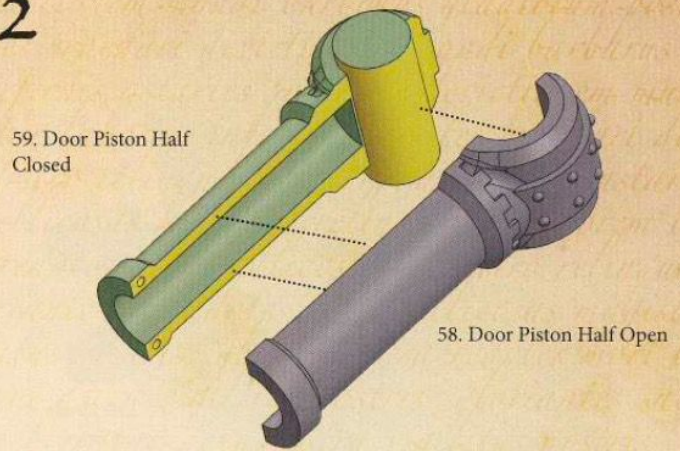

59. Door Piston Half Closed

58. Door Piston Half Open

! Repeat step 2 for the other three Piston Cylinders.

3

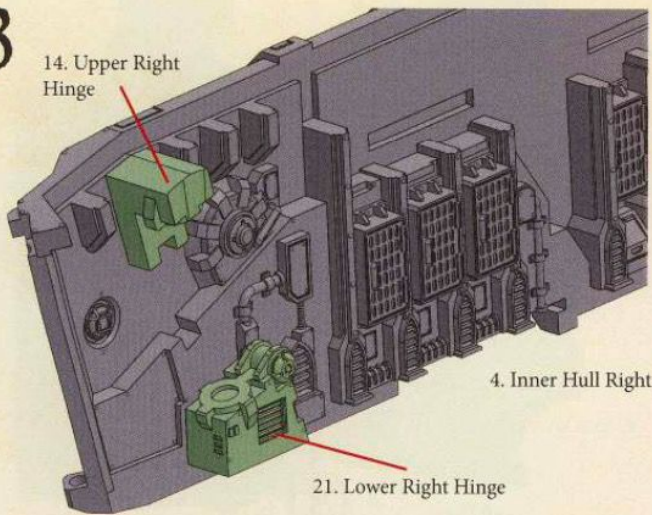

14. Upper Right Hinge

4. Inner Hull Right

21. Lower Right Hinge

! Repeat step 3 for part 3. Inner Hull Left using part 15. Upper Left Hinge and part 20. Lower Left Hinge.

4

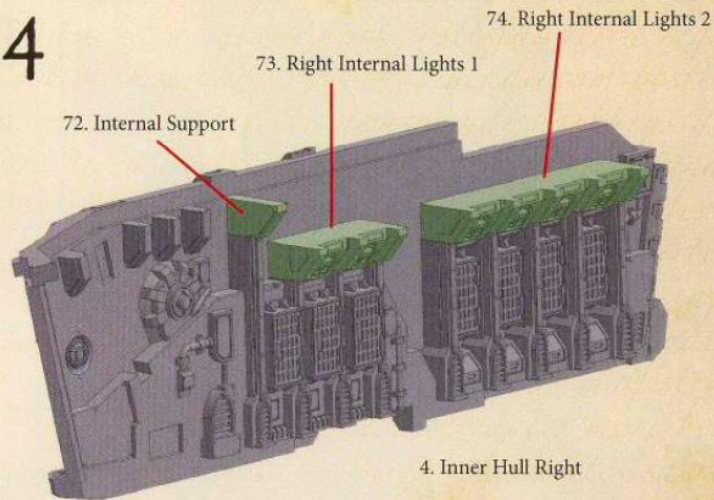

73. Right Internal Lights 1

74. Right Internal Lights 2

72. Internal Support

4. Inner Hull Right

5

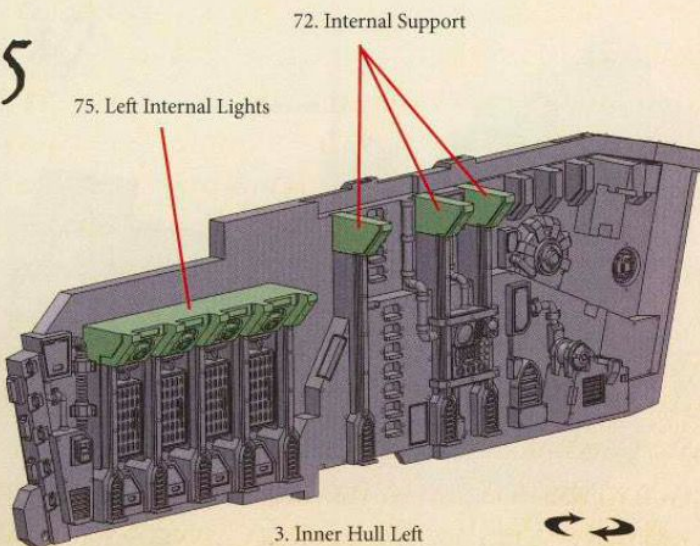

72. Internal Support

75. Left Internal Lights

3. Inner Hull Left



6

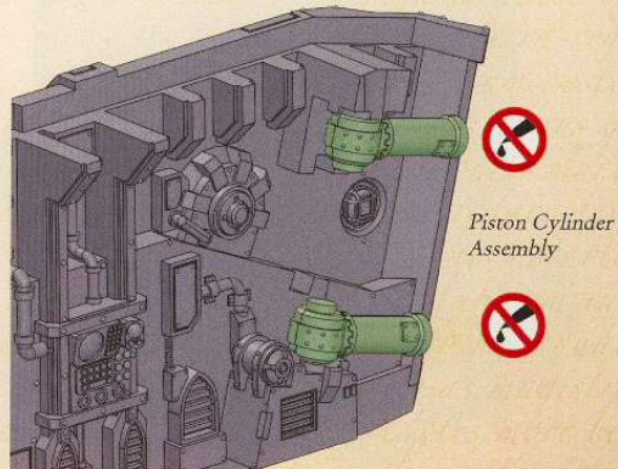

! Piston Cylinder Assembly

! Slot the assembled Piston Cylinders in - do not glue them.

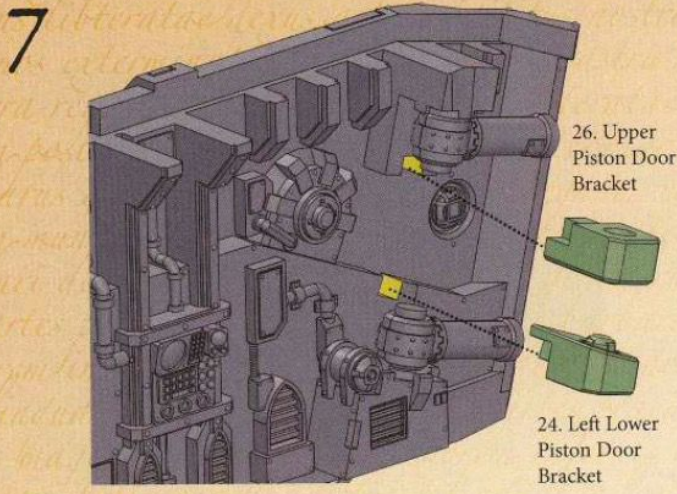

! Take care when gluing the upper and lower piston brackets to not get glue on the Piston Cylinder Assemblies. Repeat stages 6 and 7 for the right-hand side.

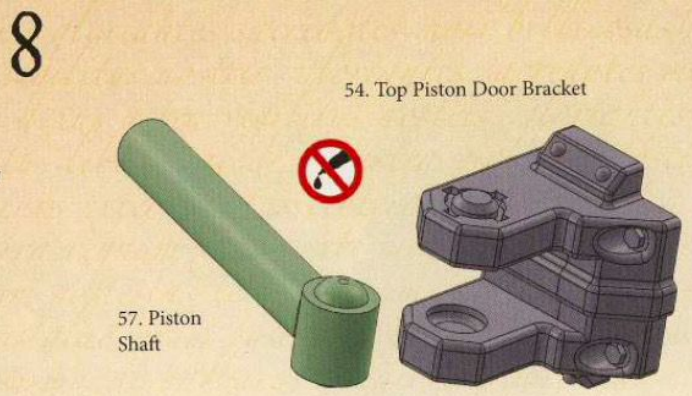

! The Piston Shaft should slot into each Piston Door Bracket without the need for glue.

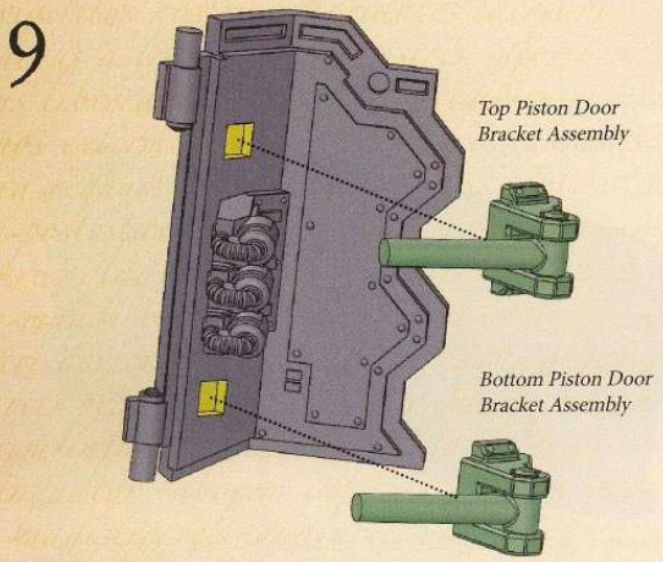

! Repeat stages 9 - 11 for the right-hand side. Make sure the Top Piston Door bracket is facing forward.

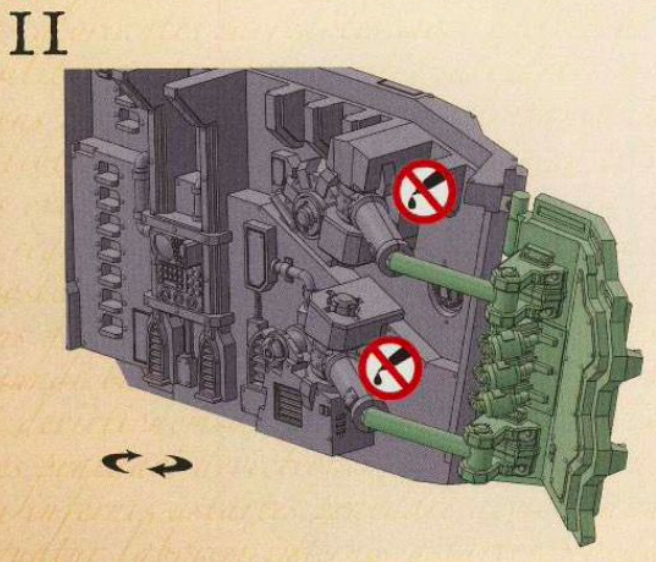
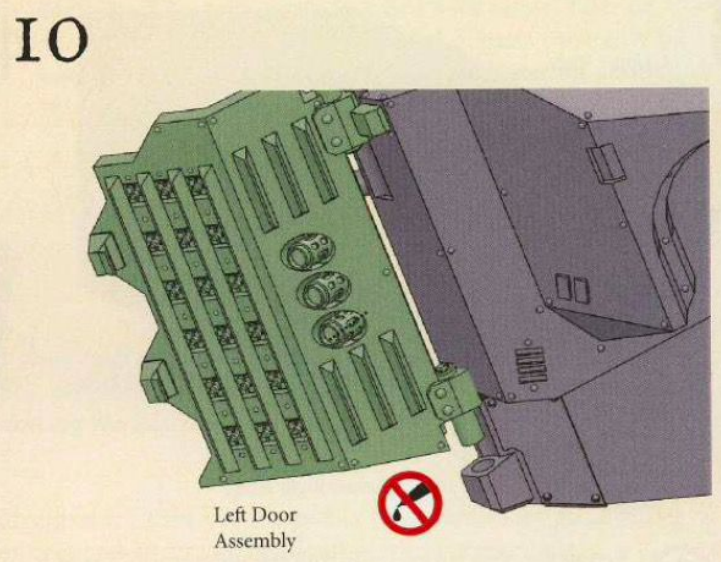

! Drop the door into the lower hinge and then arrange the pistons as shown in 11a. Apply some gentle pressure to where the Pistons and Piston Cylinder Assemblies meet to pop the piston into place.

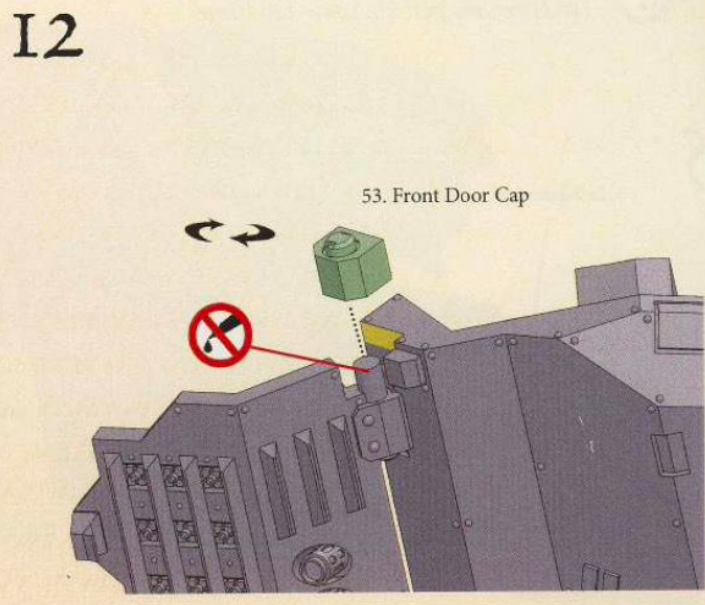

I3

Left Hull Assembly

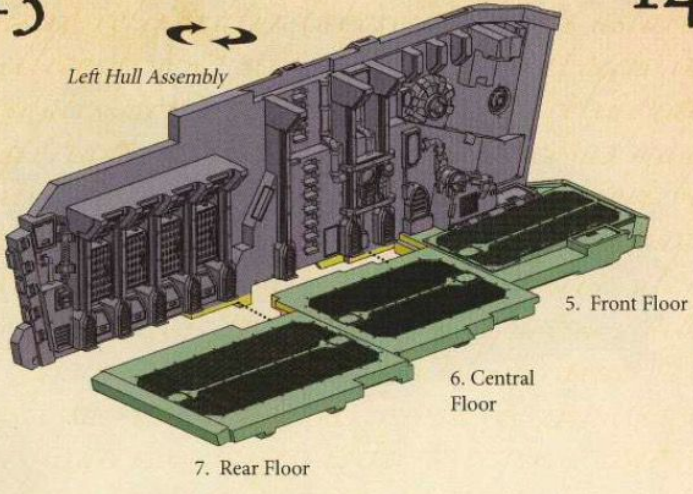

I4

8. Rear Door

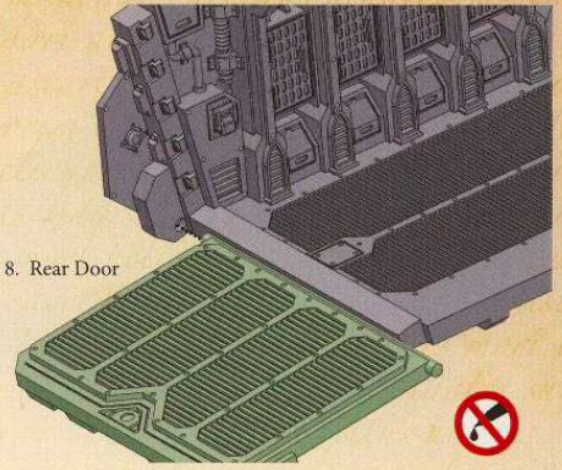

I5

Right Hull Assembly

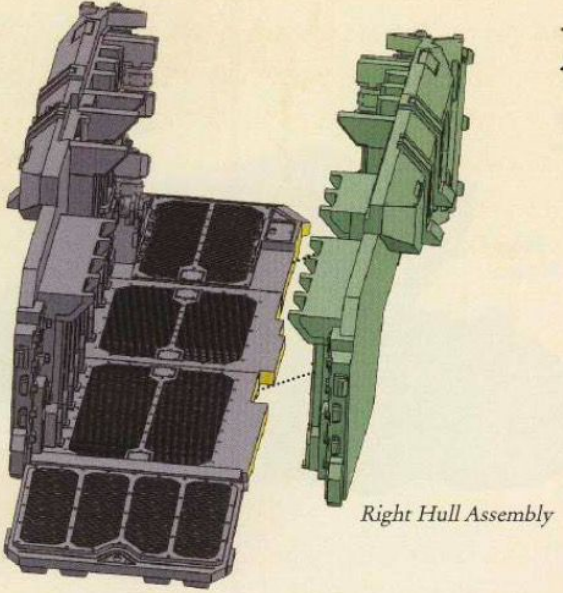

I6

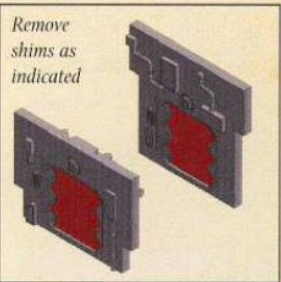

9. Small Bulkhead

10. Large Bulkhead

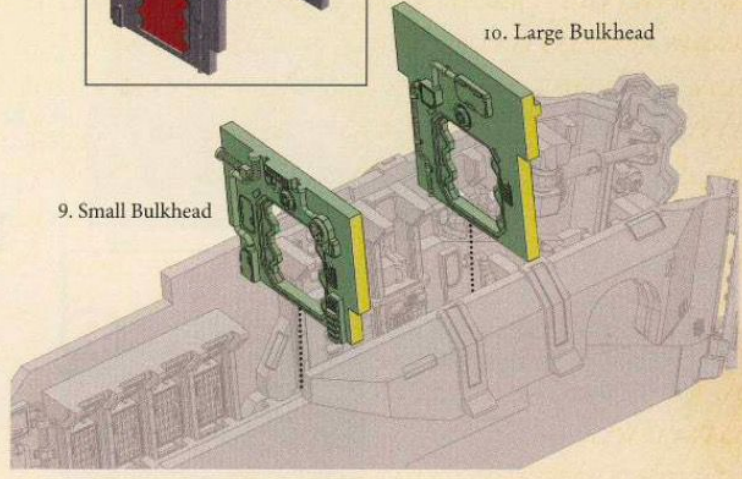

Attach the Right Hull Assembly to the floor panels as shown. The pin from the Rear Door should insert into the hole at the rear of the assembly (as shown in step I4) to hold the Rear Door in position.

I7

22. Front Track Links

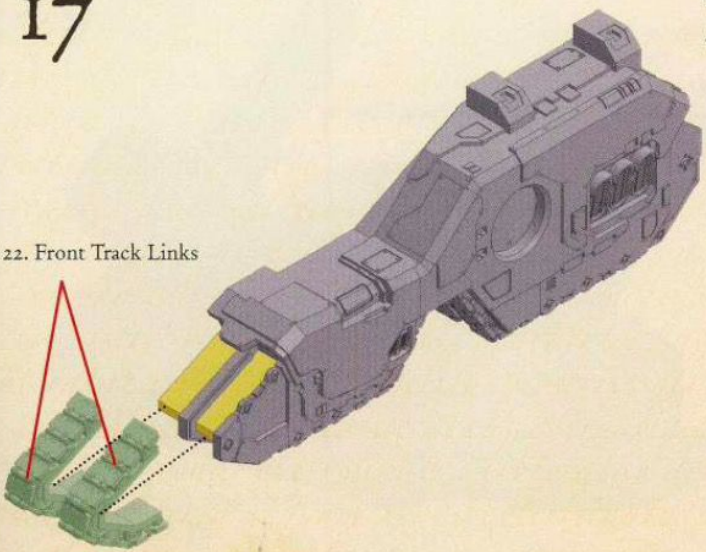

I8

23. Rear Track Links

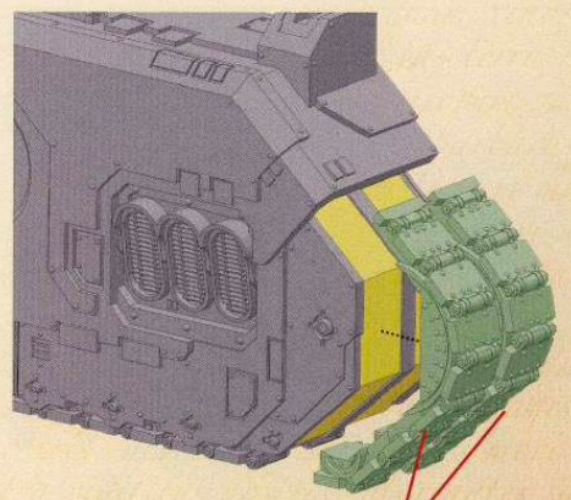

Repeat stages I7 and I8 for the right-hand side.

19

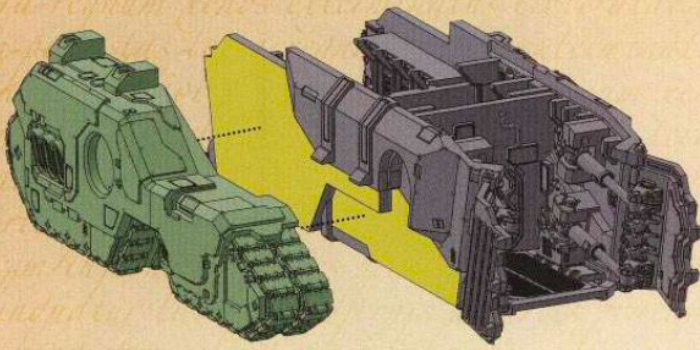

Right Track Assembly

20

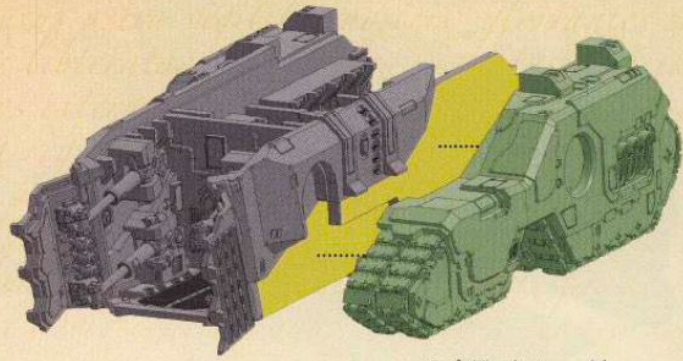

Left Track Assembly

21

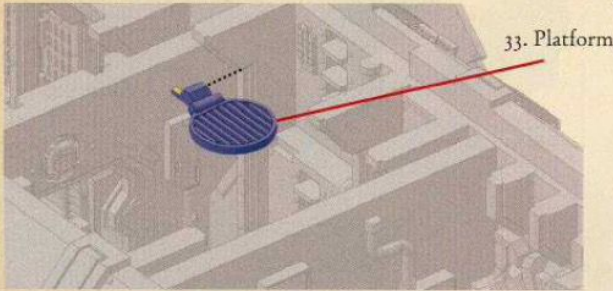

33. Platform



The optional Platform can be used if you want to have the hatch above it open and the complete crew figure standing on it.

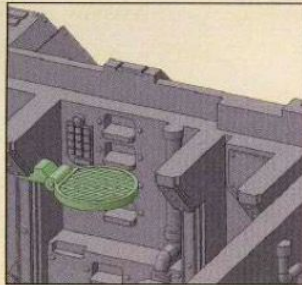

22

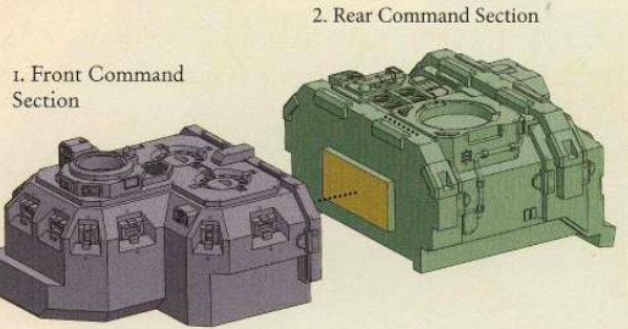

1. Front Command Section

2. Rear Command Section

23

30. Command Deck Flying Buttress

30. Command Deck Flying Buttress

30. Command Deck Flying Buttress

30. Command Deck Flying Buttress

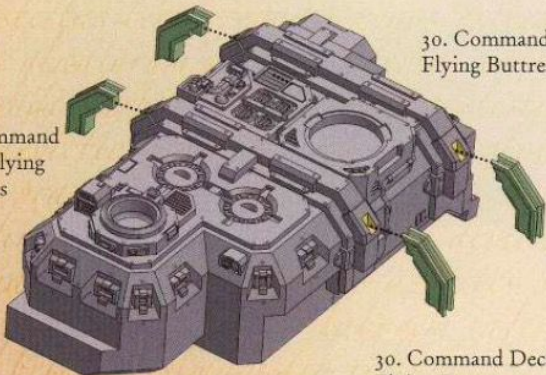

24

31. Void Shield Projector

31. Void Shield Projector

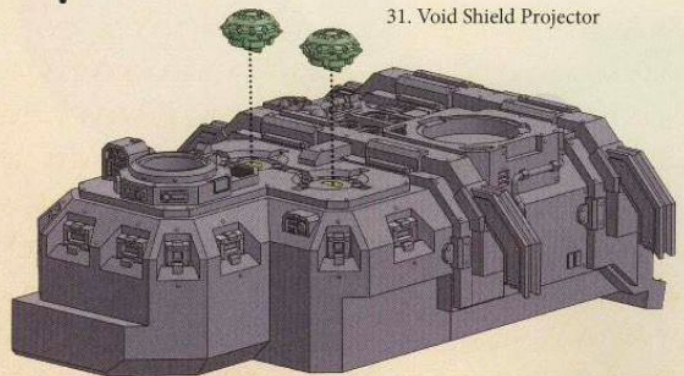

25

63. Anti-aircraft Gun Turret

62. Anti-aircraft Gun Plate

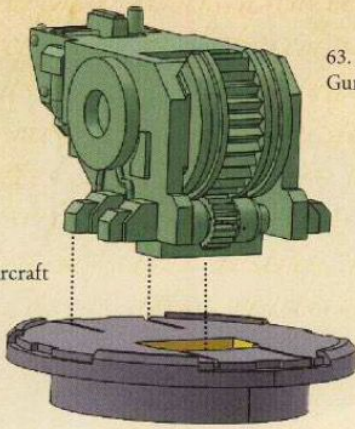

26

64. Anti-aircraft Gun Shield

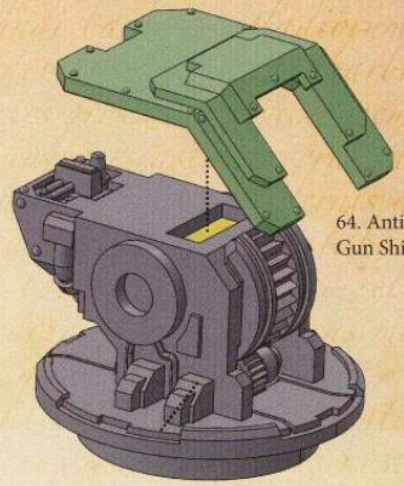

27

71. Anti-aircraft Gun Radar

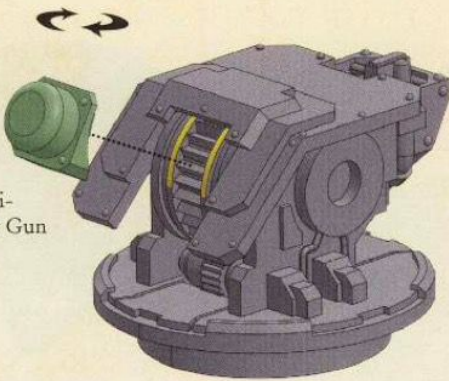

28

65. Left Anti-aircraft Gun

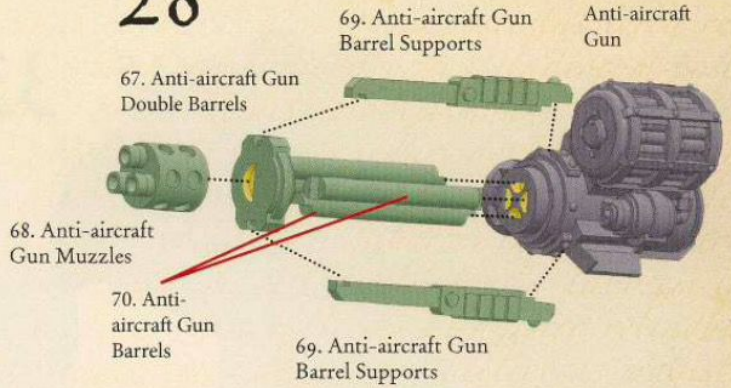

Repeat this assembly using part 66. Right Anti-aircraft Gun which makes use of exactly the same parts as shown above.

Left Anti-aircraft Gun Assembly

29

Right Anti-aircraft Gun Assembly

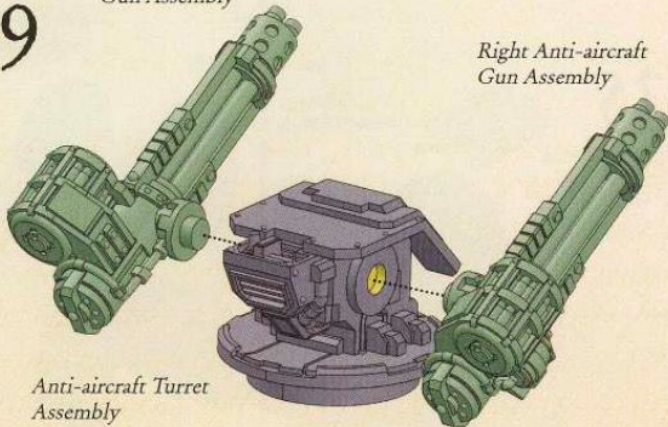

Anti-aircraft Turret Assembly

29a

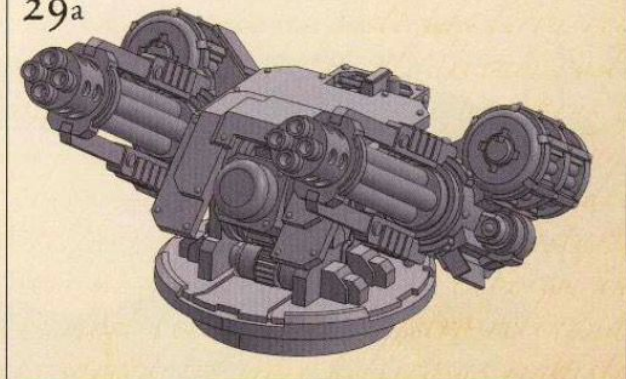

Glue each Anti-aircraft Gun Assembly to the turret at an angle that matches that of part 71. Anti-aircraft Gun Radar, as shown in 29a.

30

Anti-aircraft Gun Assembly



31

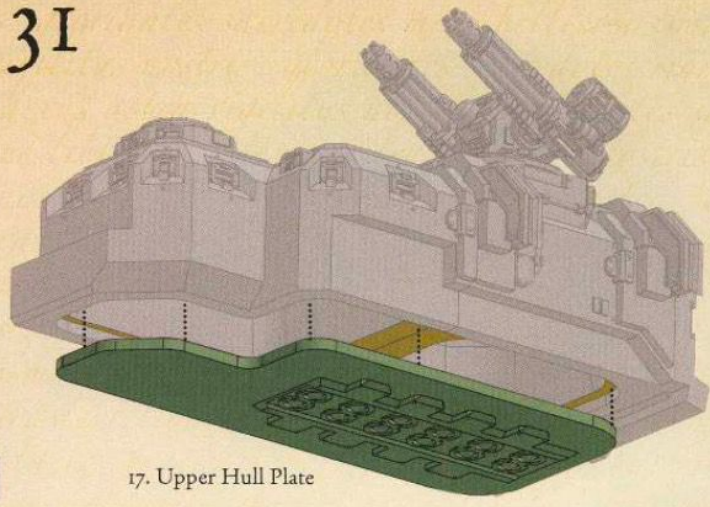

17. Upper Hull Plate

32

29. Hatch

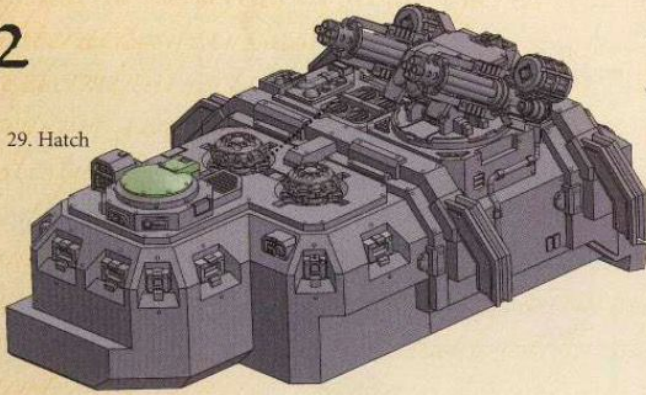

33

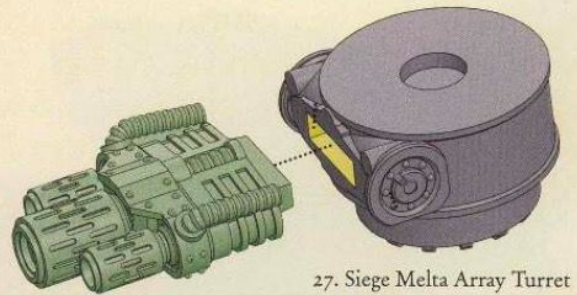

28. Siege Melta Array Barrels

27. Siege Melta Array Turret



You have the option of attaching the Hatch in the open position if you want to display one of the crew within the open hatch.

34

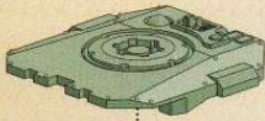

16. Siege Melta Array Upper Plate

Siege Melta Array Assembly

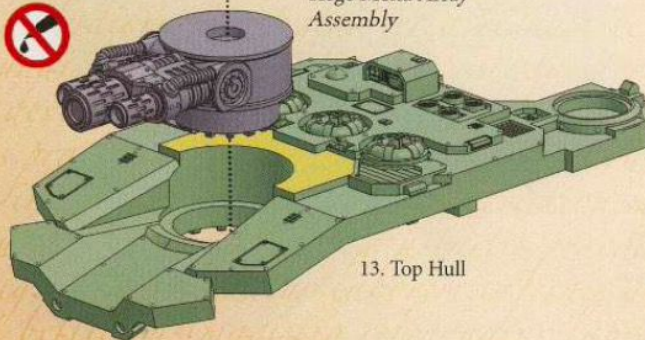

13. Top Hull

35

39. Sponson Mount for Lascannon

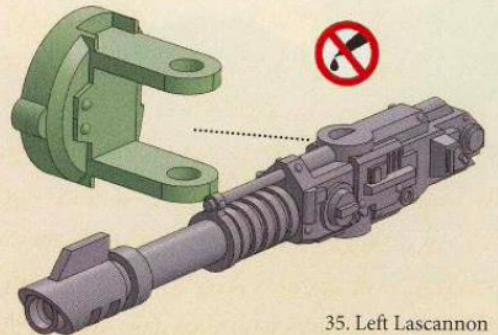

35. Left Lascannon

36

40. Left Lascannon Targetter

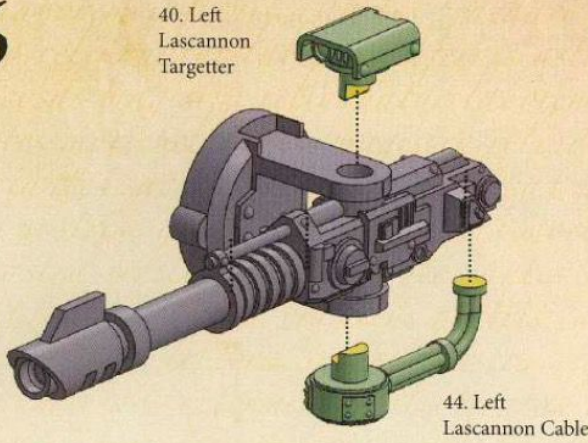

37



The Lascannon Cables are slightly longer than their Heavy Flamer equivalents. The left and right sides are differentiated by the way that the plug is cut. To allow the weapon to turn, avoid getting glue on the Sponson Mount.

38

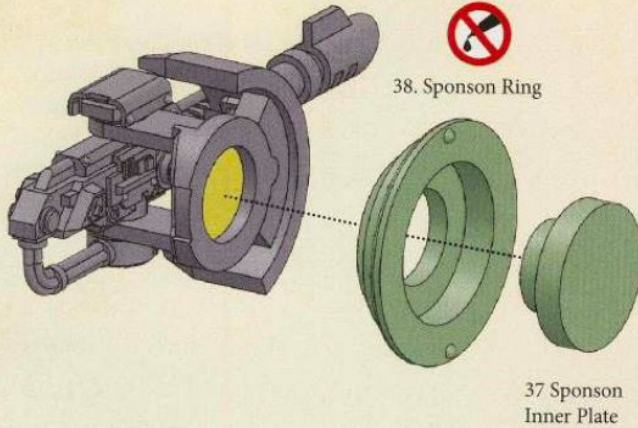

39

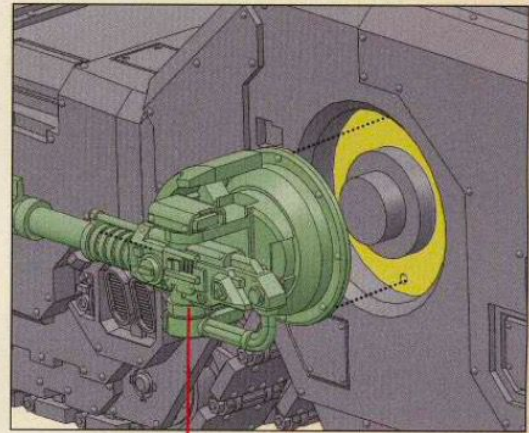

Left Lascannon Assembly

40

37. Sponson Inner Plate



38 Sponson Ring

52. Sponson Mount For Heavy Flamer

42. Left Heavy Flamer Targetter

60. Left Heavy Flamer

46. Left Heavy Flamer Cable

50. Left Heavy Flamer Shield

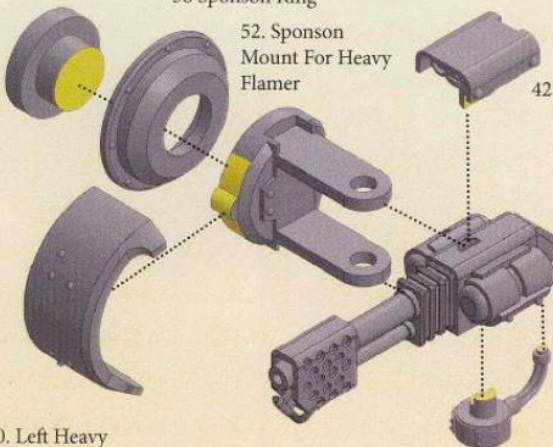

The other sponson turrets are built in exactly the same way as the Left Lascannon turret shown in stages 35 to 39.

For the Right Side Lascannon, use parts 36. Right Lascannon, 41. Right Lascannon Targetter and 45. Right Lascannon Cable and 49. Right Lascannon Shield.

For the Left Heavy Flamer, use the parts shown in stage 40.

For the Right Heavy Flamer, substitute the following parts in stage 40:
 43. Right Heavy Flamer Targetter,
 47. Right Heavy Flamer Cable,
 51. Right Heavy Flamer Shield and
 61. Right Heavy Flamer.

Top Plate Assembly

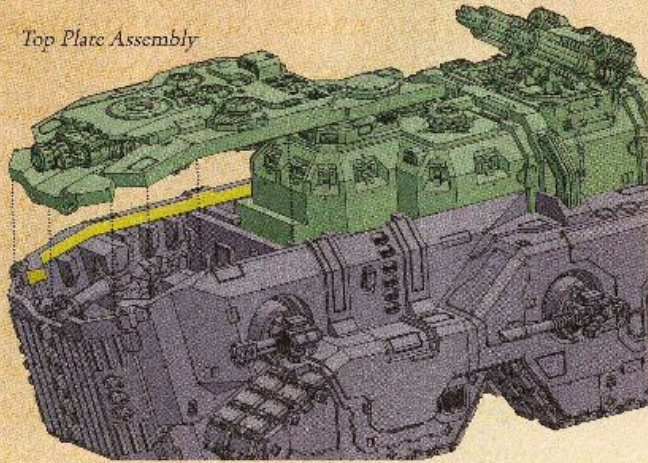

To use the Mustodon as a bunker in games or for display purposes, you can choose not to glue the Command Deck Assembly and the Top Plate Assembly into place so they can be removed as desired.

32. Command Door

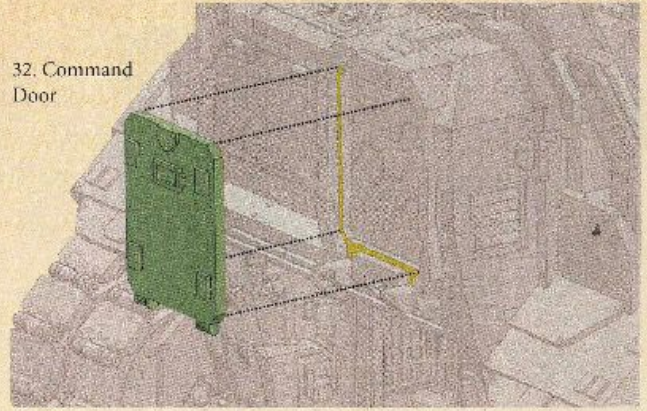

The optional crew can be added to each area with a hatch. The crew with the complete legs should be used in the forward hatch if part 33. Platform is used.

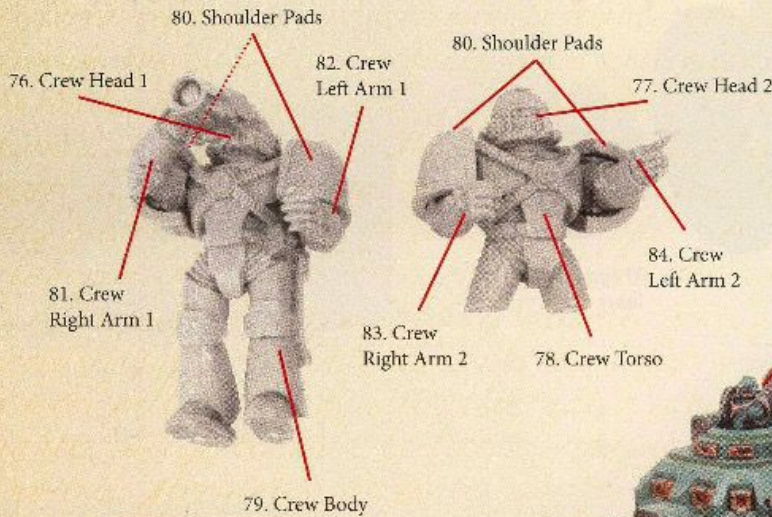

Crew Torso Assembly

Crew Body Assembly



Both of the left and right arm options can be used on either 79. Crew Body or 78. Crew Torso.