



Free Downloads of Build Instructions,  
Assembly Booklets & How To Guides

**BuildInstructions.com**

# LEGION SICARAN

## PUNISHER ASSAULT TANK

*The Punisher-type Sicaran variant came into general use amongst the various Space Marine Legions in the final days of the Great Crusade, however the punisher rotary cannon it mounts has a far older history. Originally mounted on the now rare Cerberus pattern main battle tanks, the punisher had established a reputation as a deadly tool in the eradication of massed conscript infantry or hordes of swarming xenos creatures, limited only by its relatively short range and prodigious appetite for munitions. Married to the Sicaran hull, where the impressive speed of that vehicle effectively negated the short range of the weapon, and the complex feed assemblies developed as part of the various Terran accelerator cannon, the punisher is once again in widespread use among the Legions, though now it is employed against the very warriors it was intended to protect.*



THIS IS NOT A TOY

Not suitable for children under 15 years of age.

WARNING: Resin dust can be harmful if inhaled. Always wear a dust mask or respirator when sanding or sawing resin parts.

[www.forgeworld.co.uk](http://www.forgeworld.co.uk)



993201010384



# Components

Before assembly, check that none of the components are missing.

1. Front Glacis Plate
2. Lower Hull
3. Engine
4. Main Hull
5. Right Track Unit
6. Left Track Unit
7. Large Exhaust x2
8. Small Exhaust x2
9. Hull Hatch
10. Retaining Plate
11. Heavy Bolter Turret
12. Hull Heavy Bolter
13. Sponson Retaining Plate x2
14. Sponson Ring x2
15. Sponson Turret x2
16. Gun Shield x2
17. Sponson Lascannon x2
18. Sponson Targeter x2
19. Lascannon Lower Pivot x2
20. Lascannon Power Cable x2
21. Sponson Heavy Bolter x2
22. Heavy Bolter Ammo Drum x2
23. Heavy Bolter Lower Pivot x2
24. Turret
25. Punisher Rotary Cannon
26. Turret Hatch
27. Ammunition Stowage
28. Ammunition Feed
29. Cannon Arm

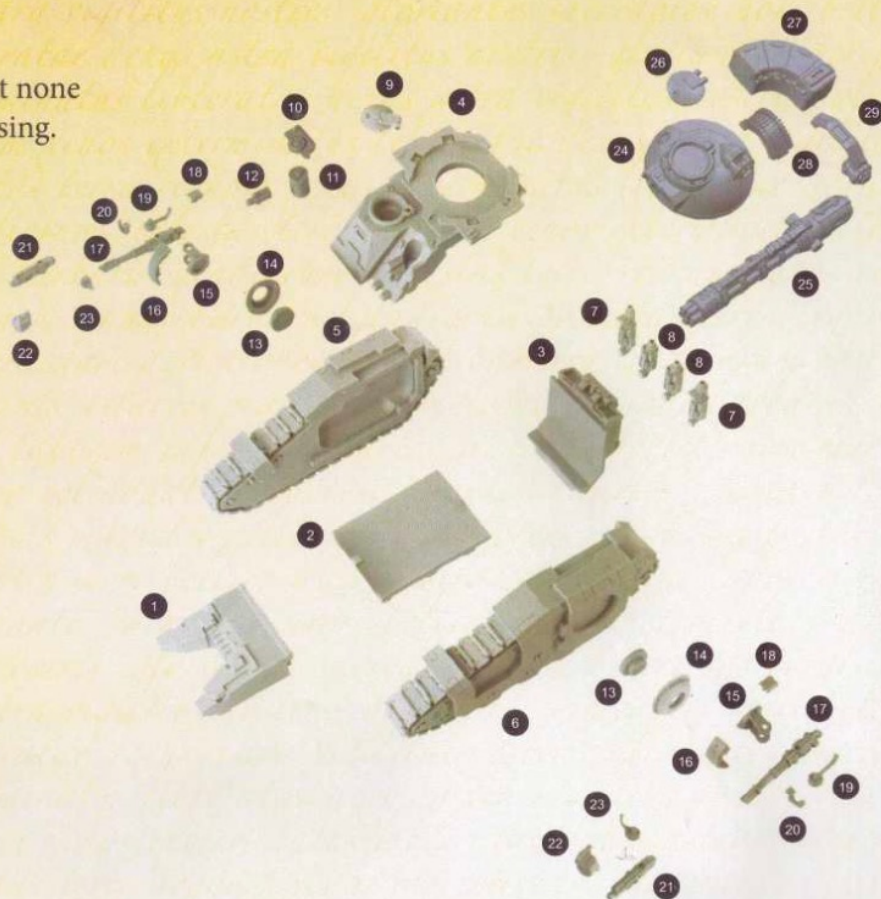

## Assembly Legend

Parts for Assembly



Glue Contact Area



Remove Shim



Optional Part



Note



Do Not Glue



Reverse Angle



Insert



## Preparing the Model for Assembly

Before assembling the model, wash each part thoroughly with an abrasive brush, such as a toothbrush, to remove any model release agent that may still be on the surface of the parts. Then, remove any excess resin such as mould lines, casting gates, vents and shims. For a more detailed guide to working with resin models, go to the Downloads section of the Forge World website.

This kit contains all the pieces required to construct a Legion Sicaran Punisher Assault Tank. To glue the resin pieces together, use Citadel Super Glue.

**NOTE:** We have cast this kit using advanced techniques and the best quality resin, but due to the nature of the casting process, your model may contain small air bubbles. These can easily be filled with model filler or super glue. Any slight warpage of thin parts can be corrected by immersing the part in hot tap water for about 1 minute, then carefully bending it back into shape.

If you need to contact the Forge World Customer Service team regarding this model, you can get in touch via email - [forgeworld@gwplc.com](mailto:forgeworld@gwplc.com) - or call:

0115 900 4995 within the UK

011 44 115 900 4995 from the USA and Canada

0011 44 115 900 4995 from Australia

00 44 115 900 4995 from Europe and the rest of the world.



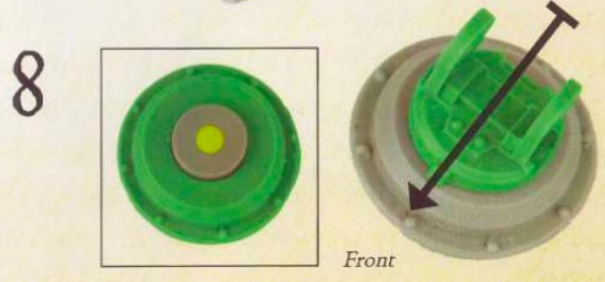
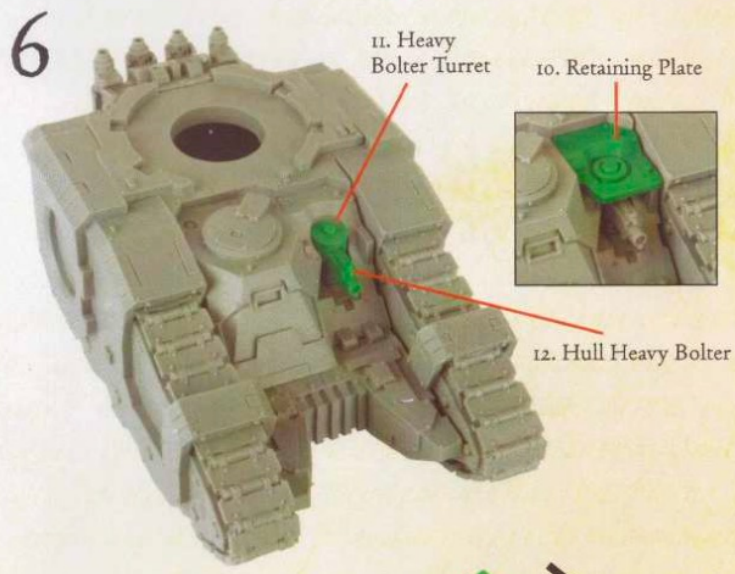
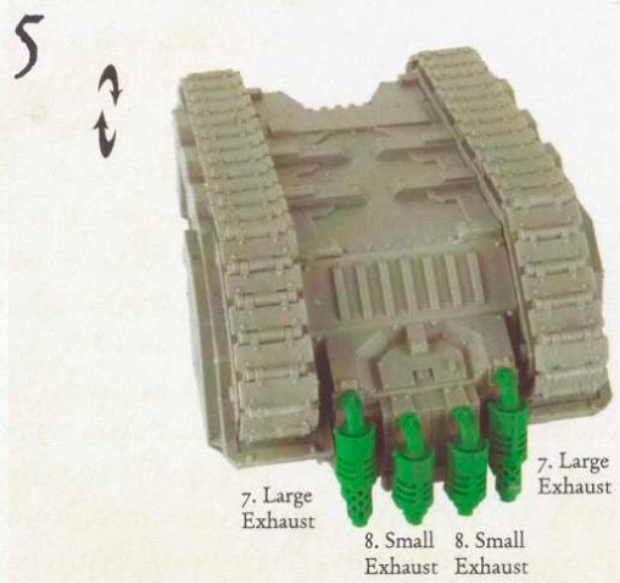
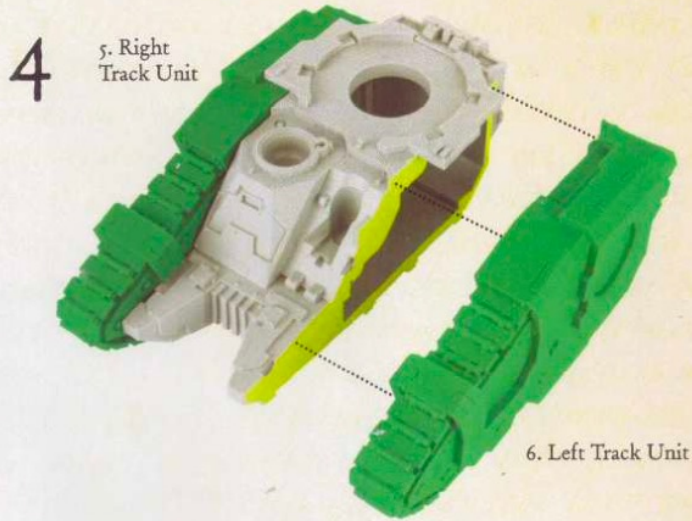
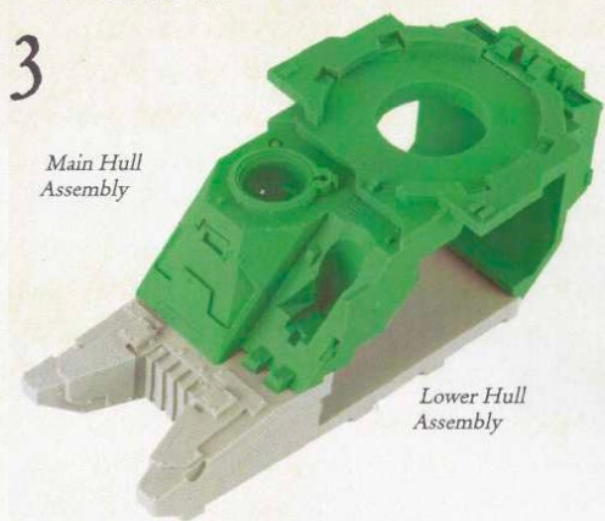
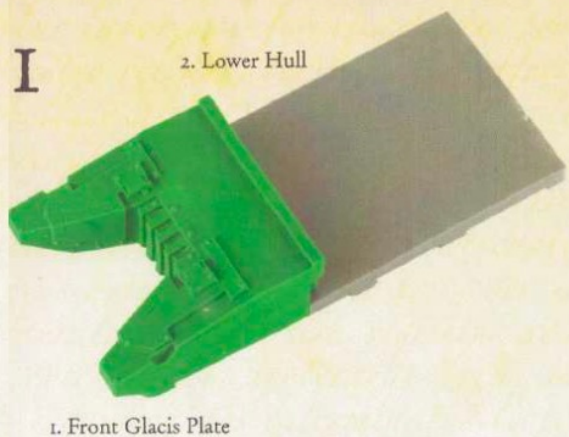

 Apply a small amount of glue to the centre of the Sponson Retaining Plate for the Sponson Turret. This should allow the Sponson Turret to turn.



9

21. Sponson Heavy Bolter

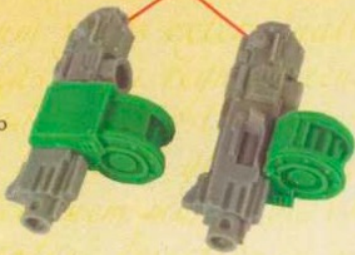

22. Heavy Bolter Ammo Drum

22. Heavy Bolter Ammo Drum



For the Lascannon option, skip this stage and only add part 18. Sponson Targeter from stage 10 before moving onto stage 11.

II

17. Sponson Lascannon



19. Lascannon Lower Pivot

20. Lascannon Power Cable



10

18. Sponson Targeter



23. Heavy Bolter Lower Pivot



The Targeter and the Lower Pivot should be glued into the body of the chosen weapon. Avoid getting glue onto the Sponson Turret itself so the weapon will traverse.

I2

16. Gun Shield



Repeat stages 7 to 12 for both Sponson Turrets.

I3

27. Ammunition Stowage



24. Turret



I4

28. Ammunition Feed



29. Cannon Arm

25. Punisher Rotary Cannon



I5



26. Turret Hatch

I6

Turret Assembly

Sponson Turret Assembly

Sponson Turret Assembly

