



Free Downloads of Build Instructions,
Assembly Booklets & How To Guides

BuildInstructions.com

LEGION SICARAN

ARCUS STRIKE TANK

As part of a program initiated by the Primarch Guilliman, seeking to grant a Legion strike force access to highly specialised weapon systems without the need to employ numerous vehicles for each role, the Sicaran hull was chosen to mount the newly developed arcus launcher, allowing small Legiones Astartes forces to operate without extensive support and in smaller numbers than during the Great Crusade. One variant of note utilised the neutron-flux warhead, a Terran development dating back to the years prior to the alliance with Mars. This weapon saturates the silica stratum of the cybernetica cortex employed by Mechanicum automata with xenon, causing terminal cascade failures in these systems. The continued production of these weapons was the cause of the Mechanicum's refusal to sanction the Arcus pattern hull.

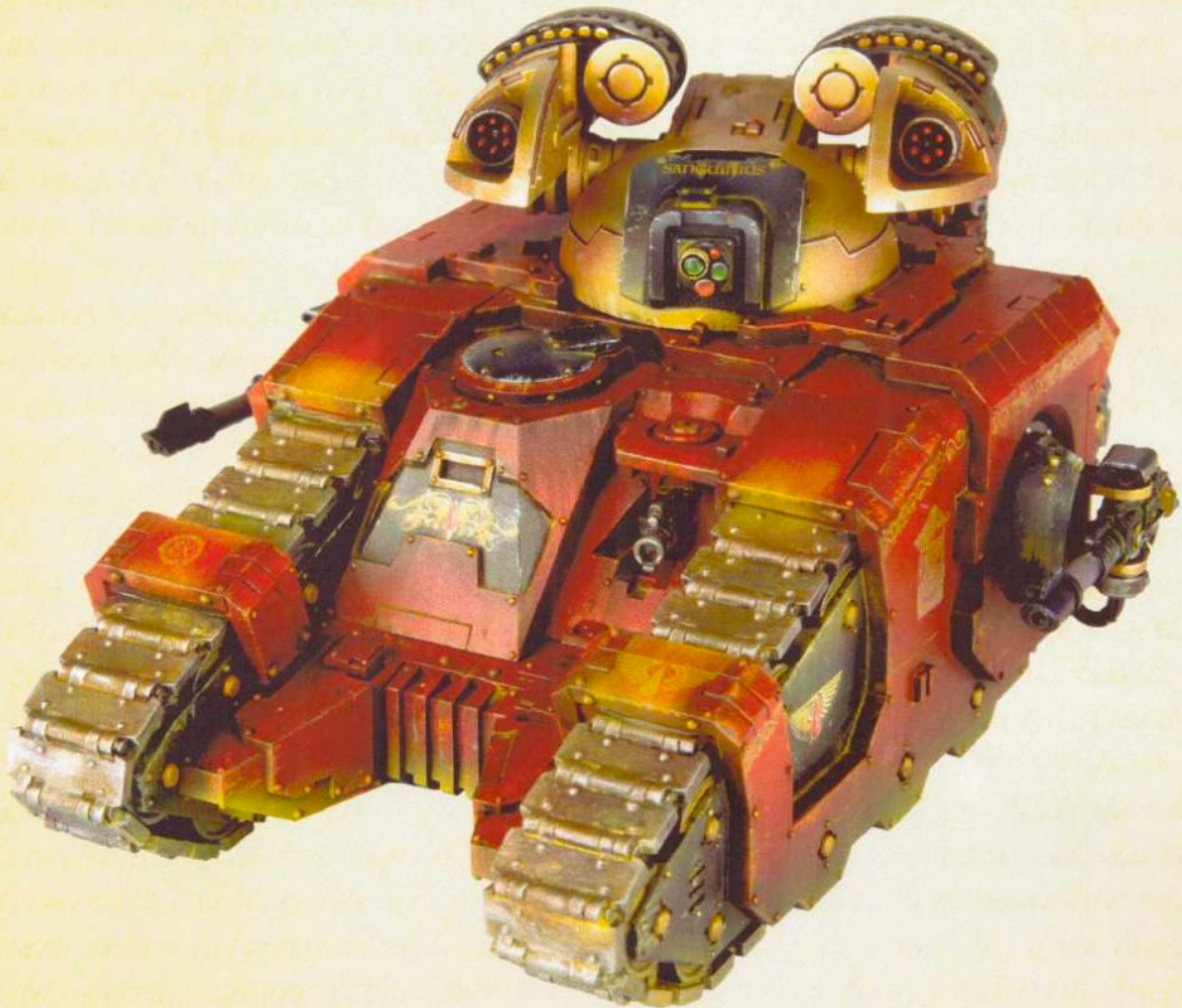

THIS IS NOT A TOY

Not suitable for children under 15 years of age.

WARNING: Resin dust can be harmful if inhaled. Always wear a dust mask or respirator when sanding or sawing resin parts.

www.forgeworld.co.uk



993201010391

Components

Before assembly, check that none of the components are missing.

1. Front Glacis Plate
2. Lower Hull
3. Engine
4. Main Hull
5. Right Track Unit
6. Left Track Unit
7. Large Exhaust x2
8. Small Exhaust x2
9. Hull Hatch
10. Retaining Plate
11. Heavy Bolter Turret
12. Hull Heavy Bolter
13. Sponson Retaining Plate x2
14. Sponson Ring x2
15. Sponson Turret x2
16. Gun Shield x2
17. Sponson Lascannon x2
18. Sponson Targeter x2
19. Lascannon Lower Pivot x2
20. Lascannon Power Cable x2
21. Sponson Heavy Bolter x2
22. Heavy Bolter Ammo Drum x2
23. Heavy Bolter Lower Pivot x2
24. Turret
25. Targeter
26. Right Missile Feed
27. Left Missile Feed
28. Right Missile Launcher
29. Left Missile Launcher
30. Right Launcher Exhaust
31. Left Launcher Exhaust

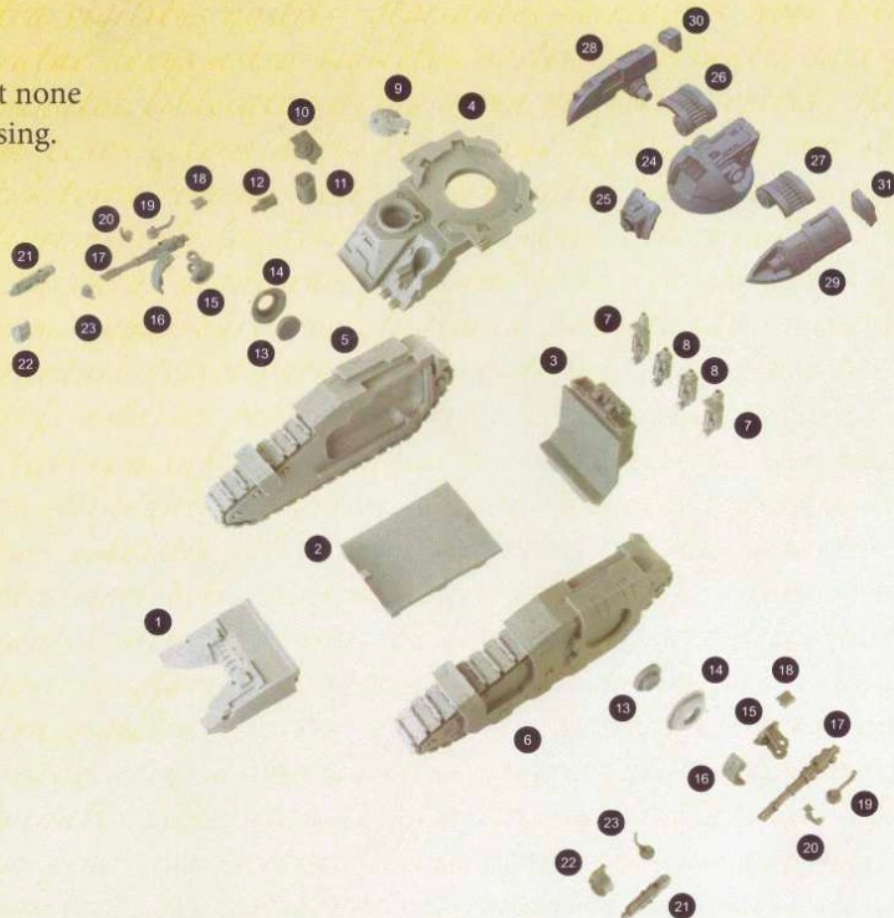

Assembly Legend

Parts for Assembly



Glue Contact Area



Remove Shim



Optional Part



Note



Do Not Glue



Reverse Angle



Insert



Preparing the Model for Assembly

Before assembling the model, wash each part thoroughly with an abrasive brush, such as a toothbrush, to remove any model release agent that may still be on the surface of the parts. For a more detailed information consult the working with resin guide included in this box.

This kit contains all the pieces required to construct a Legion Sicaran Arcus Strike Tank. To glue the resin pieces together, use Citadel Super Glue.

NOTE: We have cast this kit using advanced techniques and the best quality resin, but due to the nature of the casting process, your model may contain small air bubbles. These can easily be filled with model filler or super glue. Any slight warpage of thin parts can be corrected by immersing the part in hot tap water for about 1 minute, then carefully bending it back into shape.

If you need to contact the Forge World Customer Service team regarding this model, you can get in touch via email - forgeworld@gwplc.com - or call:
 0115 900 4995 within the UK
 011 44 115 900 4995 from the USA and Canada
 0011 44 115 900 4995 from Australia
 00 44 115 900 4995 from Europe and the rest of the world.

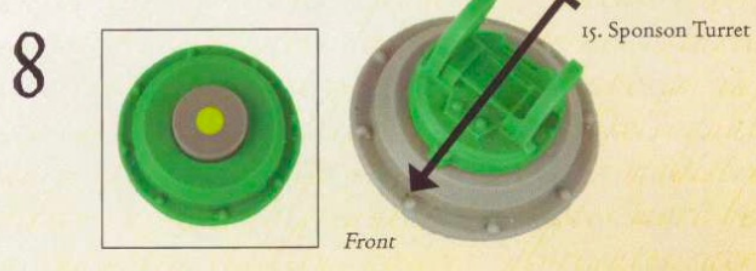
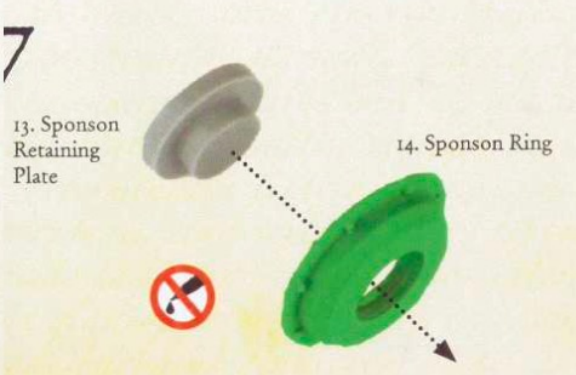
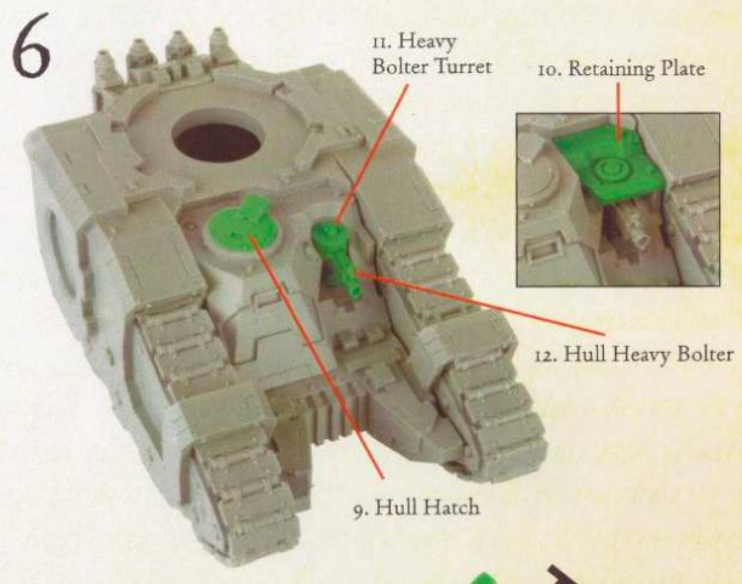
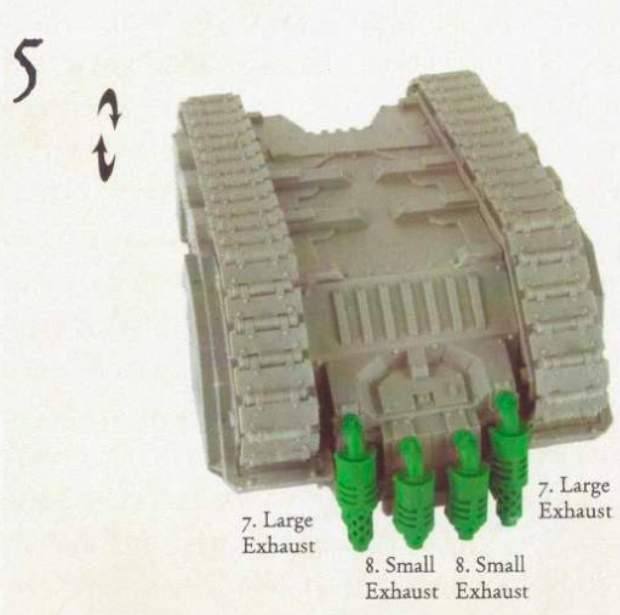
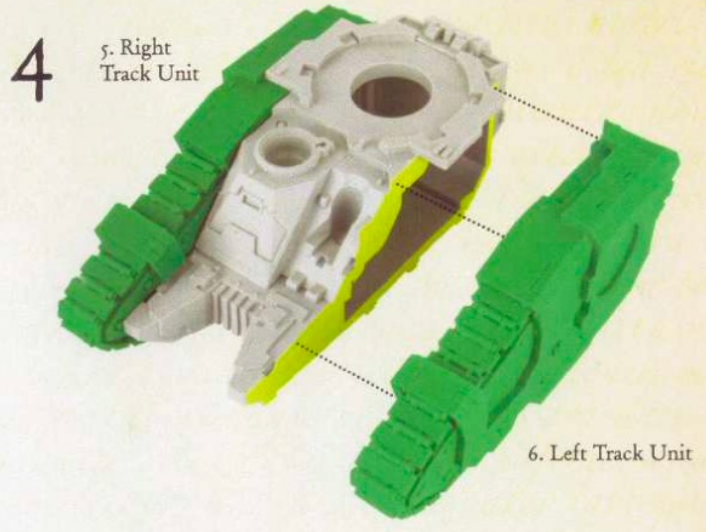
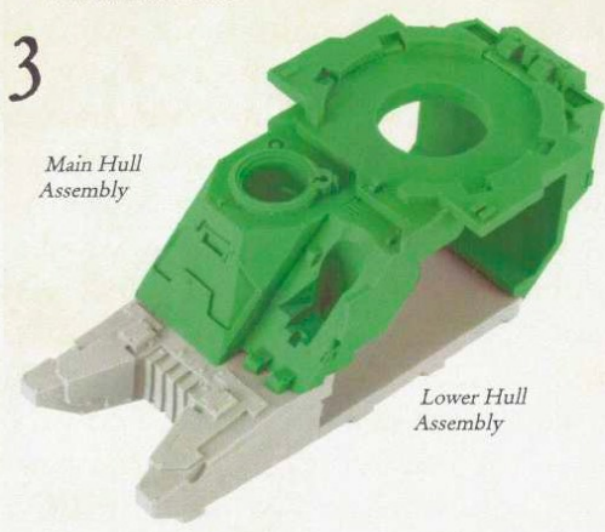
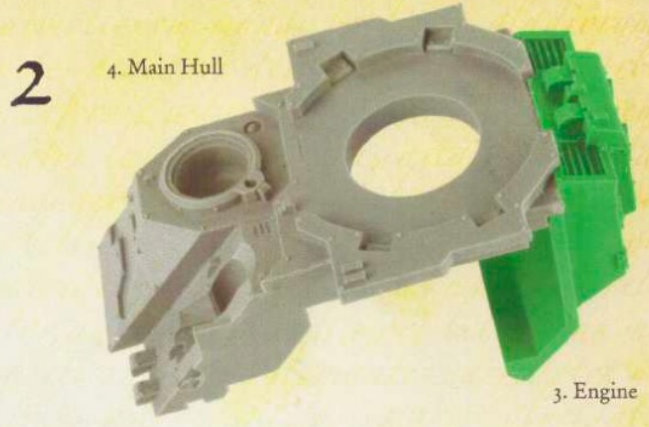
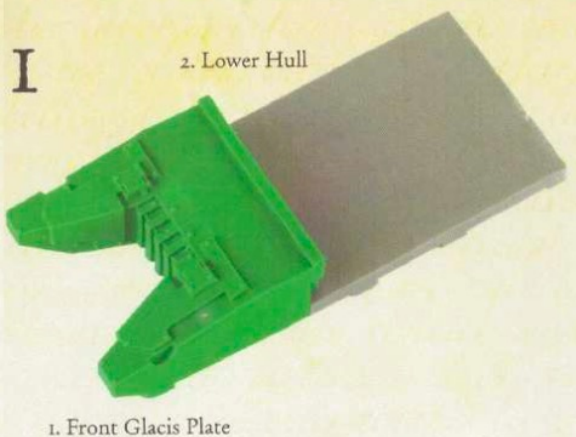

! To allow the Sponson Turret to turn, apply a small amount of glue to the centre of the Sponson Retaining Plate, as indicated above.

9

21. Sponson Heavy Bolter

22. Heavy Bolter Ammo Drum

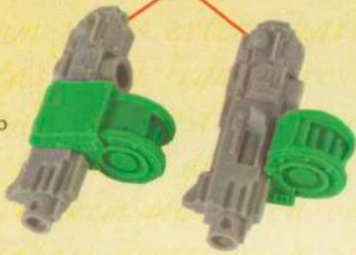

22. Heavy Bolter Ammo Drum

10

18. Sponson Targeter

23. Heavy Bolter Lower Pivot



For the Lascannon option, omit stages 9 and 10.



The Targeter and the Lower Pivot should be glued into the body of the chosen weapon. So the weapon will traverse, avoid getting glue on the Sponson Turret itself.

11

18. Sponson Targeter

17. Sponson Lascannon



19. Lascannon Lower Pivot



20. Lascannon Power Cable

12

16. Gun Shield



Repeat stages 7 to 12 for both Sponson Turrets.

13

29. Left Missile Launcher

31. Left Launcher Exhaust



14

27. Left Missile Feed



15

25. Targeter

Left Missile Launcher Assembly

24. Turret

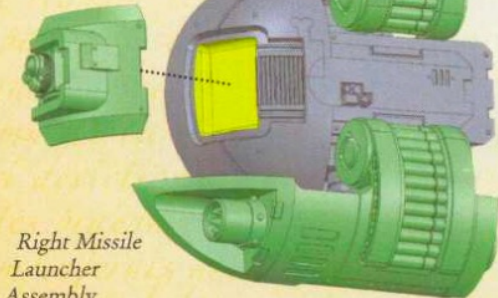

Right Missile Launcher Assembly

16

Turret Assembly



Sponson Turret Assembly