



Free Downloads of Build Instructions,  
Assembly Booklets & How To Guides

**BuildInstructions.com**

# LEGIO CUSTODES CALADIUS GRAV-TANK

*The Caladius pattern grav-tank was often deployed in situations requiring the heaviest of weapons the Legio Custodes could bring to bear. Well-protected and highly manoeuvrable, it was perhaps the most powerful battleline armoured unit of its size in the Imperium's forces, utilising technologies and systems derived not only from the Dark Age of Technology, but from developments made as a result of the Great Crusade's two centuries of warfare.*

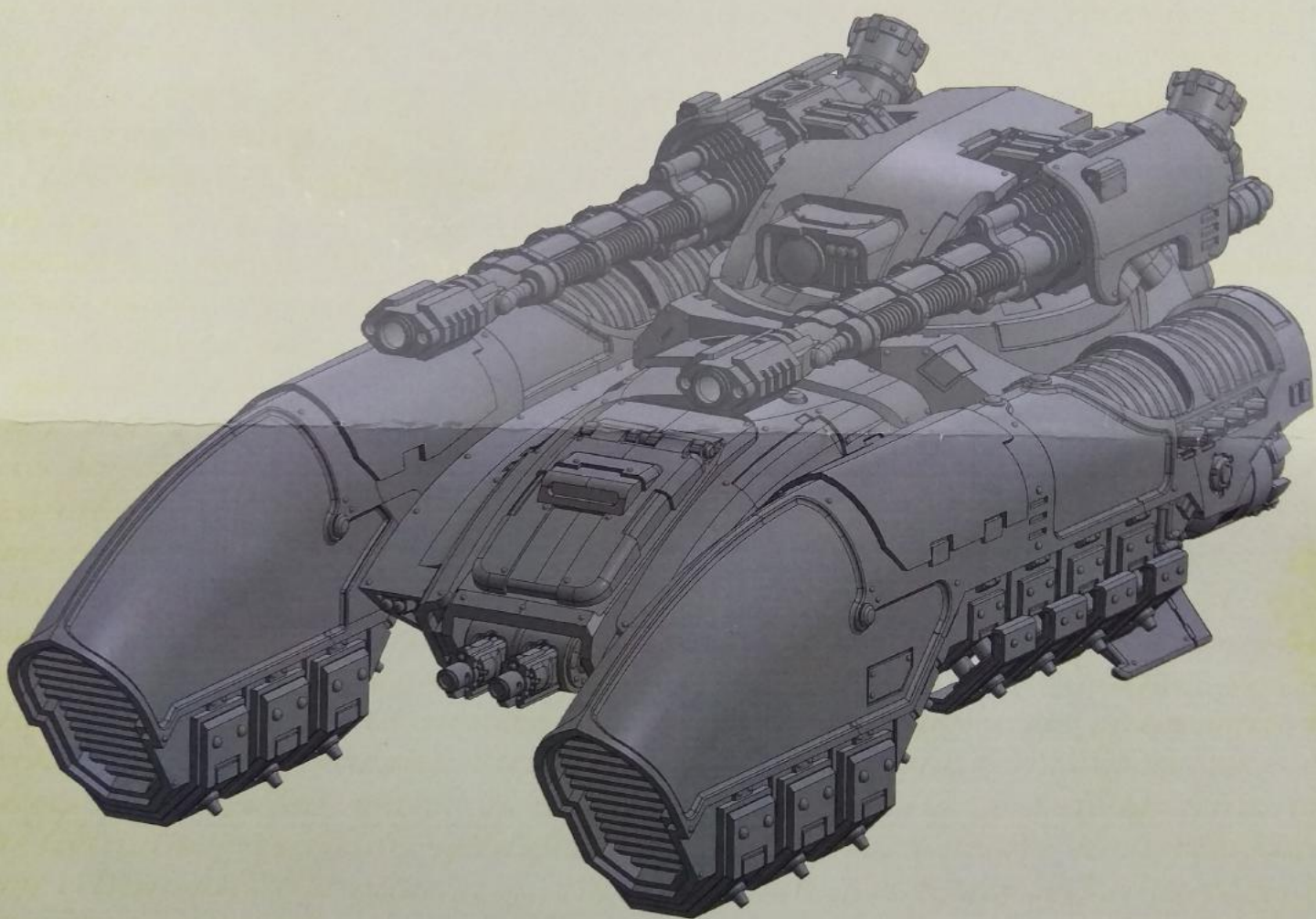

# Components

Before assembly, check that none of the components are missing.

1. Hull
2. Right Nacelle
3. Left Nacelle
4. Turret
5. Generator
6. Right Iliastus
7. Cannon Breach
8. Left Iliastus
9. Cannon Breach
10. Left Cannon Casing
11. Right Cannon Casing
12. Chin Turret
13. Chin Turret Cover
14. Grav-plate x8
15. Iliastus Accelerator Cannon Barrel x2
16. Thruster x2
17. Cannon Coolant Canister x2
18. Cannon Cabling Engine x2
19. Lastrum Bolt Cannon x2
20. Iliastus Cannon Fuel Canisters x2
21. Wing x2
22. Flying Stand Support Flying Stand Base

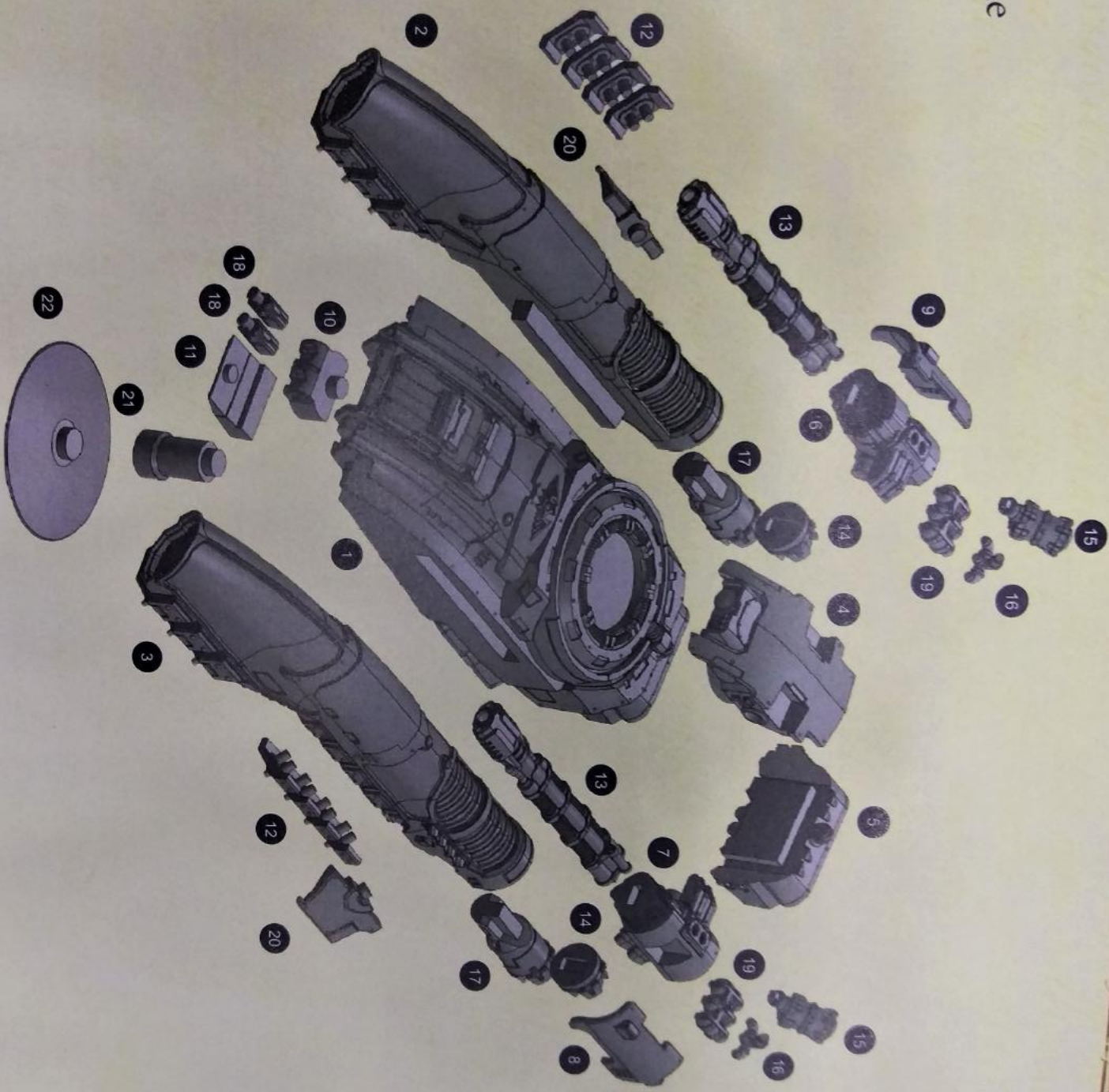

## Assembly Legend

Parts for Assembly



Glue Contact Area



Note



Reverse Angle



Do Not Glue



Insert

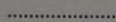

Component Highlight

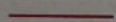

## Preparing the Model for Assembly

Before assembling the model, wash each part thoroughly with an abrasive brush, such as a toothbrush, to remove any model release agent that may still be on the surface of the parts. Then, remove any excess resin such as mould lines, casting gates, vents and shims. For a more detailed guide to working with resin models, go to the Downloads section of the Forge World website.

This kit contains all the pieces required to construct a Caladius Grav-tank. To glue the resin pieces together, use Citadel Super Glue.

NOTE: We have cast this kit using advanced techniques and the best quality resin, but due to the nature of the casting process, your model may contain small air bubbles. These can easily be filled with model filler or super glue. Any slight warpage of thin parts can easily be corrected by immersing the part in hot tap water for about 1 minute, then carefully bending it back into shape.

I

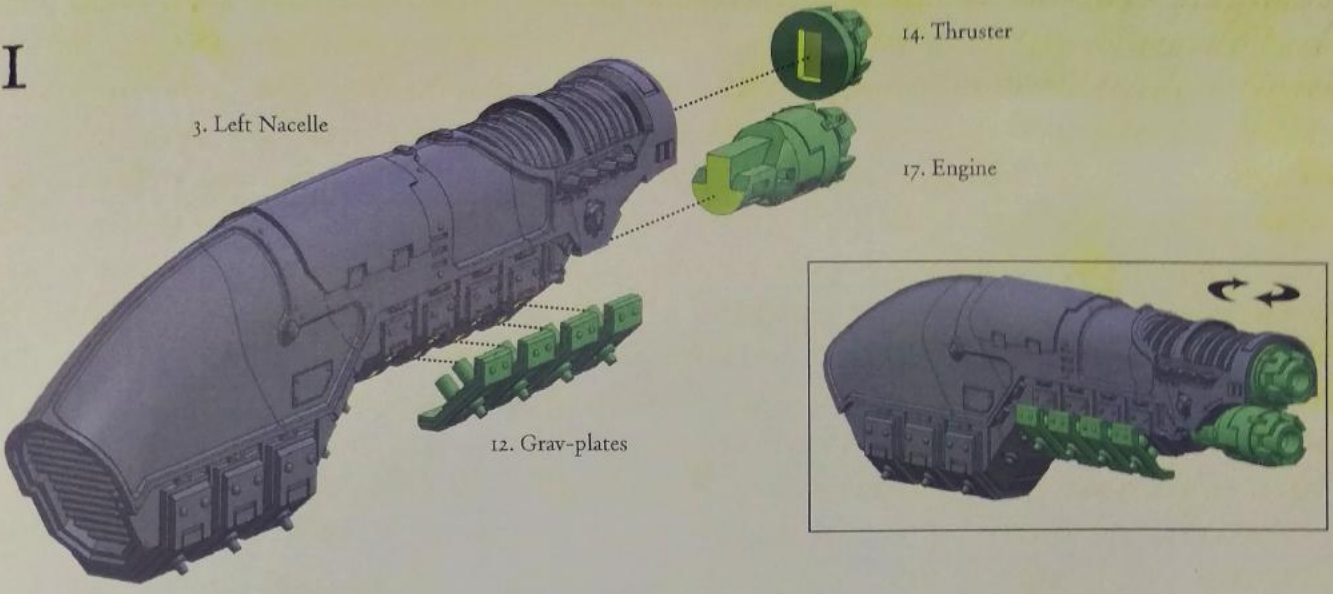

**!** Repeat stage 1 for part 2. Right Nacelle, 12. Grav-plates, 14. Thruster and 17. Engine.

2

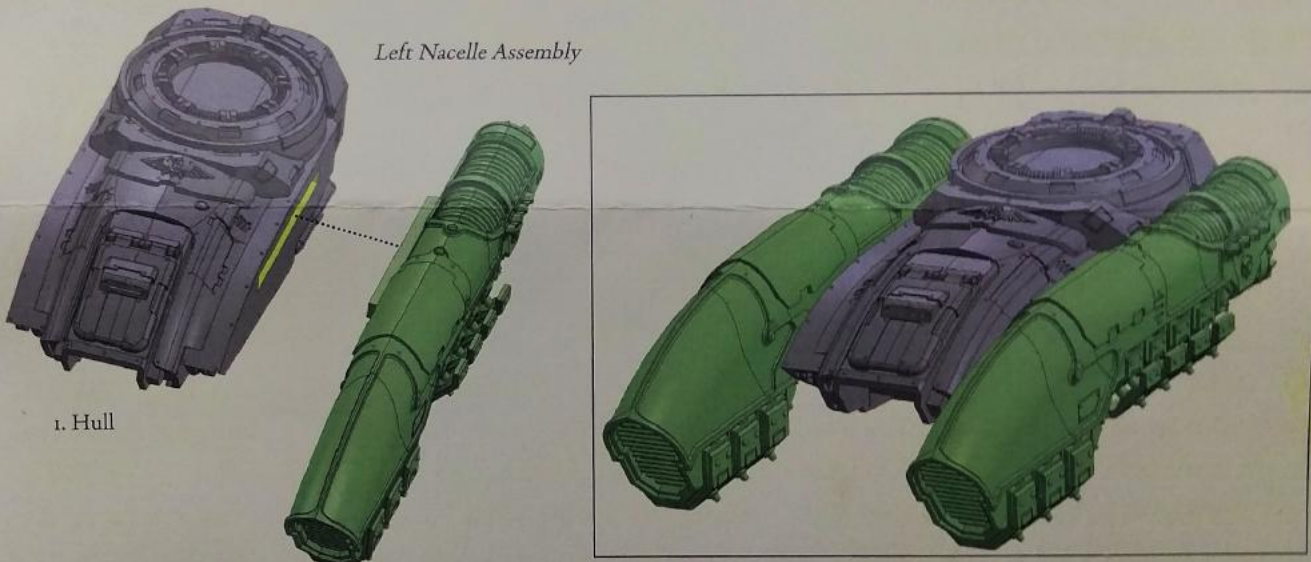

**!** Add both the Left and Right Nacelle Assemblies

3

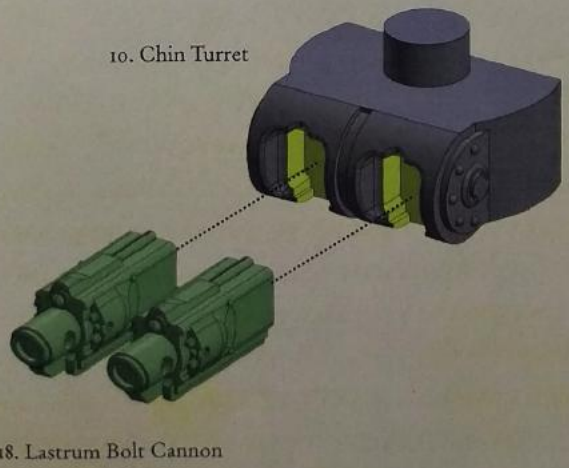

4

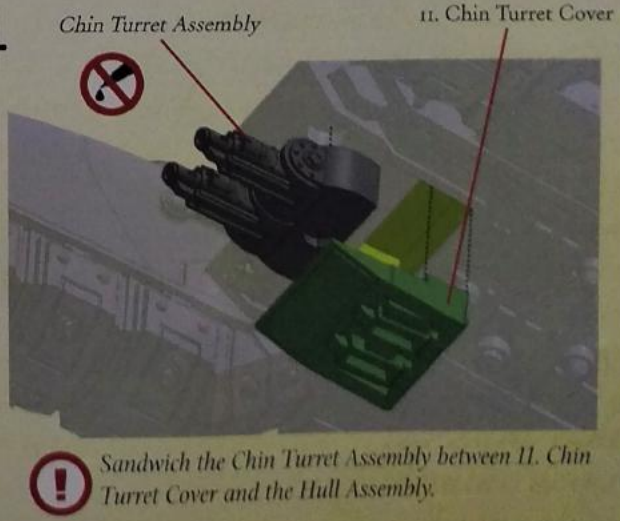

# I

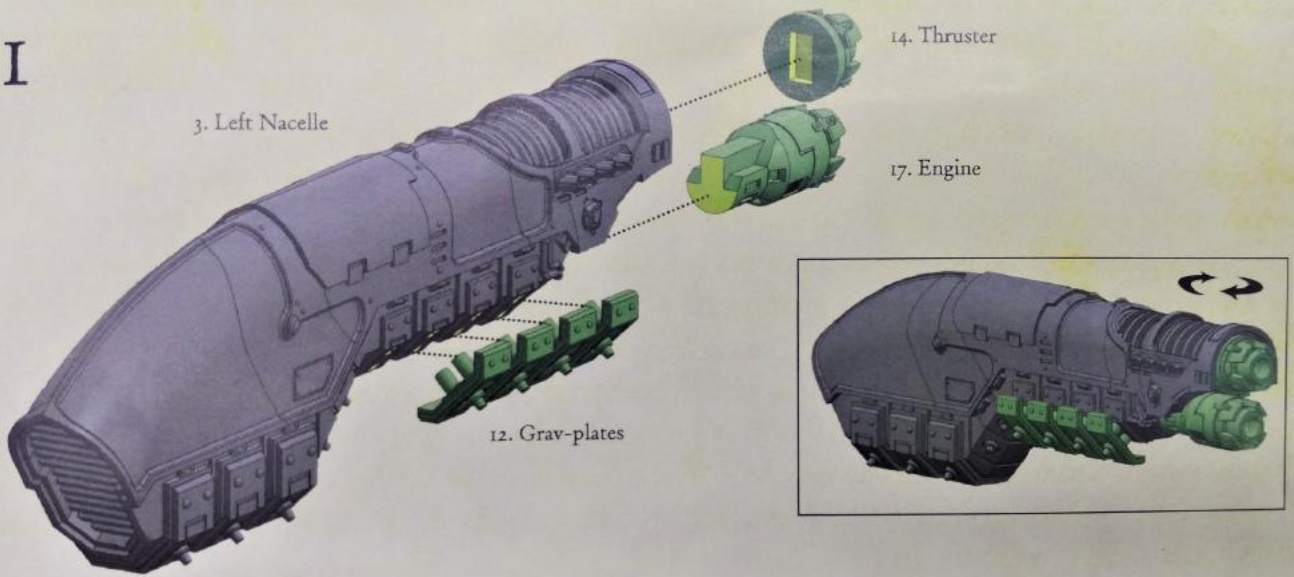

**!** Repeat stage 1 for part 2. Right Nacelle, 12. Grav-plates, 14. Thruster and 17. Engine.

**!** Repeat stage 1 for part 2. Right Nacelle, 12. Grav-plates, 14. Thruster and 17. Engine.

# 2

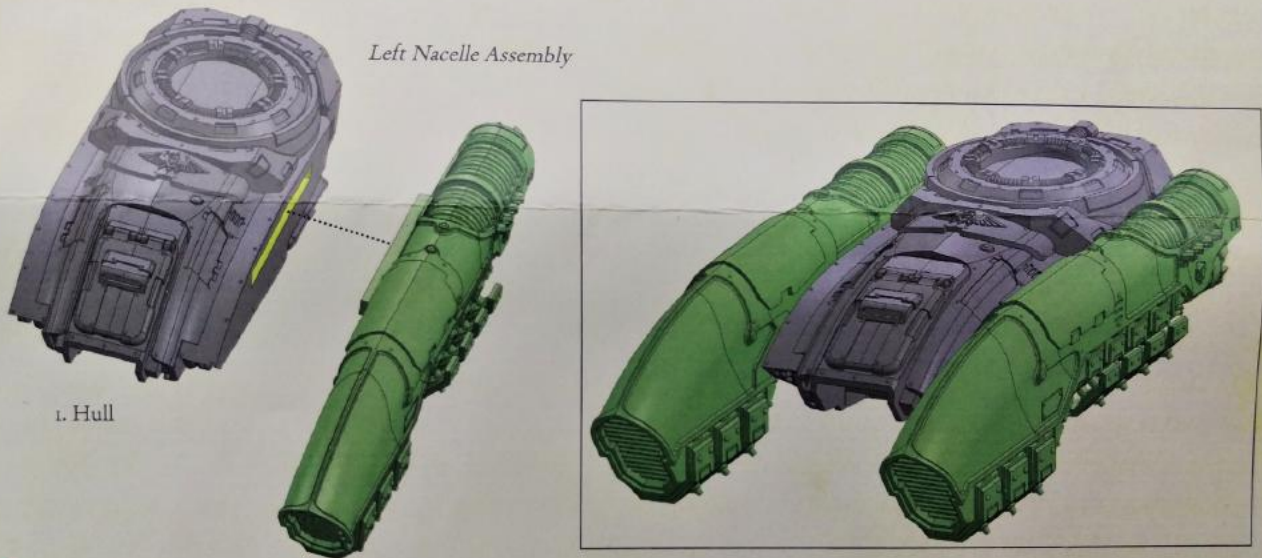

**!** Add both the Left and Right Nacelle Assemblies

# 3

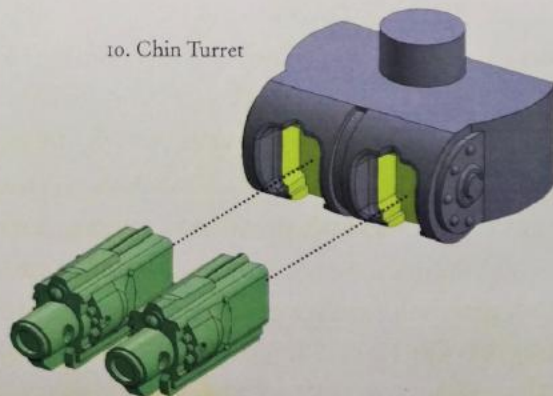

# 4

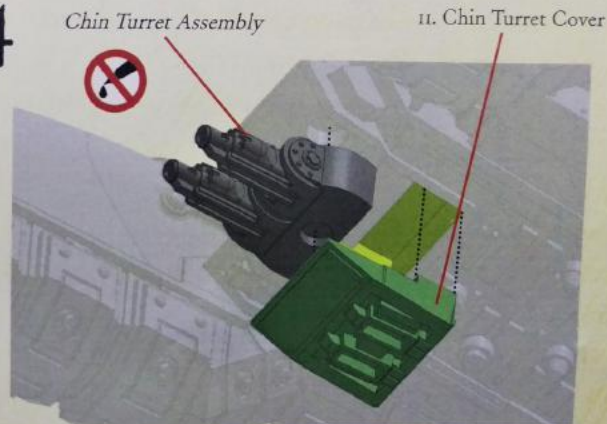

**!** Sandwich the Chin Turret Assembly between 11. Chin Turret Cover and the Hull Assembly.

5

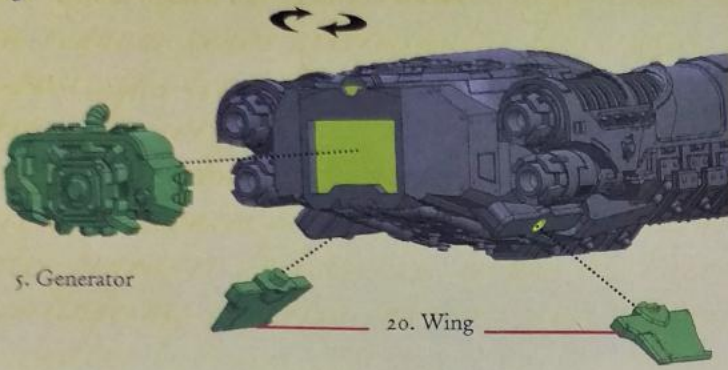

5. Generator

20. Wing

6



7. Left Iliastus Cannon Breech

8. Left Cannon Casing

13. Iliastus Accelerator Cannon Barrel

7

*Left Iliastus Accelerator Cannon Assembly*



15. Cannon Coolant Canister

19. Iliastus Cannon Fuel Canisters

16. Cannon Cabling

8



4. Turret

*Right Iliastus Accelerator Cannon Assembly*

*Left Iliastus Accelerator Cannon Assembly*



For the Right Iliastus Accelerator Cannon, repeat stages 6 and 7 using part 6. Right Iliastus Cannon Breech and 9. Right Cannon Casing.

9

*Iliastus Accelerator Cannon Turret Assembly*



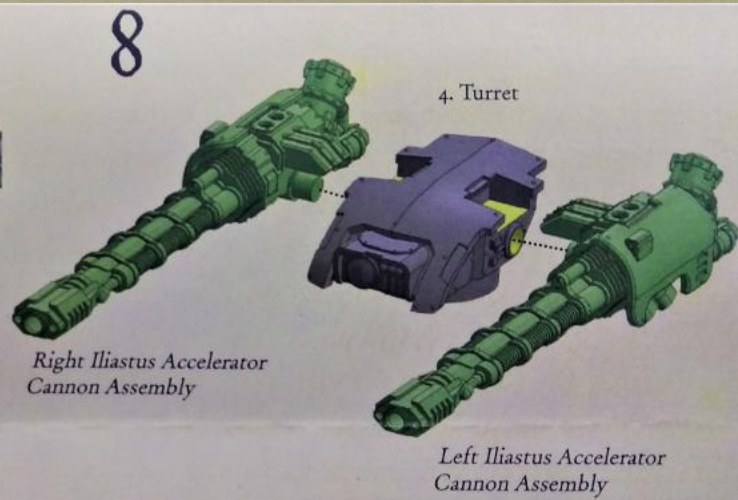
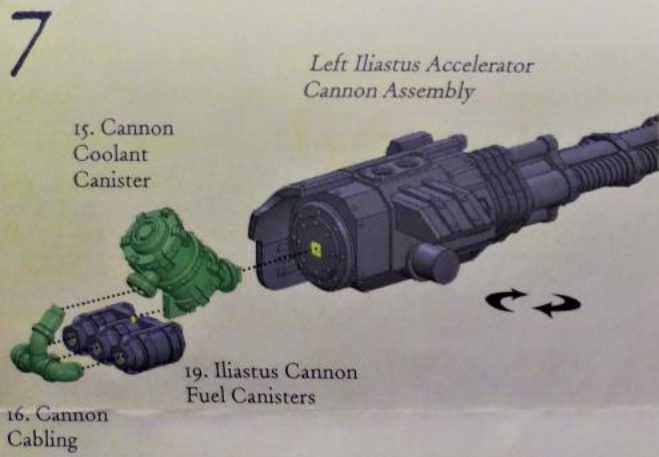
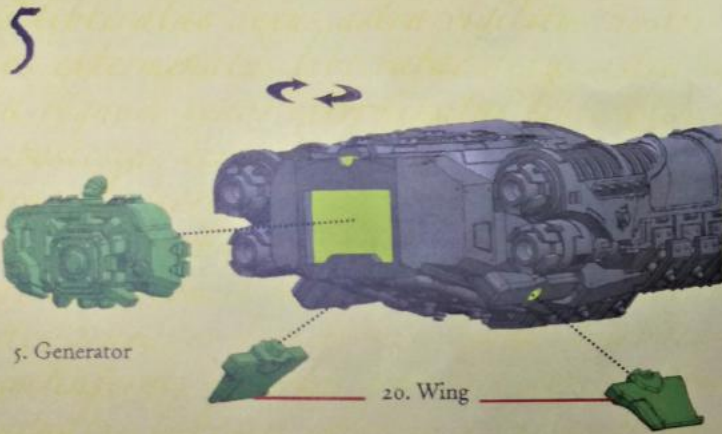

**!** For the Right Iliastus Accelerator Cannon, repeat stages 6 and 7 using part 6. Right Iliastus Cannon Breech and 9. Right Cannon Casing.

