

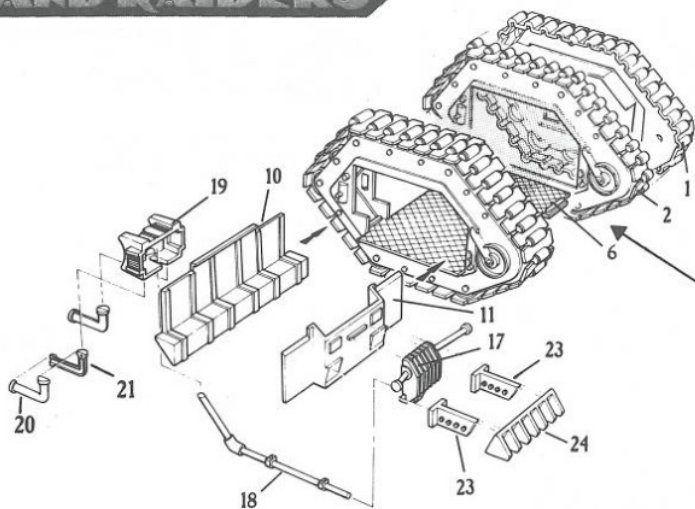

Free Downloads of Build Instructions,
Assembly Booklets & How To Guides

BuildInstructions.com

IMPERIAL LAND RAIDERS



- 1 Glue the left and right track halves together - parts 1 and 2. Repeat for both set of tracks so that you have two complete track units. Allow these to dry.
- 2 Glue the assembled right and left track units to the compartment floor (6). Note that the locating lugs on the floor are designed to fit within the track units with the projecting edge to the front and the flat edge to the rear of the vehicle.
- 3 Glue the rear compartment wall (10) to the main assembly.
- 4 Glue the engine (19) to the rear compartment wall (10). Glue together the right and left halves of the exhausts (parts 20 and 21). Repeat so that you have two exhausts. Allow to dry before fixing to underside of engine (19).
- 5 Glue the front compartment wall (11) to the main assembly, inserting it through the hole in one of the track units.
- 6 Glue the drive shaft (18) to the underside of the vehicle, locating the turned up end on the engine surface. Glue the transmission unit (17) to the front compartment wall (11), locating the drive shaft in the transmission body.
- 7 Assemble the anti-personnel dozer blade from parts 23 (x2) and 24. Fix the completed assembly to compartment front. The angle of these components may be adjusted to vary the appearance of the blade.

NOTE: At this stage you may wish to paint the interior of your Land Raider.

ASSEMBLY INSTRUCTIONS

Before fixing your Land Raider model, study the assembly instructions thoroughly. To assemble your kit you will require a sharp modelling knife and polystyrene cement. Please treat modelling tools with the care they deserve, making cuts away from your body and always firmly supporting the parts being cut. All parts should be removed from the sprue, and plastic mould lines and injection markings cleaned off using the knife.

The appearance of the assembled model will, of course, be greatly enhanced by painting. We recommend using the Citadel Colour range of acrylic paints and inks in order to get the best results. You should rinse all the components in detergent before assembly (a little washing-up liquid and water will do fine). This will remove any grease from the surface of the plastic, which may otherwise inhibit the application of water-based paints

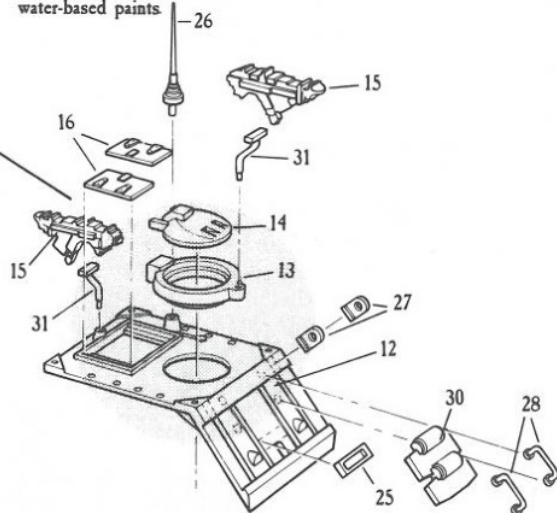

- 1 Carefully locate and cement the hull (12) to the main assembly. The front and back edges should be flush with the front and rear compartment walls.
- 2 Locate and cement the cupola (13), the aerial (26), the lifting lugs (27 x2), the track (30), the vision slit (25), and the two grab handles (28).
- 3 Glue the heavy bolt guns (15) to the pintles (31). Note that you can either glue a single gun to two separate pintles, or you may glue both guns to a single pintle, mounted together to fire in synchronisation.
- 4 Glue the three hatches (14 - commander's hatch, and 16 - rear hatches) in either open or closed positions.
- 5 Locate the gun pintle(s) into either or both front and rear pintle mounting bosses positioned at the rear of the hull or on the commander's cupola. These parts may be glued if you wish, or pushed into place so that they swivel from side to side.

MODELLING OPTIONS

The Land Raider has been designed to allow you to position the two heavy bolt guns on either two separate or a single double mounting. Other parts, such as the smoke launchers, dozer blade, lights, etc. may be positioned to your taste, or left off altogether. Hatches may be modelled in open positions, allowing figures to be positioned within the vehicle itself. Experienced modellers may wish to experiment further, moving or removing the engine components and exhaust systems, altering the positions of hatches and weapons, etc. All of these modifications are possible as the customising, cannibalising and rebuilding of Land Raider is very common amongst Imperial forces.

Parts from the Land Raider kit may also be combined with parts from other Citadel plastic kits such as the Rhino. Metal parts may also be combined if you wish, although epoxy glues and a degree of modelling expertise will be required.

The superb decals in this kit follow standard marking patterns used on Land Raiders serving in the Imperial Forces. But that doesn't mean you can't mix them up or add details of your own! Imperial soldiers often customise their vehicles and add personal markings, so there is no reason why you shouldn't do so too. Examples and inspiration may be drawn from the box illustrations and photographs, or from the painting guides.

To affix decals to your Land Raider model, you will need scissors and a small saucer of water. Cut the decals you wish to use from the sheet, taking care not to damage them. Soak each one in the water for a few minutes. Once the backing is thoroughly soaked, the decals may be slid into position as required. Care must be taken not to tear the decals at this stage. A paint brush is sometimes useful for removing small decals from their backing and positioning them on the vehicle.

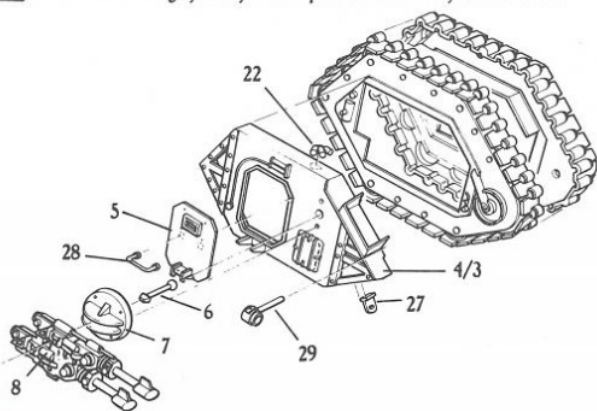

- 1 Glue the left and right sponsons (3 and 4) to the main body, locating around rim.
- 2 Push - do not glue - the weapon mounting pin (6) through the weapon mantle (7). Locate and cement the mantle (7) onto the side sponson fitting it into the lugs provided. Ensure that the weapon mounting pin is free to move in the weapon mantle. Repeat for both sides.
- 3 Locate the side hatch (5) in an open or closed position and cement in place. Repeat for both sides.
- 4 Locate and cement the grab handle (28), the lifting lugs (27), the grenade dischargers (22), and lights (29). Repeat for both sides.
- 5 Locate and cement the las-cannon (8) to the weapon mounting pin (6). Ensure the weapon is free to swivel in its mount. Repeat for both sides.