

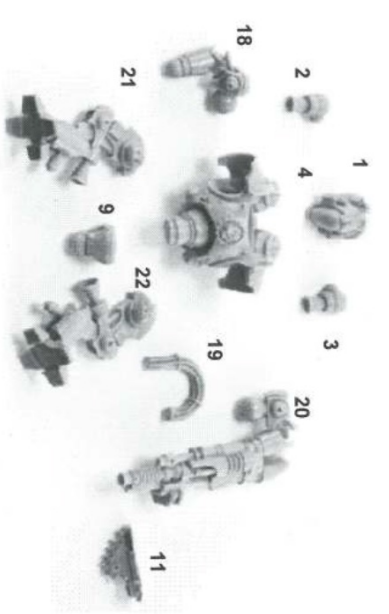

Free Downloads of Build Instructions,
Assembly Booklets & How To Guides

BuildInstructions.com

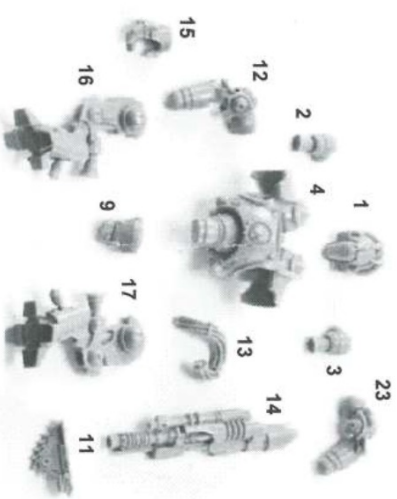
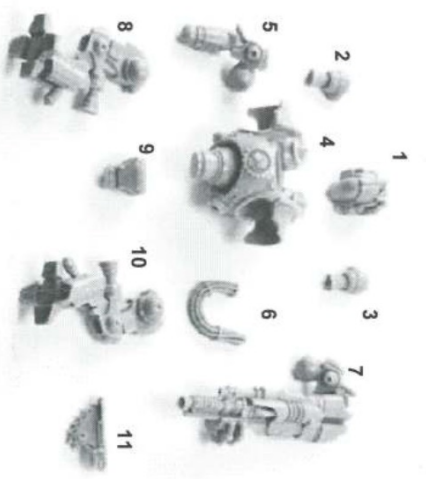

RESIN COMPONENTS LIST

1. Head x3
2. Right Jetpack Nozzle
3. Left Jetpack Nozzle
4. Torso x3
5. Right Arm 1
6. Power Cable 1
7. Lightning Gun 1
8. Right Leg 1
9. Waist x3
10. Left Leg 1
11. Chain Blade x3
12. Right Arm 2
13. Power Cable 2
14. Lightning Gun 2
15. Right Hand
16. Right Leg 2
17. Left Leg 2
18. Right Arm 3
19. Power Cable 3
20. Lightning Gun 3
21. Right Leg 3
22. Left Leg 3
23. Left arm 2

This kit contains all the pieces required to build the Mechanicum Thallax Cohort. To glue the resin pieces together and to plastic kit parts use Citadel Super Glue.

NOTE: We have cast this kit using the most advanced techniques and the best quality resin, but due to the nature of the casting process your model may contain very slight air bubbles. These can easily be filled with model filler or super glue. Any slight warpage of thin parts can easily be corrected by immersing the part in hot tap water for about 1 minute then carefully bending it back into shape.

THIS IS NOT A TOY

Not suitable for children under 15 years of age.
WARNING: Resin dust can be harmful if inhaled. Always wear a dust mask or respirator when sanding or sawing resin parts.

If a component does not have a number marked on the sprue a number of dots will designate the number of the part.

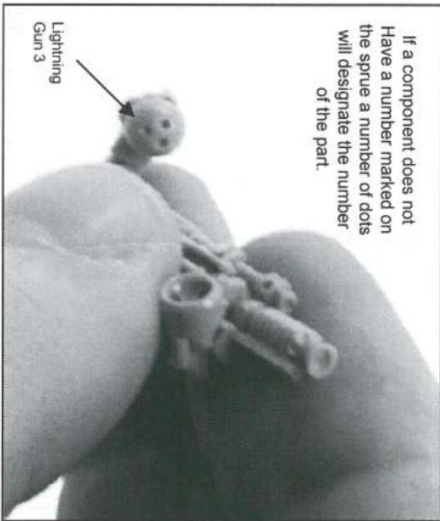

The copyright on the model designs and components within this box is the exclusive property of Games Workshop Ltd. Copyright Games Workshop Ltd., 2013. All rights reserved.

