



Free Downloads of Build Instructions,  
Assembly Booklets & How To Guides

**BuildInstructions.com**

# LEGIO CUSTODES CALADIUS GRAV-TANK

*The Caladius pattern grav-tank was often deployed in situations requiring the heaviest of weapons the Legio Custodes could bring to bear. Well-protected and highly manoeuvrable, it was perhaps the most powerful battleline armoured unit of its size in the Imperium's forces, utilising technologies and systems derived not only from the Dark Age of Technology, but from developments made as a result of the Great Crusade's two centuries of warfare.*

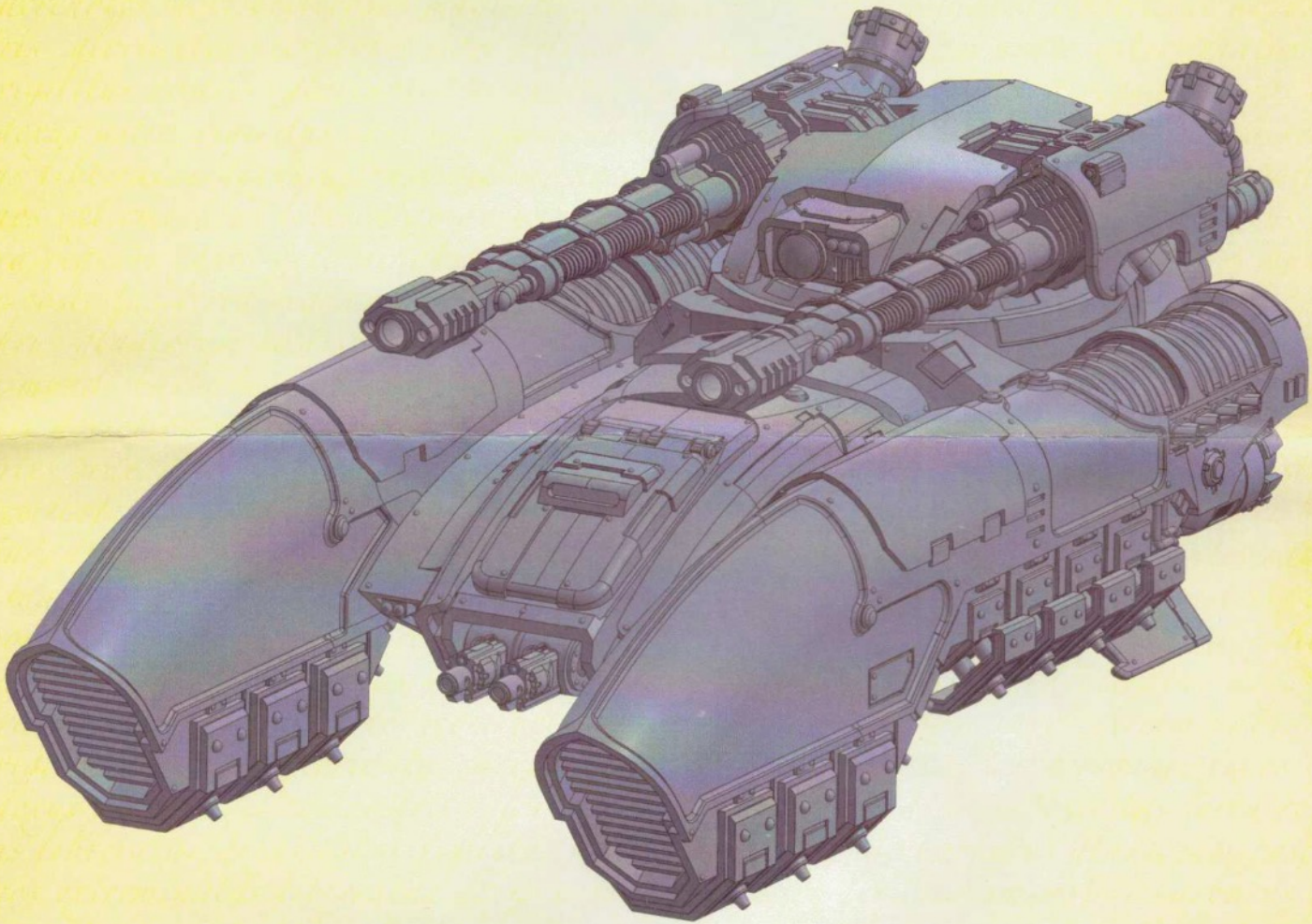

**THIS IS NOT A TOY**

Not suitable for children under 15 years of age.

**WARNING:** Resin dust can be harmful if inhaled. Always wear a dust mask or respirator when sanding or sawing resin parts.

[www.forgeworld.co.uk](http://www.forgeworld.co.uk)



993201080165

# Components

Before assembly, check that none of the components are missing.

1. Hull
2. Left Nacelle
3. Right Nacelle
4. Turret
5. Generator
6. Right Illiastus Cannon Breech
7. Left Illiastus Cannon Breech
8. Left Cannon Casing
9. Right Cannon Casing
10. Chin Turret
11. Chin Turret Cover
12. Grav-plate x8
13. Illiastus Accelerator Cannon Barrel x2
14. Thruster x2
15. Cannon Coolant Canister x2
16. Cannon Cabling
17. Engine x2
18. Lastrum Bolt Cannon x2
19. Illiastus Cannon Fuel Canisters x2
20. Wing x2
21. Flying Stand Support
22. Flying Stand Base

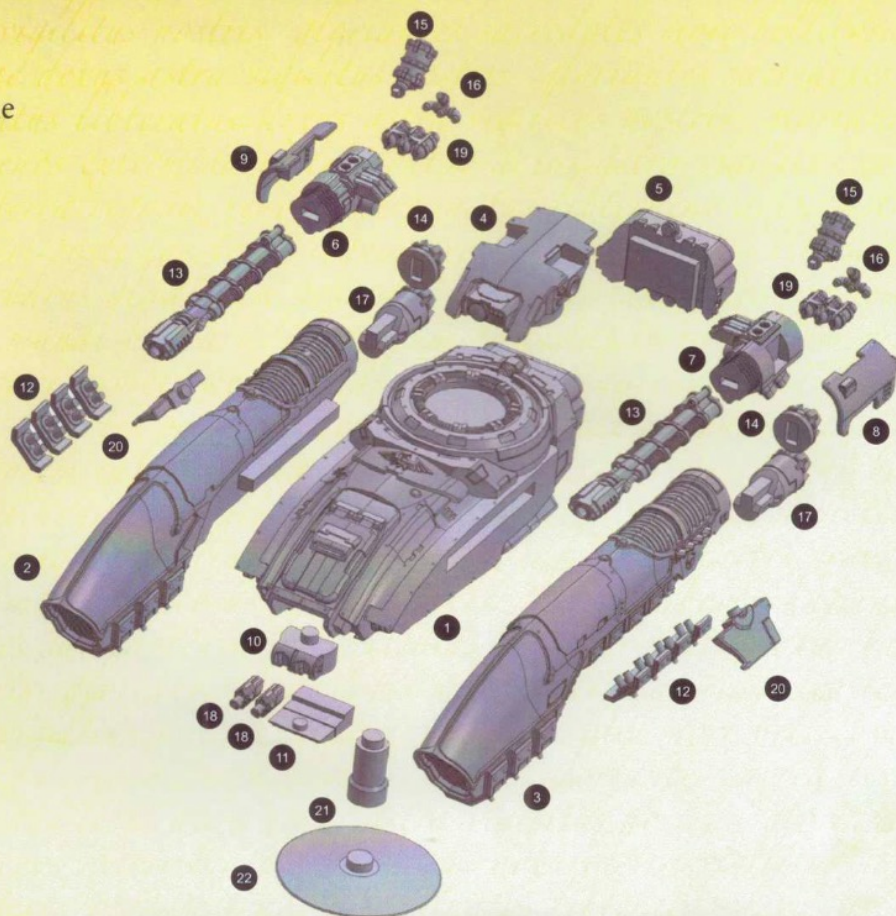

## Assembly Legend

Parts for Assembly



Glue Contact Area



Note



Reverse Angle



Do Not Glue



Insert



Component Highlight



## Preparing the Model for Assembly

Before assembling the model, wash each part thoroughly with an abrasive brush, such as a toothbrush, to remove any model release agent that may still be on the surface of the parts. Then, remove any excess resin such as mould lines, casting gates, vents and shims. For a more detailed guide to working with resin models, go to the Downloads section of the Forge World website.

This kit contains all the pieces required to construct a Caladius Grav-tank. To glue the resin pieces together, use Citadel Super Glue.

**NOTE:** We have cast this kit using advanced techniques and the best quality resin, but due to the nature of the casting process, your model may contain small air bubbles. These can easily be filled with model filler or super glue. Any slight warpage of thin parts can easily be corrected by immersing the part in hot tap water for about 1 minute, then carefully bending it back into shape.

If you need to contact the Forge World Customer Service team regarding this model, you can get in touch via email - [forgeworld@gwplc.com](mailto:forgeworld@gwplc.com) - or call:

0115 900 4995 within the UK

011 44 115 900 4995 from the USA and Canada

0011 44 115 900 4995 from Australia

00 44 115 900 4995 from Europe and the rest of the world.

I

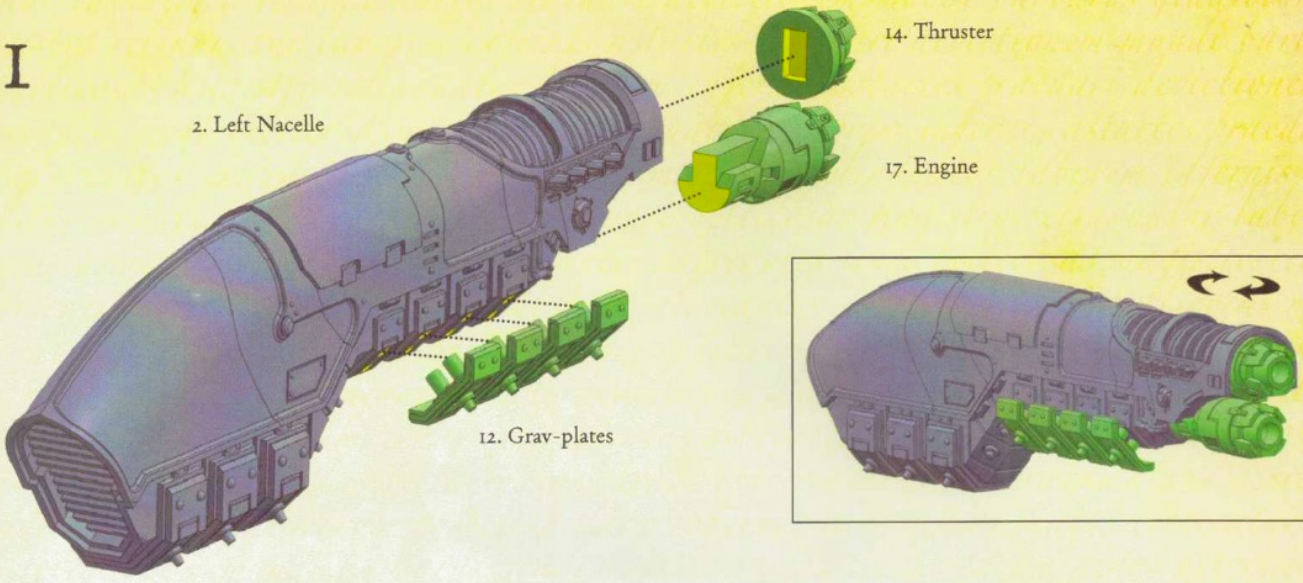

**!** Repeat stage 1 for part 3. Right Nacelle, 12. Grav-plates, 14. Thruster and 17. Engine.

2

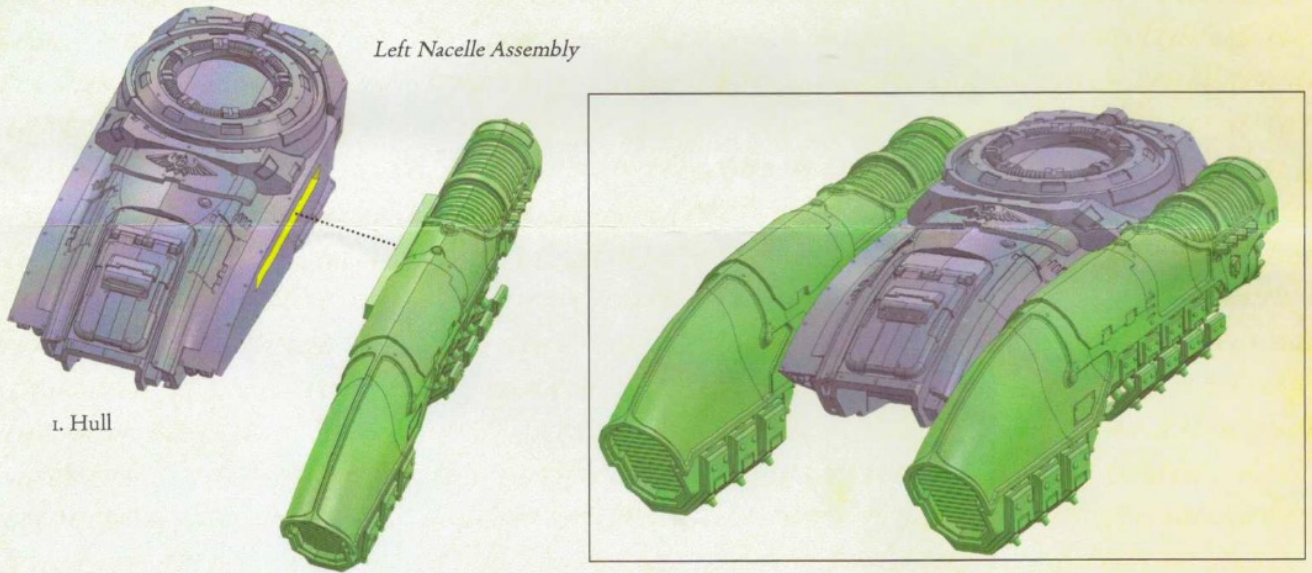

**!** Add both the Left and Right Nacelle Assemblies

3

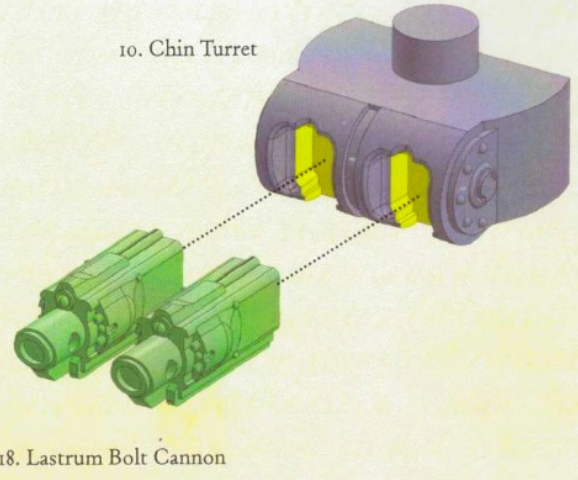

4

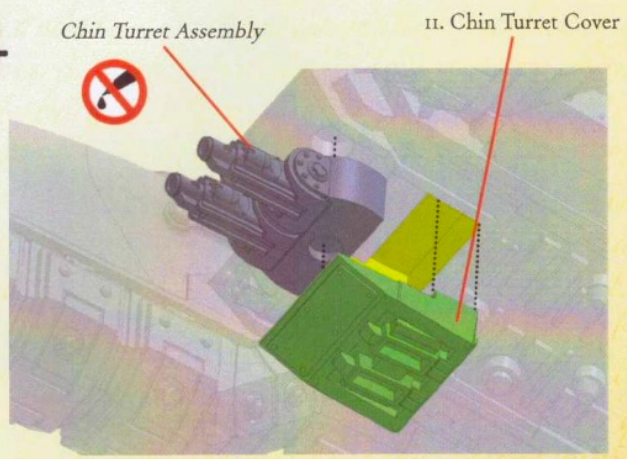

**!** Sandwich the Chin Turret Assembly between 11. Chin Turret Cover and the Hull Assembly.

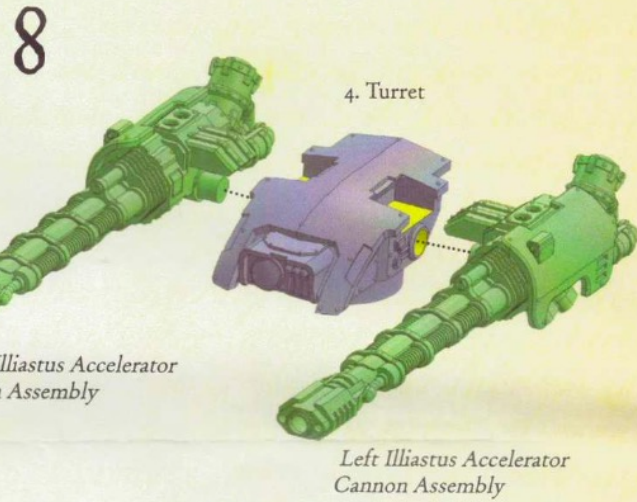
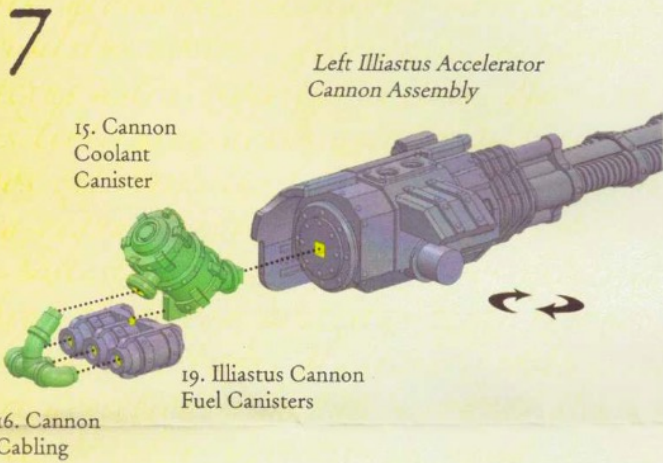
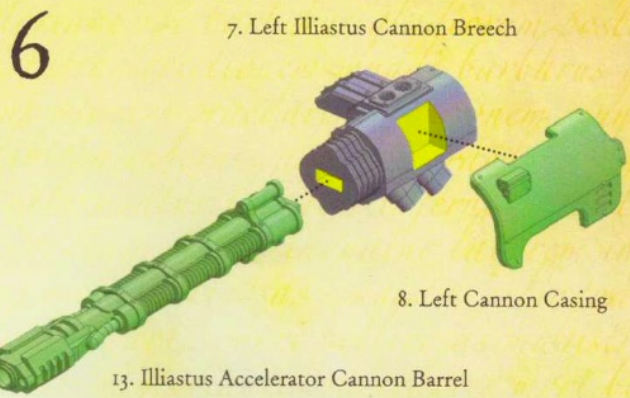
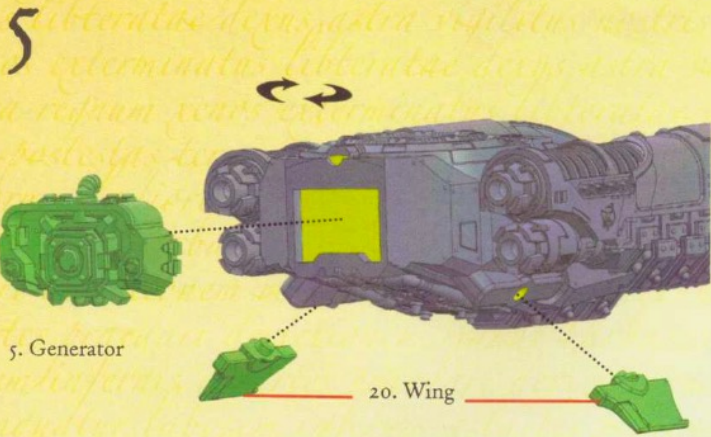

**!** For the Right Illiastus Accelerator Cannon, repeat stages 6 and 7 using part 6. Right Illiastus Cannon Breech and 9. Right Cannon Casing.

