



Free Downloads of Build Instructions,
Assembly Booklets & How To Guides

BuildInstructions.com

Forge World®

CHAOS KNIGHT

RESIN COMPONENTS

1. Carapace
2. Shoulder Plate 1
3. Shoulder Plate 2
4. Chest Plate
5. Shin Pad 1
6. Shin Pad 2
7. Pivot Cover for Chainblade
8. Face Plate
9. Weapon Counter Weight
10. Besagew 1
11. Besagew 2
12. Thermal Cannon Weapon Shield
13. Rapid-fire Battlecannon Weapon Shield
14. Thigh Plate 1
15. Thigh Plate 2
16. Reactor Cover
17. Groin Plate
18. Chainblade

Many of the resin parts in this kit directly replace the equivalent plastic part. Look out for circled part numbers in the Plastic Components Assembly guide. These will be the parts that are replaced.

This kit contains all the pieces required to construct a Chaos Knight Errant or Paladin.

To glue the resin pieces together, use Citadel Super Glue.

NOTE: We have cast this kit using the most advanced techniques and the best quality resin, but due to the nature of the casting process your model may contain very slight air bubbles. These can easily be filled with model filler or super glue. Any slight warpage of thin parts can easily be corrected by immersing the part in hot tap water for about 1 minute then carefully bending it back into shape.

THIS IS NOT A TOY

Not suitable for children under 15 years of age.

WARNING: Resin dust can be harmful if inhaled. Always wear a dust mask or respirator when sanding or sawing resin parts.



Forge World®

CHAOS KNIGHT™

Build the plastic kit up to this stage. The plastic parts that are replaced during the build are indicated in the Plastic Components Assembly in this construction sheet.

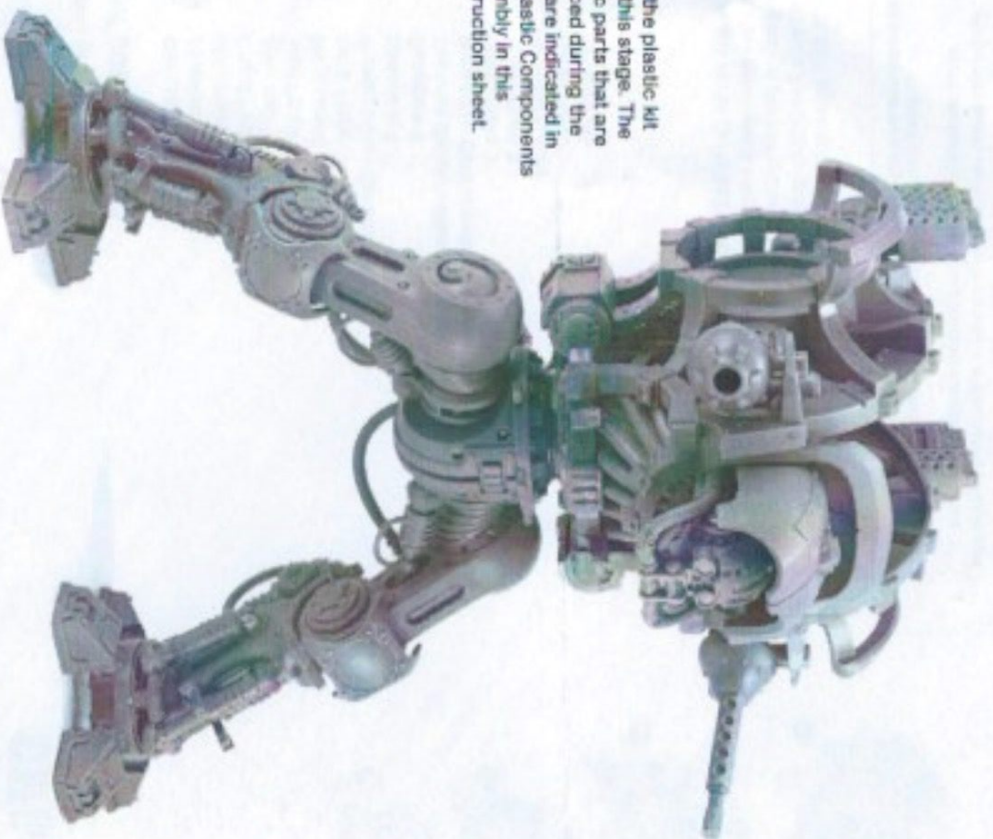

The Shin and Thigh plates may be mounted to either the left or the right sides of the Chaos Knight.

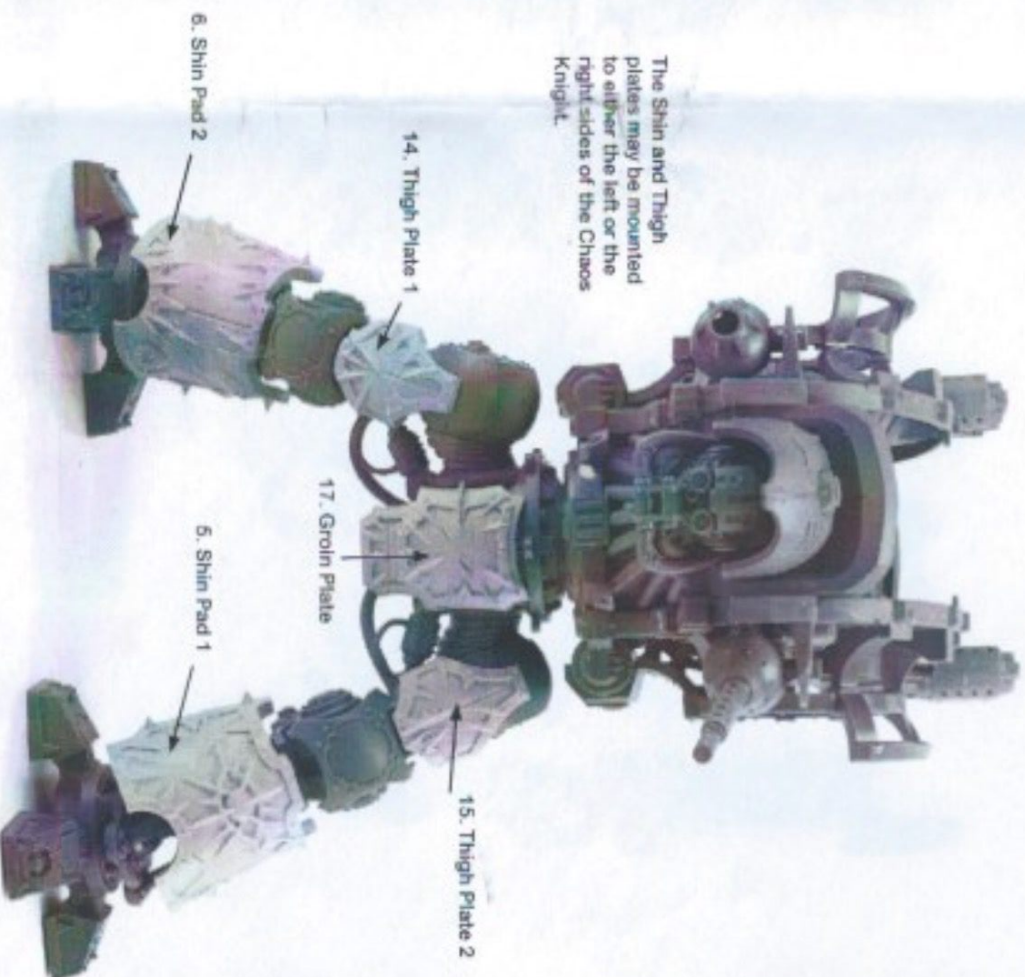

FORGE WORLD[®]

CHAOS KNIGHT

Attach the following plastic components to the Chainblade as shown.

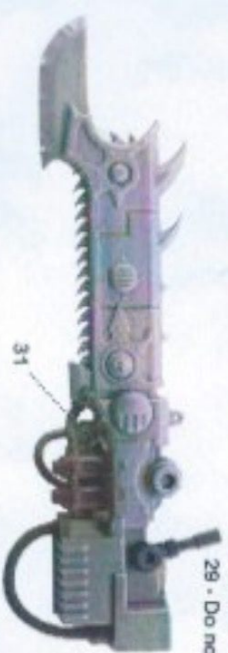

7. Pivot Cover for Chainblade

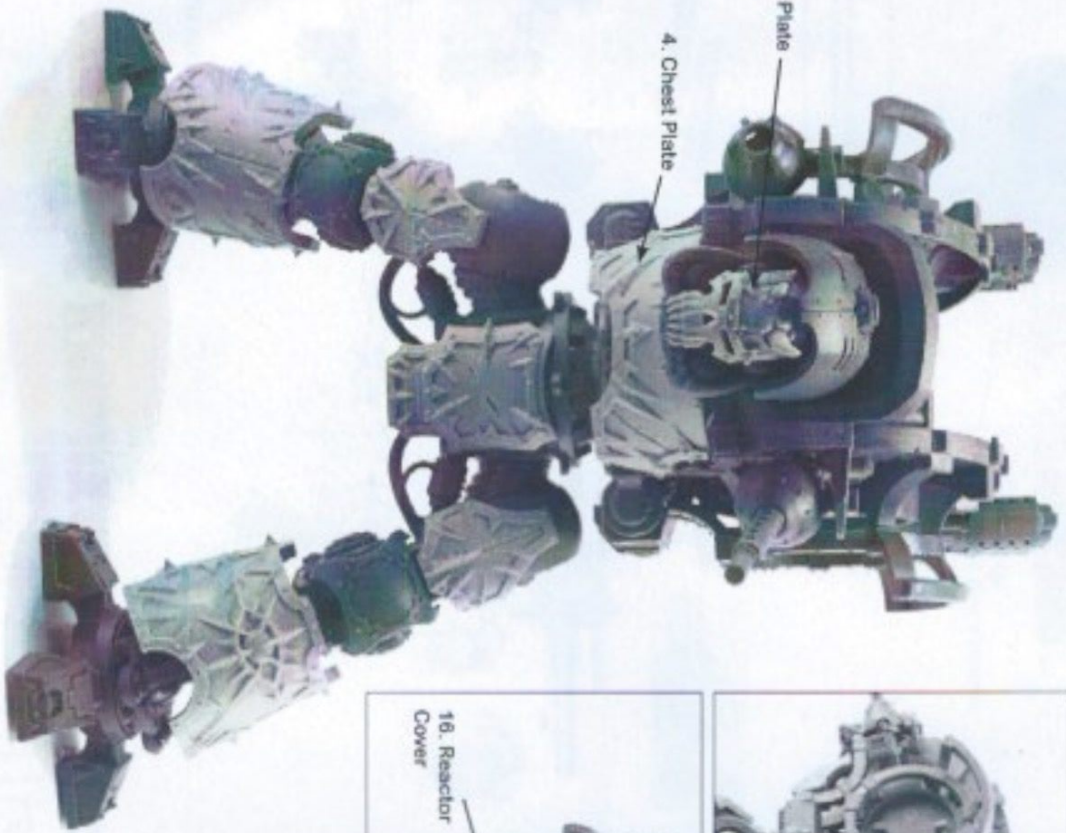

Forge World®

CHAOS KNIGHT - PLASTIC COMPONENTS ASSEMBLY GUIDE

RAPID-FIRE BATTLECANNON ASSEMBLY



Plastic parts 15 and 8 (indicated) are replaced by resin parts 15 and 8 respectively.



9. Weapon Counter Weight

THERMAL CANNON ASSEMBLY

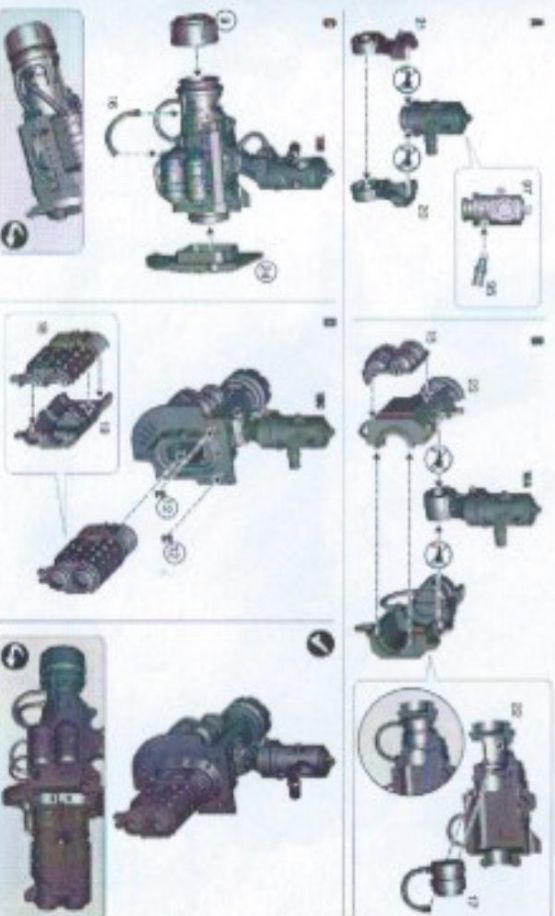

Plastic parts 36 and 8 (indicated) are replaced by resin parts 32 and 8 respectively.



9. Weapon Counter Weight

FORGE WORLD[®]

CHAOS KNIGHT

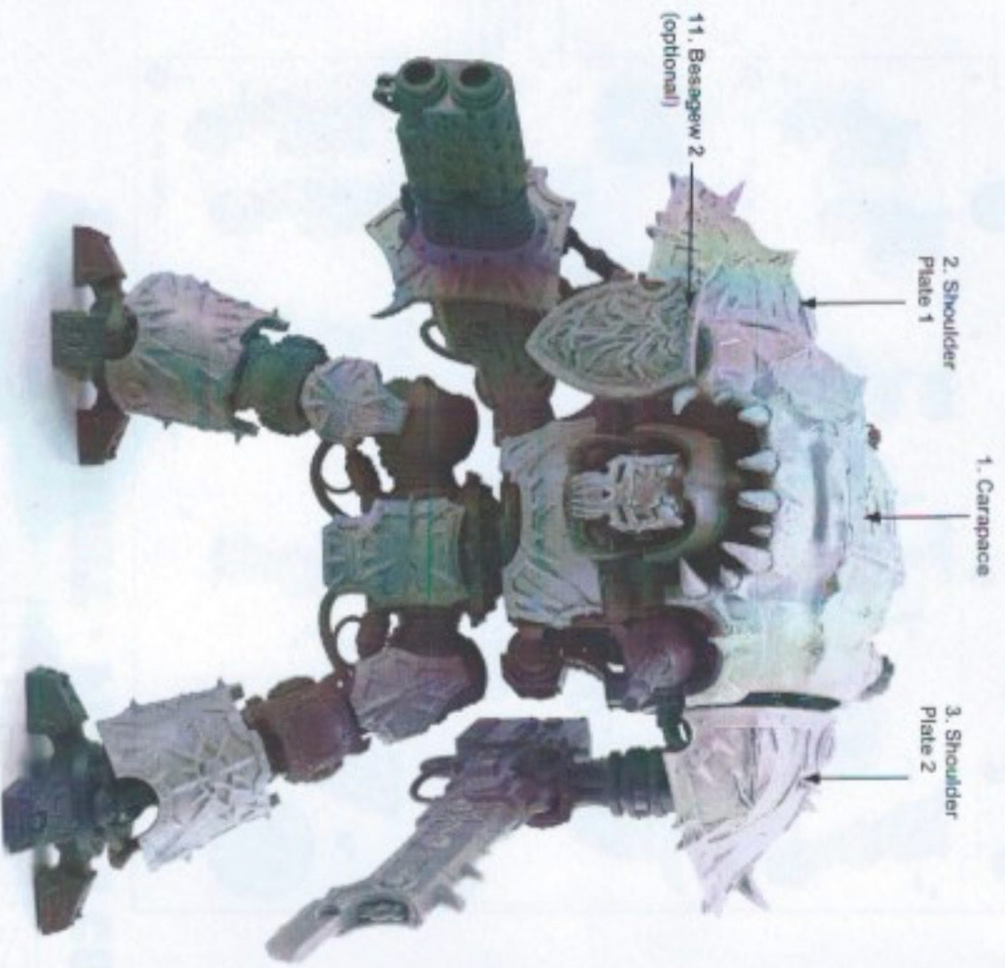

Chaos Knight armed with Thermal Cannon option

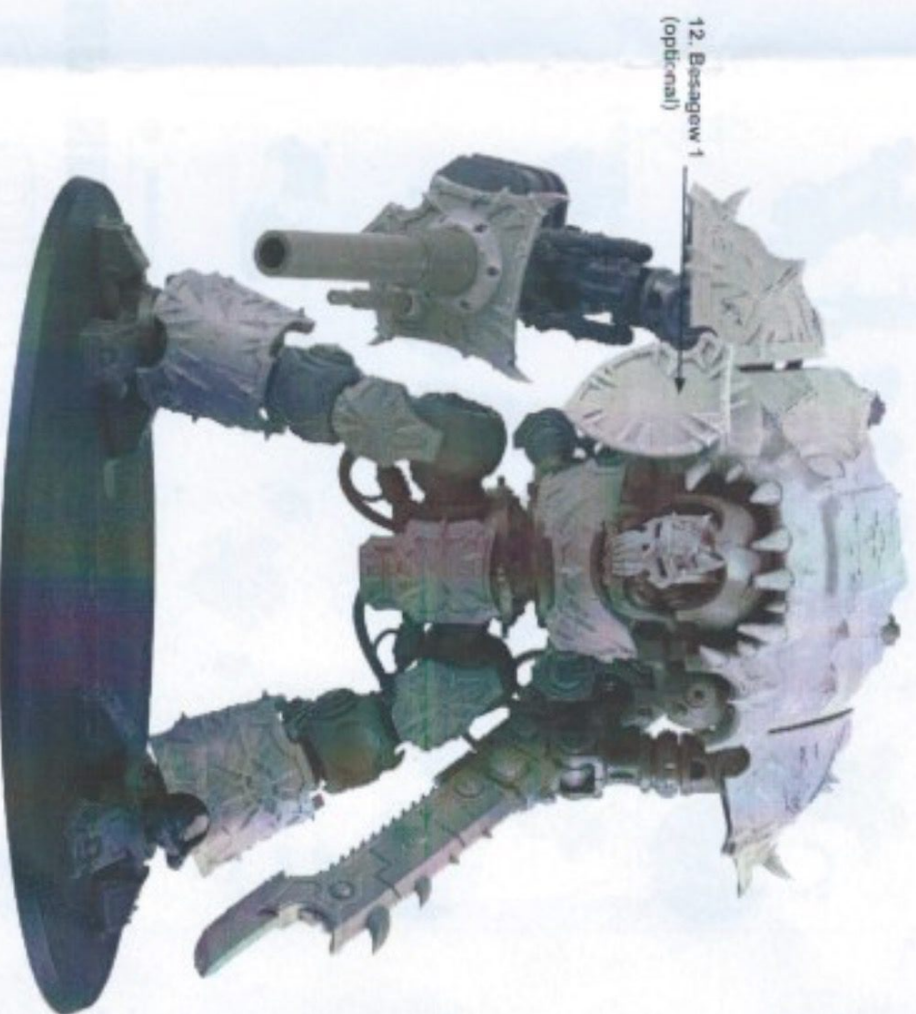

Chaos Knight armed with Rapid-fire Battlecannon option

CHAOS KNIGHT - PLASTIC COMPONENTS ASSEMBLY GUIDE

LEFT LEG ASSEMBLY

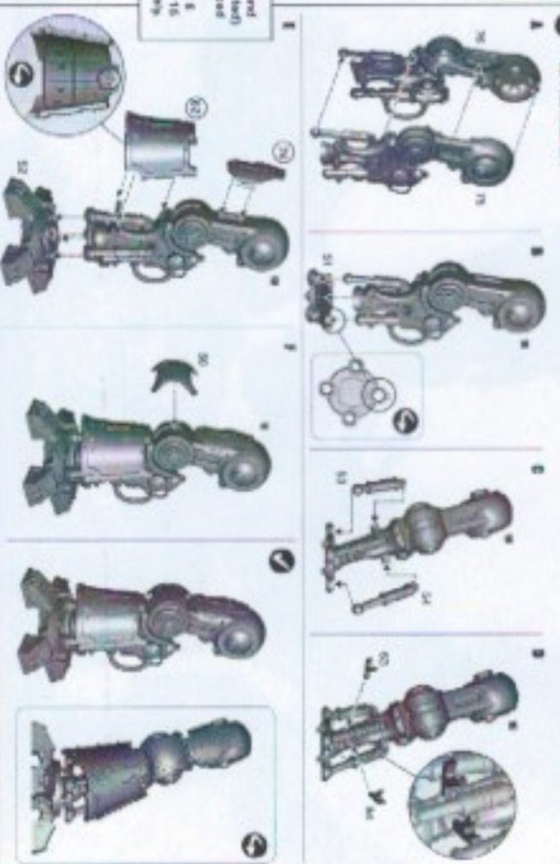

RIGHT LEG ASSEMBLY

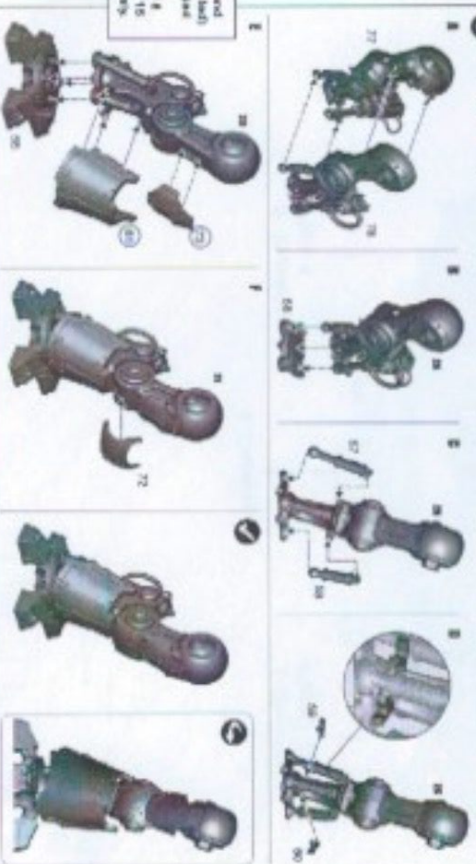

INNER BRACKETING



Part 35 (indicated) is replaced by resin part 17

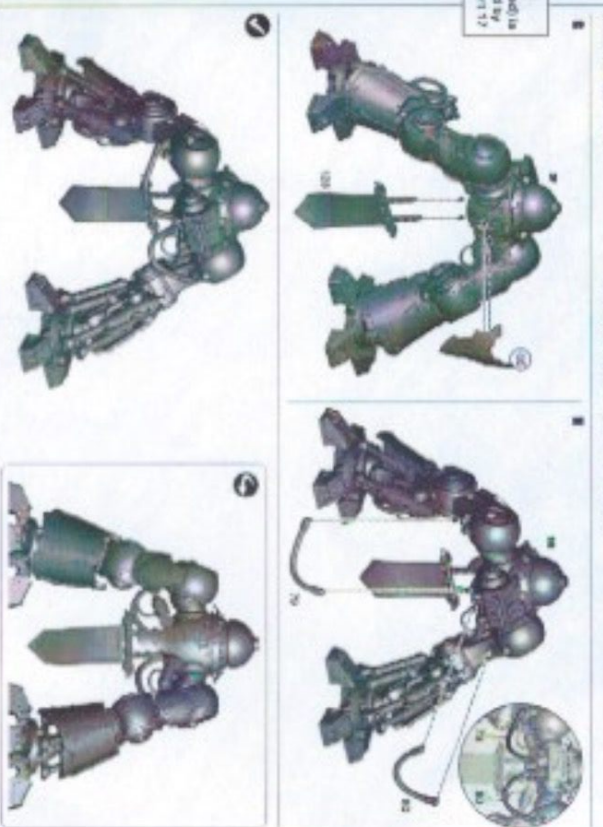

FORGE WORLDSM

CHAOS KNIGHT - PLASTIC COMPONENTS ASSEMBLY GUIDE

