

Free Downloads of Build Instructions,
Assembly Booklets & How To Guides

BuildInstructions.com

IMPERIAL™ ARMOUR

ELDAR LYNX WITH PULSAR ELDAR LYNX WITH SONIC LANCE

99590104051 / 99590104062

ELDAR LYNX W. PULSAR COMPONENTS LIST

1. Small Sensor Vane x2
2. Large Sensor Vane x2
3. Small Thruster x2
4. Large Thruster x2
5. Hull Base
6. Left Stabiliser Fin Rear
7. Left Stabiliser Fin Front
8. Left Hull
9. Left Support Torsion Bar
10. Shuriken Cannon
11. Pilot
12. Right Support Torsion Bar
13. Right Hull
14. Right Stabiliser Fin Rear
15. Right Stabiliser Fin Front
16. Pulsar Power Generator
17. Pulsar Barrel

Kit also includes
Plastic Canopy and large flying Base

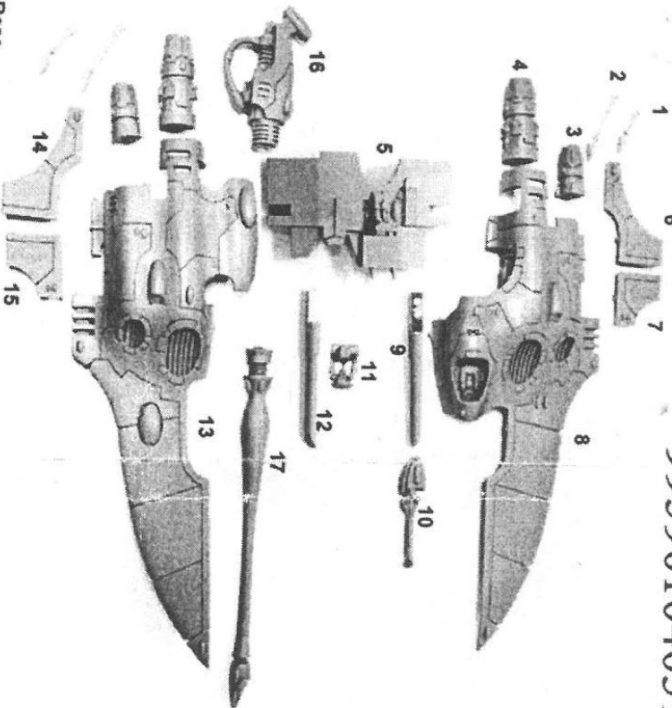

ELDAR LYNX W. SONIC LANCE COMPONENTS LIST

1. Small Sensor Vane x2
2. Large Sensor Vane x2
3. Small Thruster x2
4. Large Thruster x2
5. Hull Base
6. Left Stabiliser Fin Rear
7. Left Stabiliser Fin Front
8. Left Hull
9. Left Support Torsion Bar
10. Shuriken Cannon
11. Pilot
12. Right Support Torsion Bar
13. Right Hull
14. Right Stabiliser Fin Rear
15. Right Stabiliser Fin Front
16. Sonic Lance Vibro-Generator
17. Sonic Lance Barrel

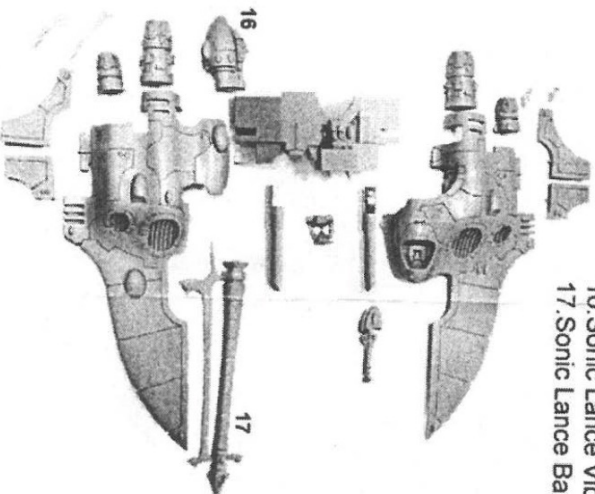

The copyright on the model designs and components within this box is the exclusive property of Games Workshop Ltd. Copyright Games Workshop Ltd., 2008. All rights reserved.

This kit contains all the pieces required to build the Eldar Lynx
To glue the resin pieces together and to plastic kit parts
use Citadel Super Glue.

NOTE: We have cast this kit using the most advanced techniques and the best quality resin, but due to the nature of the casting process your model may contain very slight air bubbles. These can easily be filled with model filler or super glue. Any slight warpage of thin parts can easily be corrected by immersing the part in hot tap water for about 1 minute then carefully bending it back into shape.

THIS IS NOT A TOY

Not suitable for children under 15 years of age.

WARNING: Resin dust can be harmful if inhaled. Always wear a dust mask or respirator when sanding or sawing resin parts.

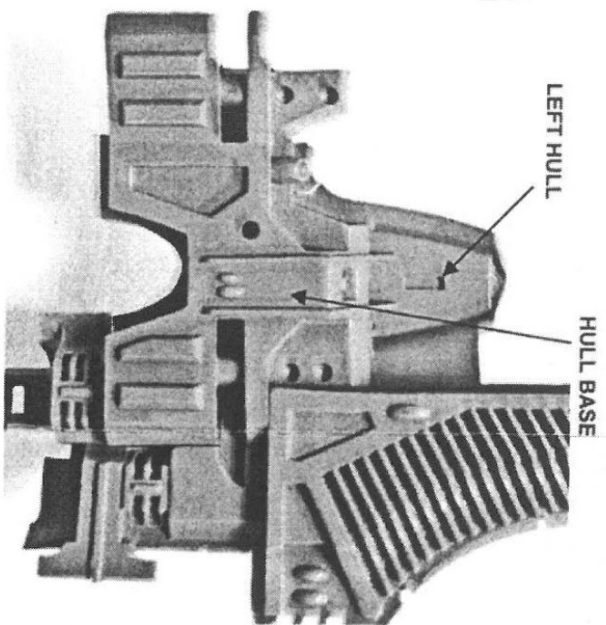

LEFT HULL

HULL BASE

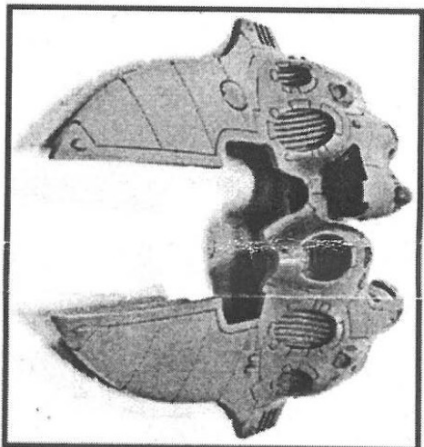

COMPLETED HULL CONSTRUCTION

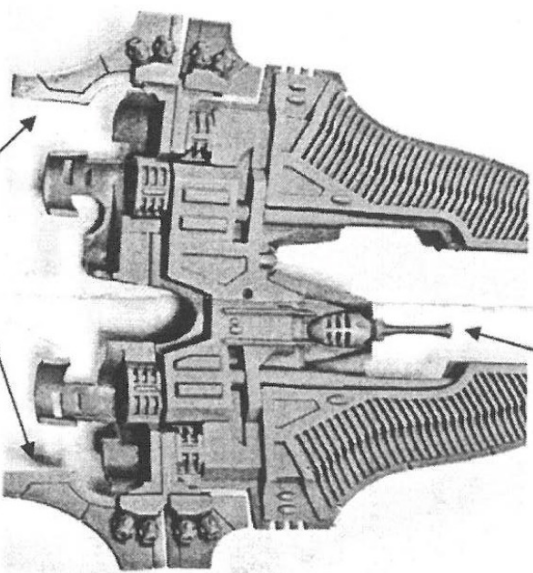

SHURIKEN CANNON

LEFT AND RIGHT STABILISER FINS

DETAIL OF COMPLETED ENGINE AND WEAPON POWER GENERATOR ASSEMBLY

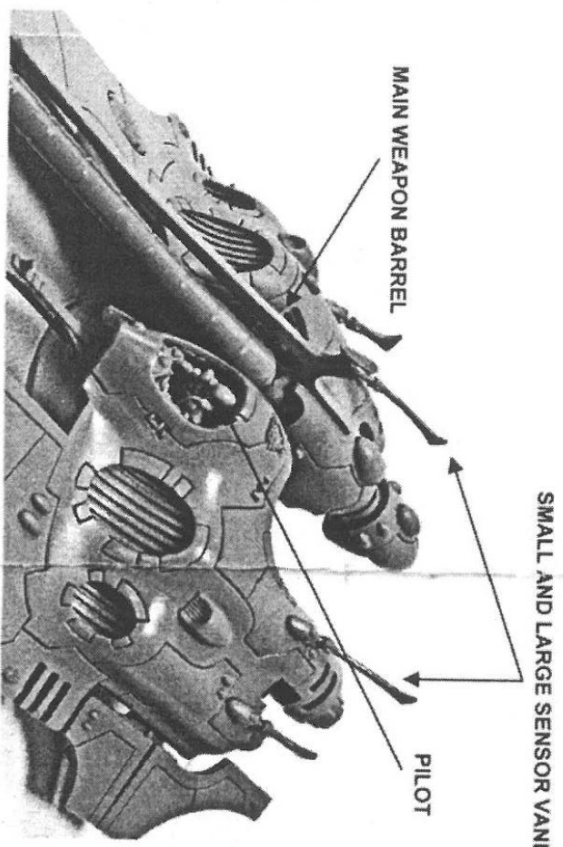
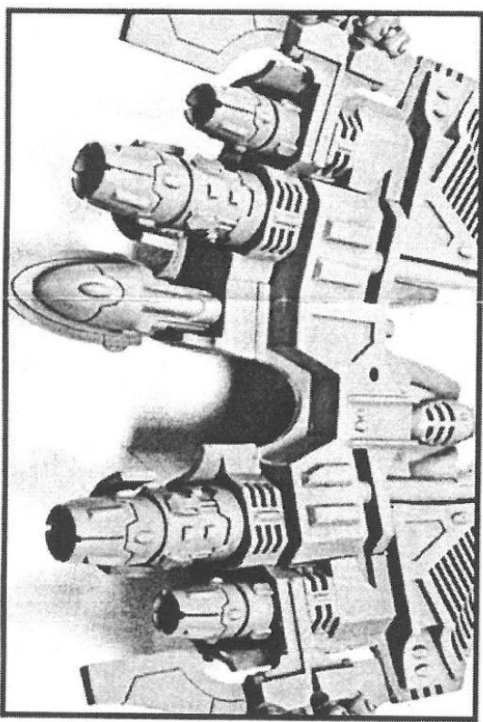

MAIN WEAPON BARREL

SMALL AND LARGE SENSOR VANES

PILOT