



Free Downloads of Build Instructions,
Assembly Booklets & How To Guides

BuildInstructions.com

15+

THE HORUS HERESY[®]



forgeworld.co.uk



Fabriqué au Royaume-Uni et distribué par :
Fabricado en el Reino Unido y
distribuido por:
Herstellt im Vereinigten Königreich und
vertrieben durch:
Prodotto nel Regno Unito e distribuito da:
製造国：イギリス 販売元：

Games Workshop Ltd.,
Willow Road, Lenton, Nottingham,
NG7 2WS, UK

Corax Components

- | | | |
|--------------------------|----------------------------|---------------------------------|
| 1. Side Engines x2 | 11. Left Lightning Claw | 21. Space Marine Chainsword |
| 2. Backpack Intakes | 12. Corax Body | 22. Space Marine Body |
| 3. Left Wing | 13. Pistol | 23. Space Marine Torso Plate |
| 4. Right Wing | 14. Right Hand | 24. Bolt Pistol |
| 5. Central Engine | 15. Whip and Holster | 25. Scenic Base Column |
| 6. Backpack | 16. Raven Skull Plate | 26. Scenic Base Rear |
| 7. Corax Head | 17. Holstered Pistol | 27. Scenic Base Column Platform |
| 8. Right Shoulder | 18. Space Marine Backpack | 28. Scenic Base Main |
| 9. Left Shoulder | 19. Space Marine Right Arm | 29. Scenic Base Front |
| 10. Right Lightning Claw | 20. Space Marine Left Arm | |

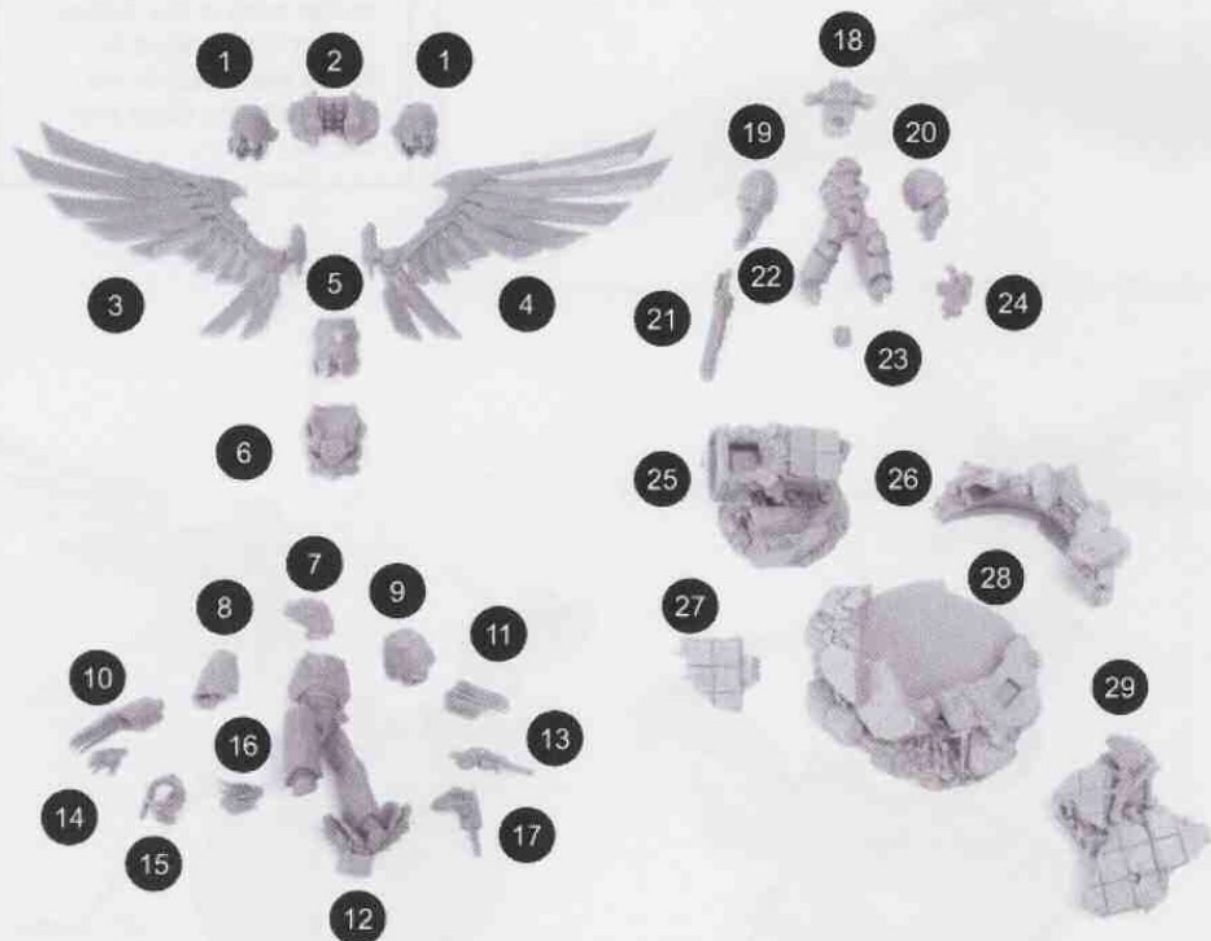

THE HORUS HERESY[®]

THIS IS NOT A TOY

Not suitable for children under 15 years of age.

WARNING: Resin dust can be harmful if inhaled. Always wear a dust mask or respirator when sanding or sawing resin parts.



Please retain packaging for future reference.
Veuillez conserver cet emballage pour référence.
Conserve esta caja para cualquier referencia.
Verpackung bitte zur späteren Referenz aufbewahren.
Conserva la confezione per riferimenti futuri.
パッケージは、将来の参考のためにお取り置き
ください。

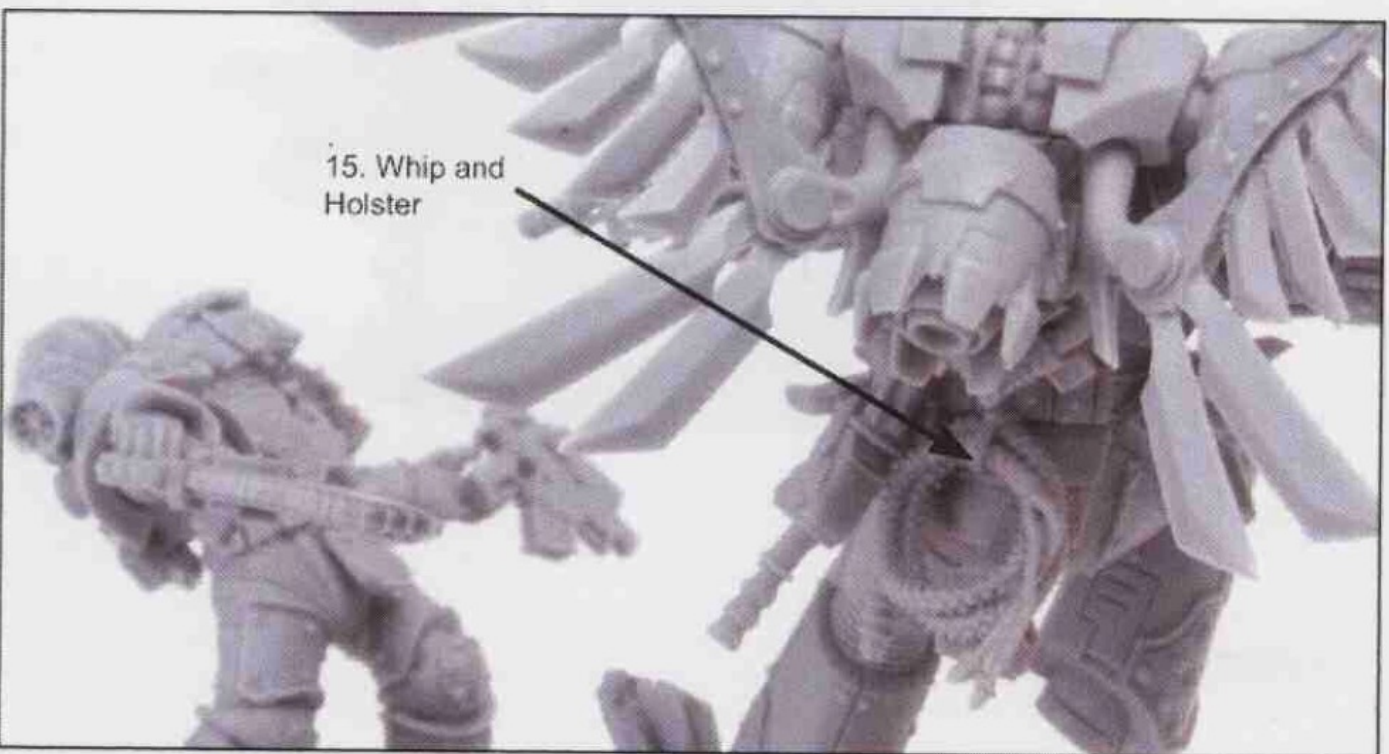
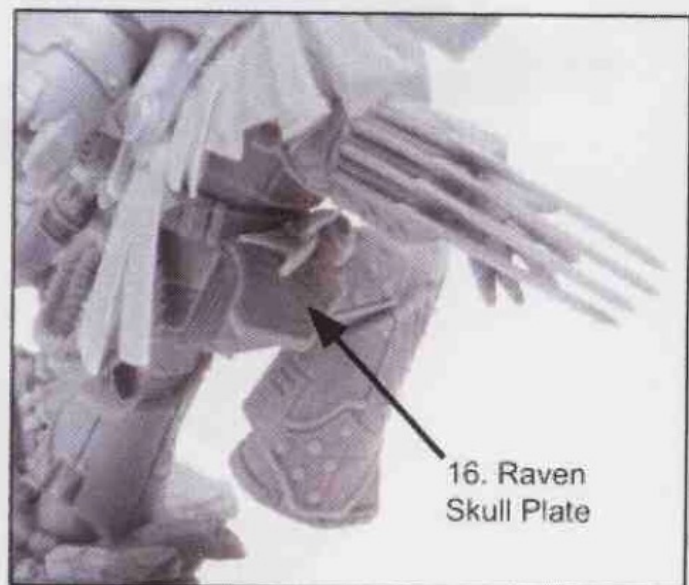
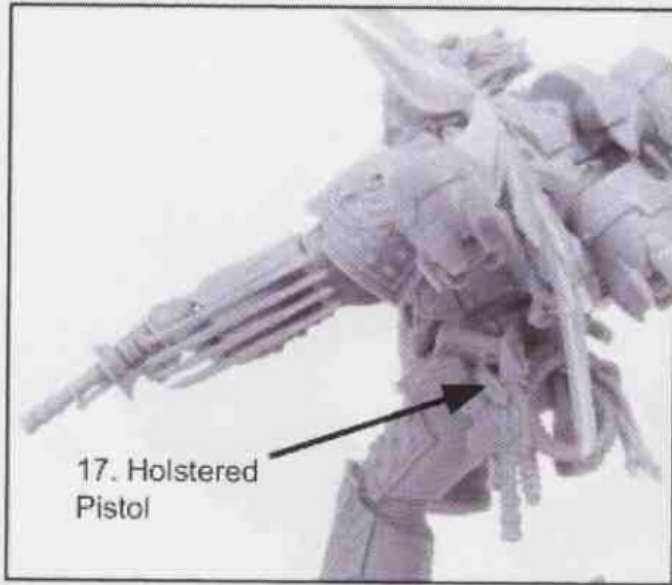
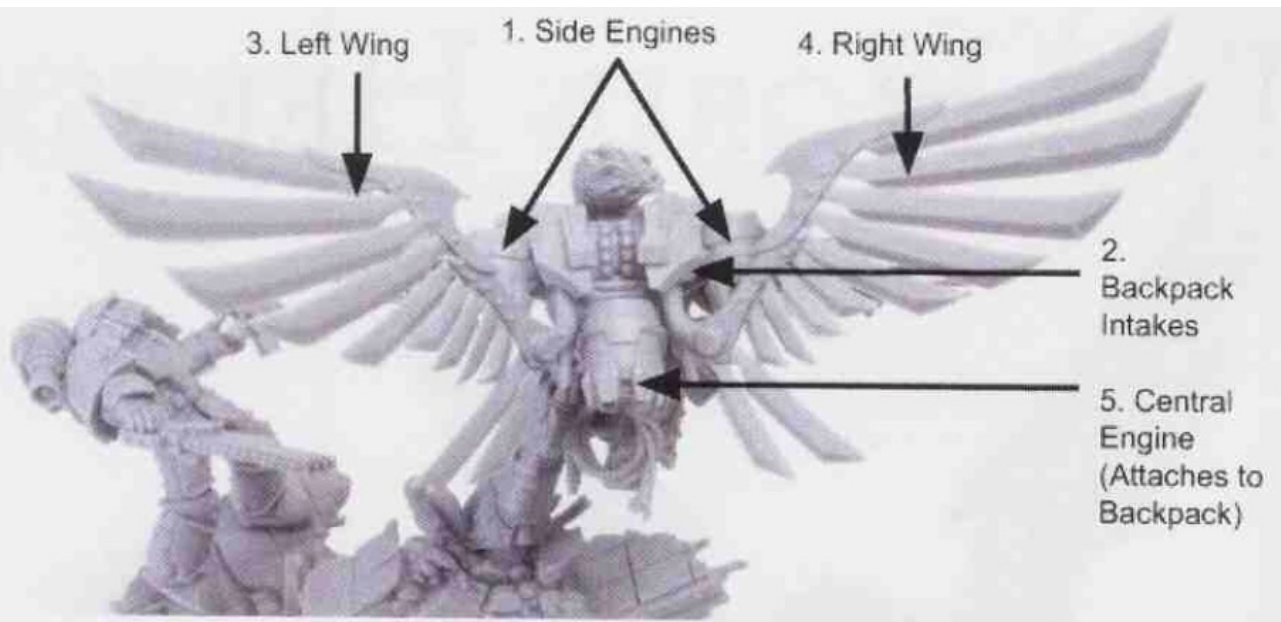

21. Space Marine Chainsword

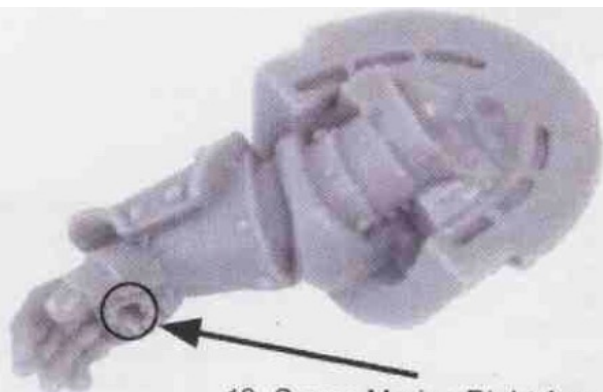
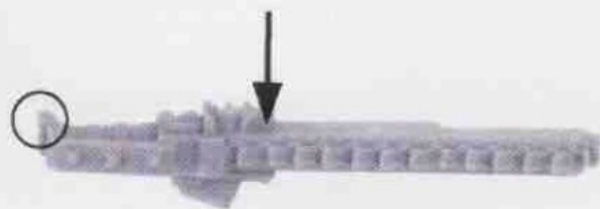

19. Space Marine Right Arm



A small plug is included on the base of the Space Marine Chainsword to fit into the socket in the Space Marine Right Arm Socket.

25. Scenic Base Column



28. Scenic Base Main

29. Scenic Base Front



27. Scenic Base Column Platform

26. Scenic Base Rear

Attach the Scenic Base Column to the 40mm plastic base. The Scenic Base Main then attaches to the 60mm base. If you want the 40mm base to be removable for gaming purposes, do not glue the Scenic Base Column or the Scenic Base Rear into place.