

Free Downloads of Build Instructions,
Assembly Booklets & How To Guides

BuildInstructions.com

BLOOD ANGELS LEGION DAWNBREAKER COHORT

Chosen from amongst the most experienced and daring of the Legion's Assault squads, the Dawnbreakers are trained and equipped to act as the tip of the Blood Angels' spear, the first warriors to set foot on those benighted worlds that the Legion is called upon to save. The Dawnbreakers have one purpose in battle, to sunder the enemy's lines and tear the heart from its formation.



THIS IS NOT A TOY

Not suitable for children under 15 years of age.

WARNING: Resin dust can be harmful if inhaled. Always wear a dust mask or respirator when sanding or sawing resin parts.

Forge World



993201010933



Resin Components

Before assembly, check that none of the components are missing.

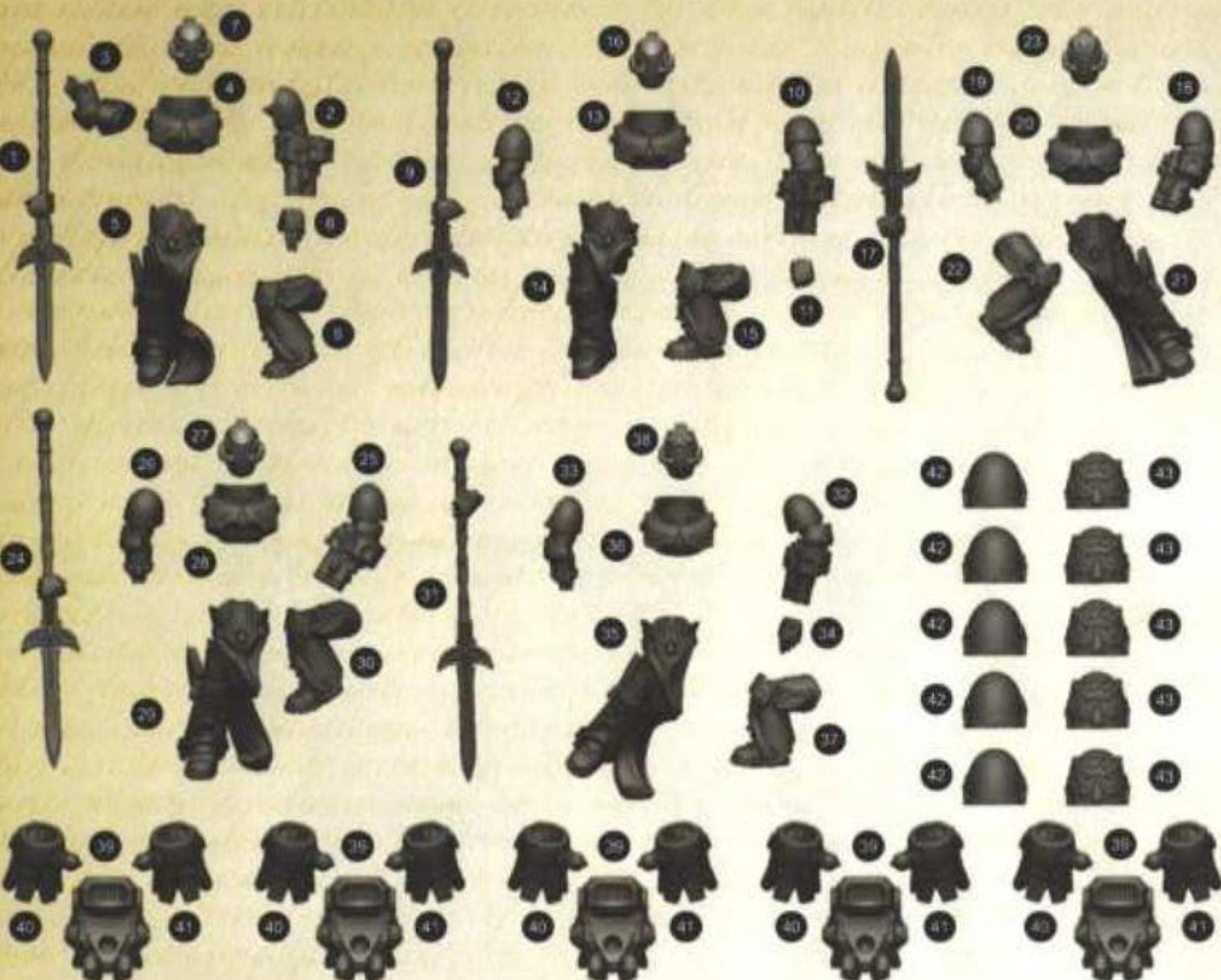

This set also includes five 32mm round bases.

- | | | | |
|------------------|-------------------|-------------------|---------------------------|
| 1. Power Spear A | 13. Torso B | 25. Left Arm D | 37. Left Leg E |
| 2. Left Arm A | 14. Right Leg B | 26. Right Arm D | 38. Head E |
| 3. Right Arm A | 15. Left Leg B | 27. Head D | 39. Jet Pack x5 |
| 4. Torso A | 16. Head B | 28. Torso D | 40. Right Turbine x5 |
| 5. Right Leg A | 17. Power Spear C | 29. Right Leg D | 41. Left Turbine x5 |
| 6. Left Hand A | 18. Left Arm C | 30. Left Leg D | 42. Right Shoulder Pad x5 |
| 7. Head A | 19. Right Arm C | 31. Power Spear E | 43. Left Shoulder Pad x5 |
| 8. Left Leg A | 20. Torso C | 32. Left Arm E | |
| 9. Power Spear B | 21. Left Leg C | 33. Right Arm E | |
| 10. Left Arm B | 22. Right Leg C | 34. Left Hand E | |
| 11. Left Hand B | 23. Head C | 35. Right Leg E | |
| 12. Right Arm B | 24. Power Spear D | 36. Torso E | |

If you need to contact the Forge World Customer Service team regarding this model, you can get in touch via email – forgeworld@gwplc.com – or call:

0115 900 4995 within the UK

011 44 115 900 4995 from the USA and Canada

0011 44 115 900 4995 from Australia

00 44 115 900 4995 from Europe and the rest of the world.

Preparing a Model for Assembly

Before assembling a model, wash each part thoroughly with an abrasive brush, such as a toothbrush, to remove any model release agent that may still be on the surface of the parts. Then, remove any excess resin such as mould lines, casting gates, vents and shims.

For a more detailed guide to working with resin models, go to the Downloads section of the Forge World website.

This kit contains all of the pieces required to construct a unit of five Blood Angels Legion Dawnbreakers. To glue the resin pieces together use Citadel Super Glue.

NOTE: We have cast this kit using advanced techniques and the best quality resin, but due to the nature of the casting process, your model may contain small air bubbles. These can be filled with model filler or super glue. Any slight warpage of thin parts can easily be corrected by immersing the part in hot tap water for about 1 minute, then carefully bending it back into shape.

Model A

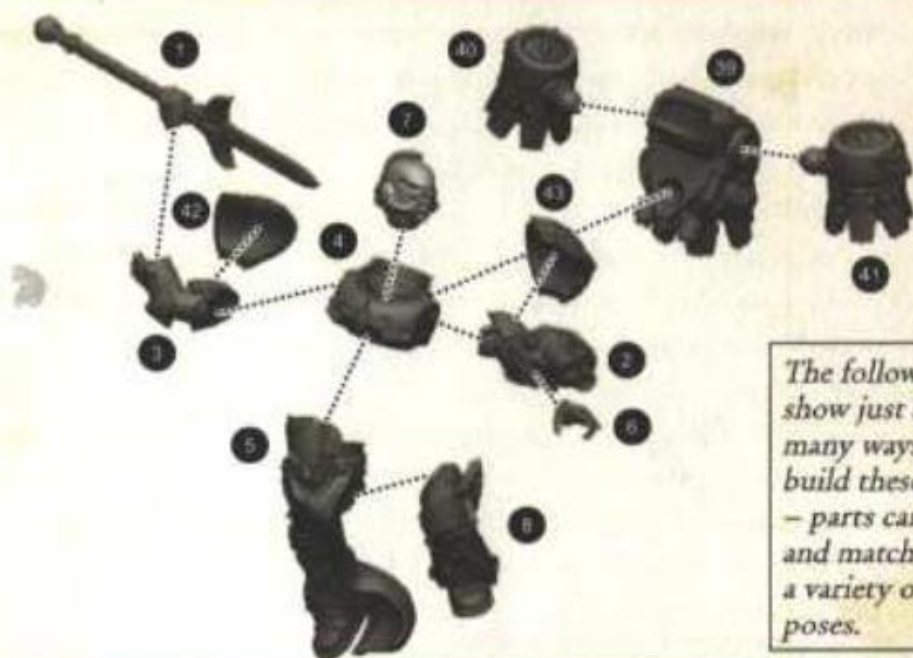

The following images show just some of the many ways you can build these models – parts can be mixed and matched to create a variety of different poses.

Model B

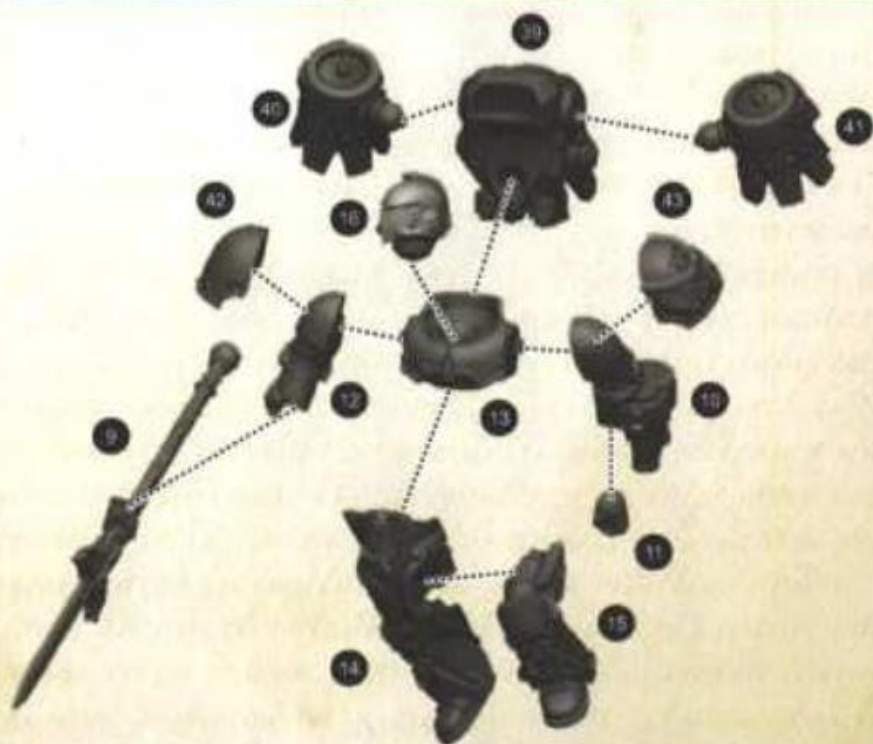

Model C

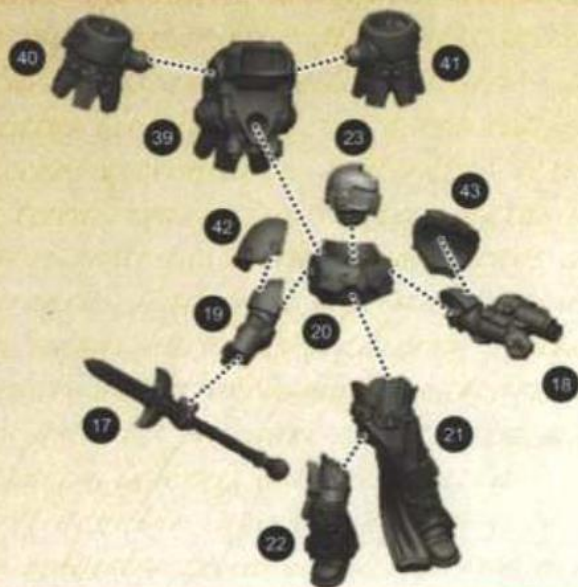

Model D

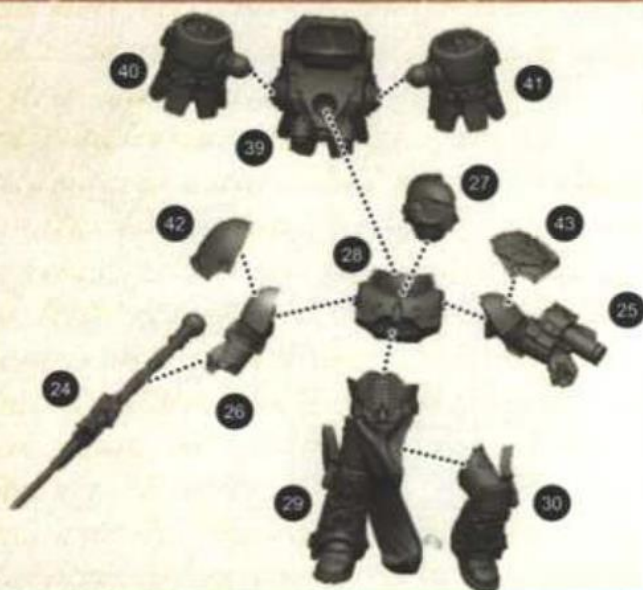

Model E

