



Free Downloads of Build Instructions,
Assembly Booklets & How To Guides

BuildInstructions.com

IMPERIAL™ ARMOUR

ARMAGEDDON PATTERN MEDUSA

Product code : IA-GUA-T-044

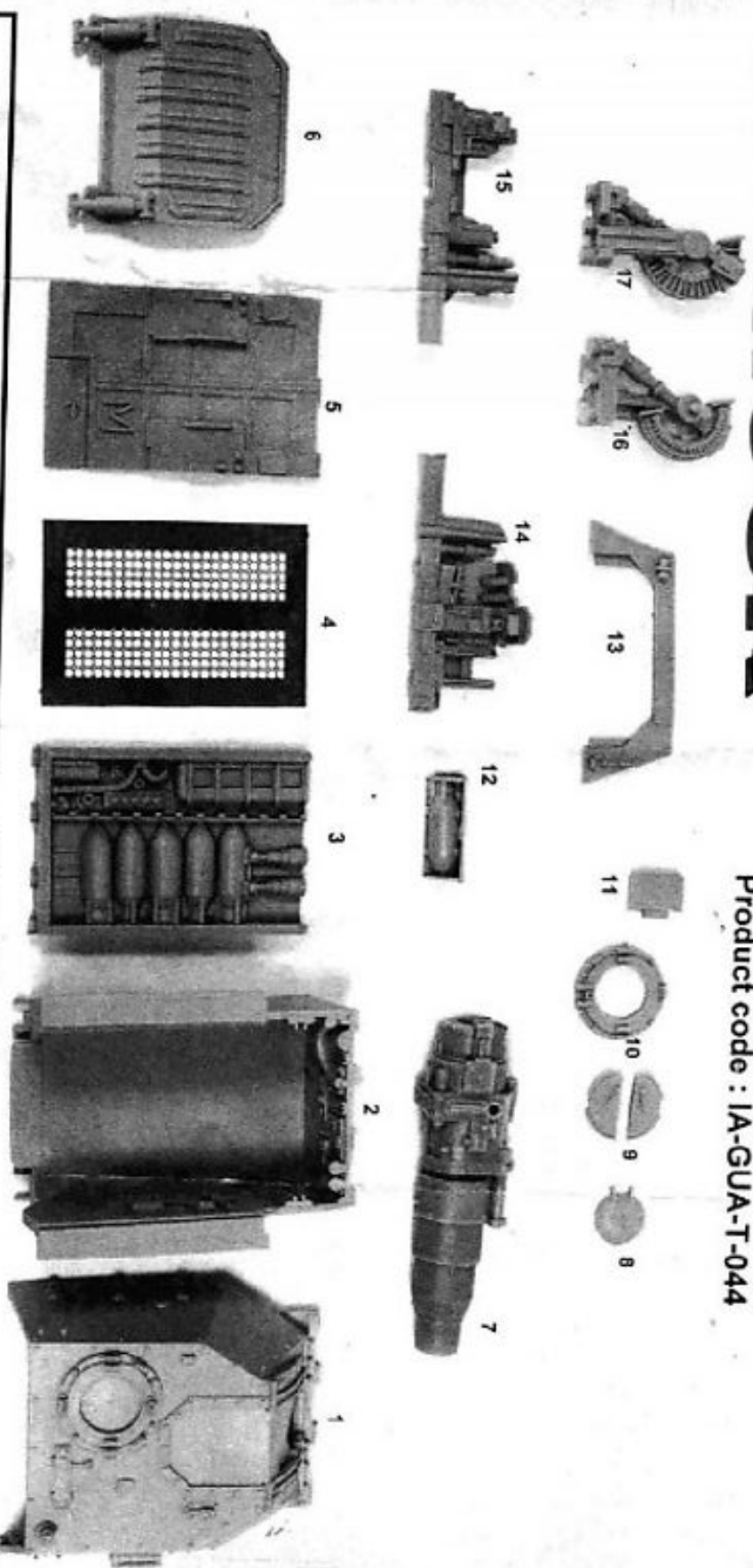

RESIN COMPONENTS LIST

1. ARMOURD HULL TOP
2. ARMOURD HULL BOTTOM
3. AMMUNITION STORAGE
4. GRATE
5. FLOOR (remove shaded area)
6. REAR DOOR
7. MEDUSA SEIGE GUN
8. BREECH DOOR
9. HATCH DOORS (x2 sets)
10. HATCH
11. COMMANDERS SEAT
12. OPEN AMMUNITION HATCH
13. ARMOURD HULL REAR
14. INTERIOR RIGHT PANEL
15. INTERIOR LEFT PANEL
16. LEFT GUN MOUNT
17. RIGHT GUN MOUNT

This kit contains all the pieces required to convert the Basilisk plastic kit to the Armageddon Pattern Medusa.
To glue the resin pieces either together or to plastic components use Citadel Super Glue.

NOTE: We have cast this conversion kit using the most advanced techniques and the best quality resin, but due to the nature of the casting process your model may contain very slight air bubbles. These can easily be fixed with model filler or super glue. Any slight warpage of the parts can easily be corrected by sanding the part in the top section for about 3 minutes then carefully casting a fresh into shape.

THIS IS NOT A TOY

Not suitable for children under 5 years of age.

WARNING: Resin dust can be harmful if inhaled. Always wear a dust mask or respirator when sanding or sawing resin parts.

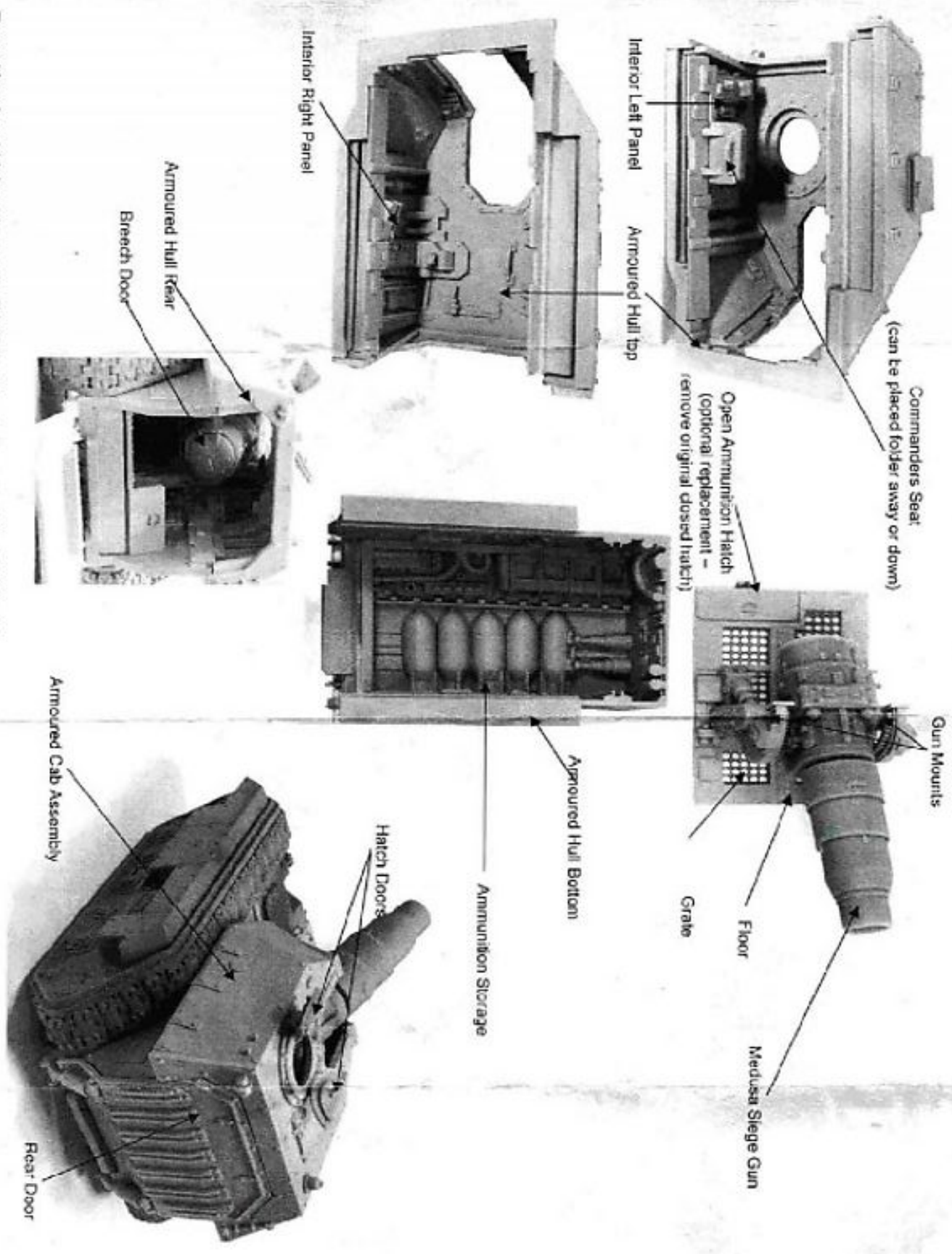

Commanders Seat
(can be placed further away or down)

Open Ammunition Hatch
(optional replacement -
remove original closed hatch)

Gun Mounts

Medusa Siege Gun

Floor

Grate

Interior Left Panel

Armoured Hull top

Interior Right Panel

Armoured Hull Rear

Breach Door

Armoured Hull Bottom

Ammunition Storage

Hatch Doors

Armoured Cab Assembly

Rear Door