



Free Downloads of Build Instructions,
Assembly Booklets & How To Guides

[**BuildInstructions.com**](https://www.buildinstructions.com)

10 - 16 STARWEAVER & VOIDWEAVER

! Follow steps 10 & 11 for all variants • Suivre les étapes 10 & 11 pour tous les variantes • Sigue los pasos 10 y 11 para todas las versiones • Folge den Schritten 10 & 11 für alle Varianten • Segui le fasi 10 e 11 per tutte le varianti

10 a

x2

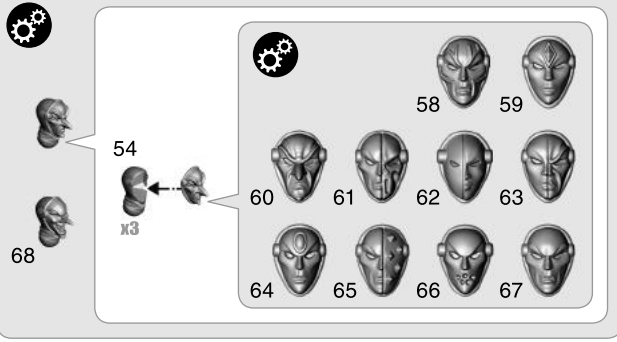
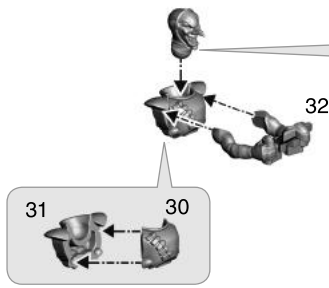

10 b

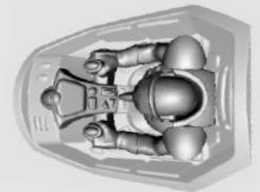
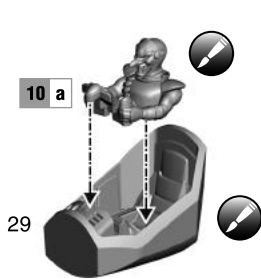

11 a

x2

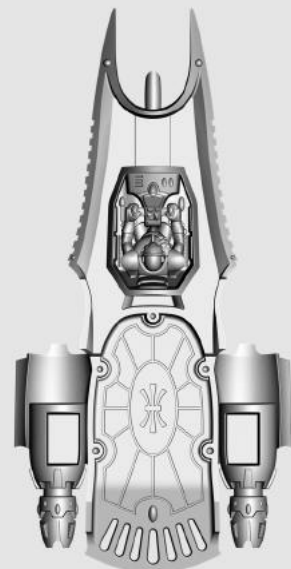
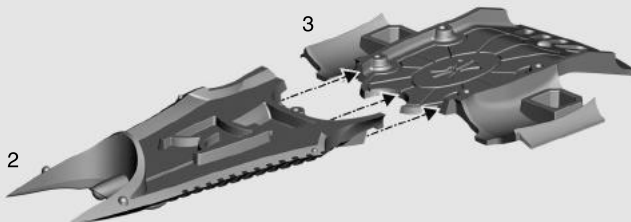
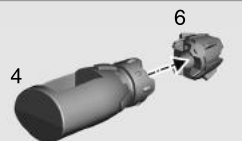
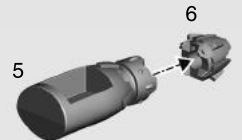
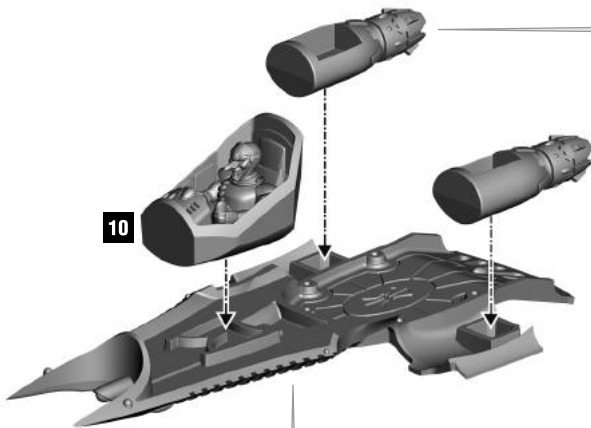

11 b

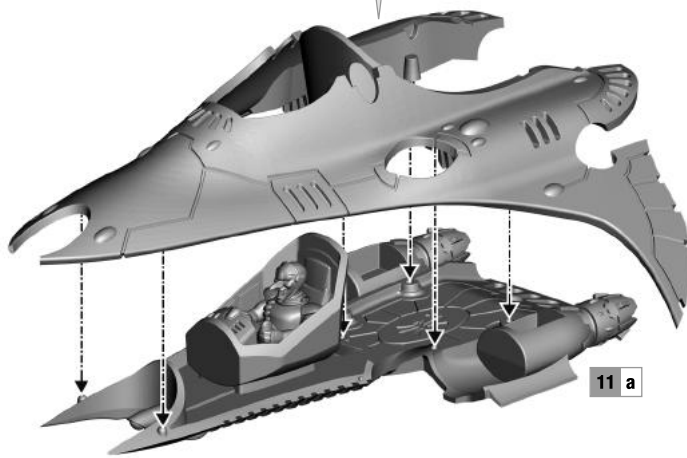
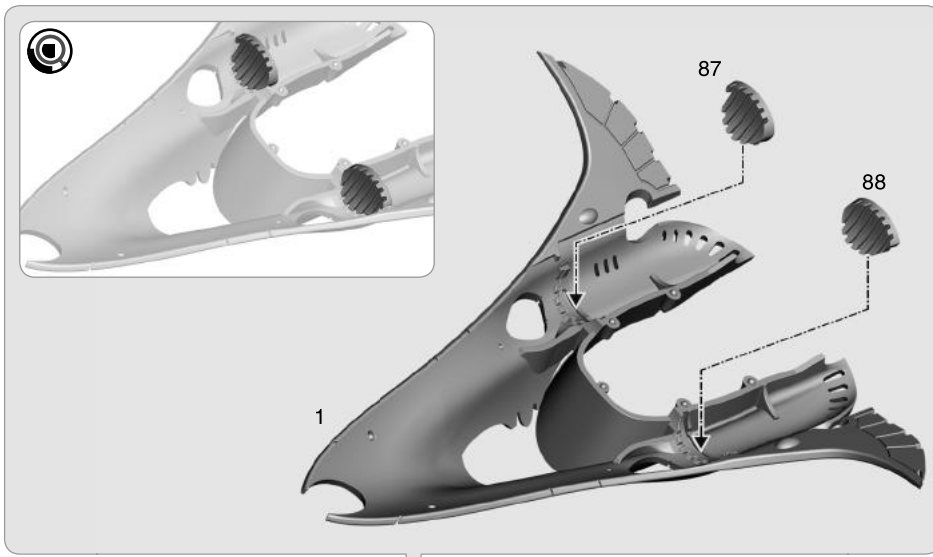

11 c

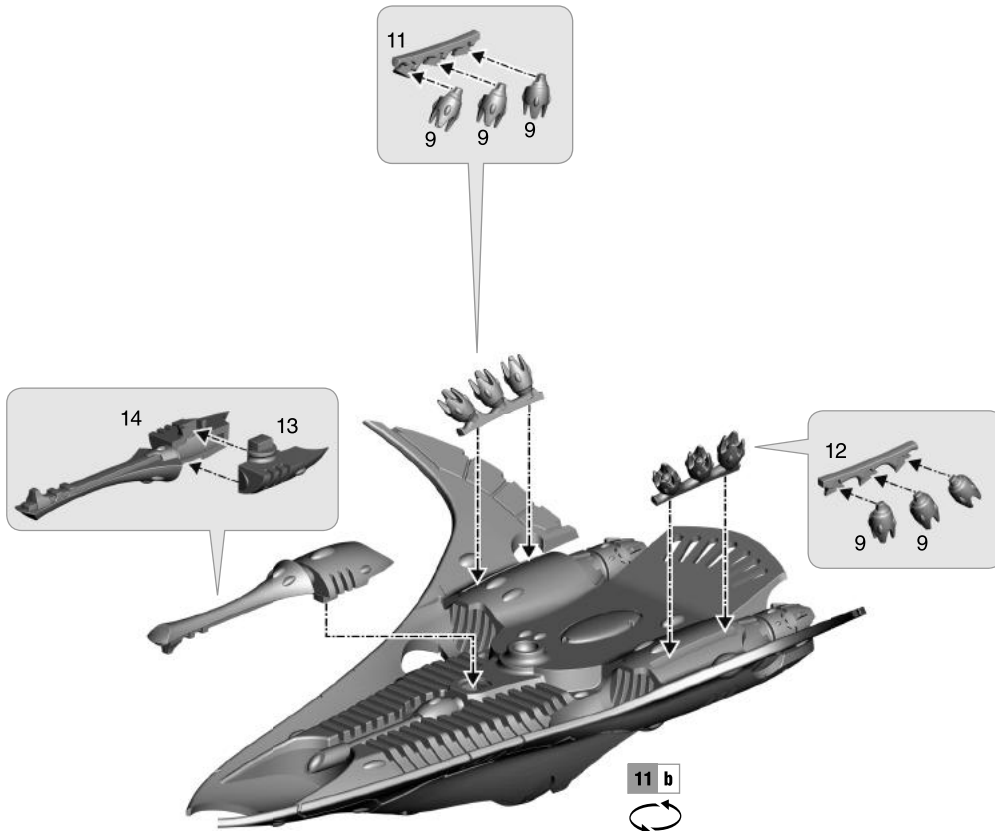

11 d

11 c

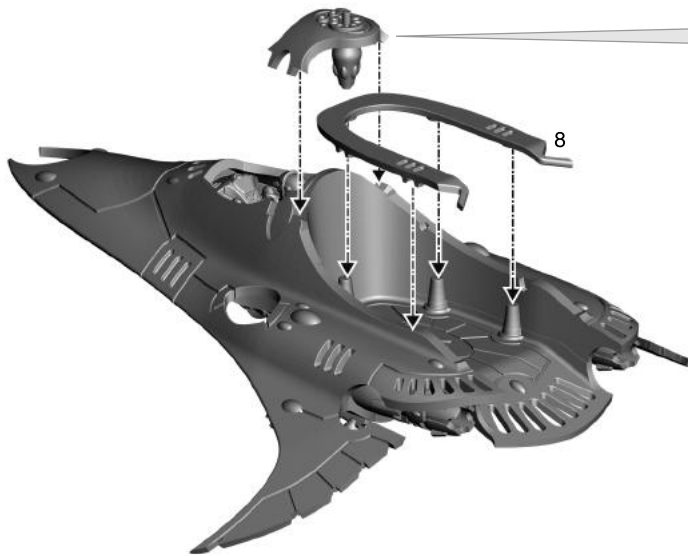

11 e



11 d

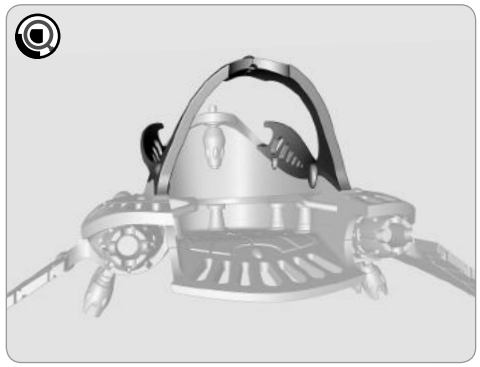
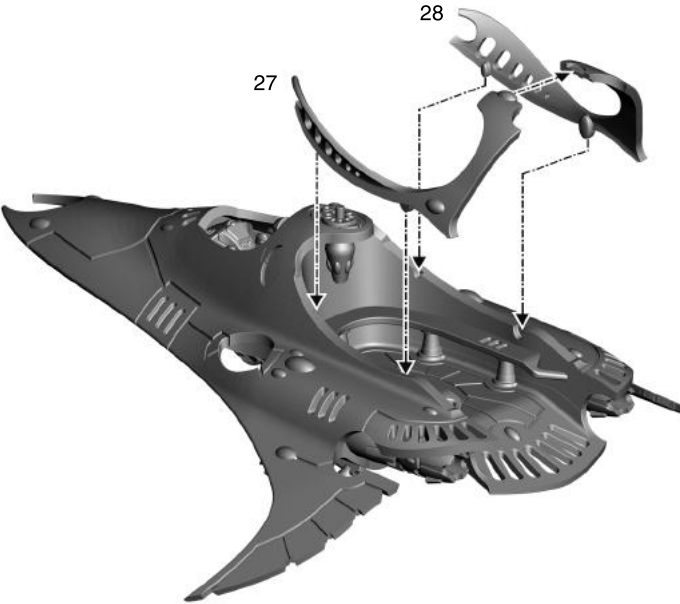

11 f



11 e

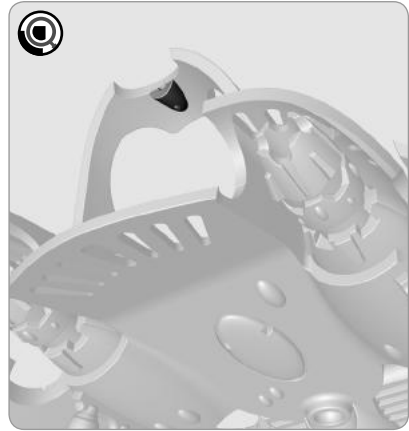

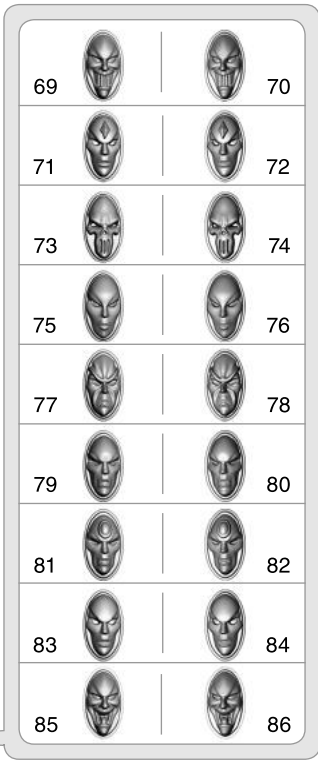

Hull masks are designed to apply as a pair. However, the left and right masks are not interchangeable.

Ces masques sont conçus pour être utilisés par paire, mais les masques droits et gauches ne sont pas interchangeables.

Las máscaras se utilizan por parejas, pero las del lado izquierdo y el derecho no son intercambiables.

Die Ziermasken sind paarweise gestaltet. Die rechten und linken Masken sind jedoch nicht austauschbar.

Le maschere dello scafo sono ideate per essere applicate in coppia. Tuttavia, le maschere di destra e di sinistra non sono intercambiabili.

11 f

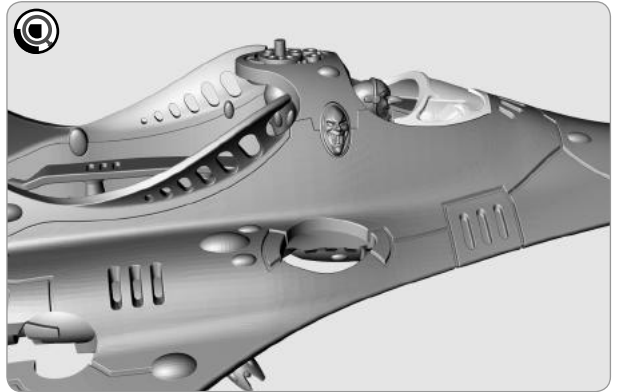
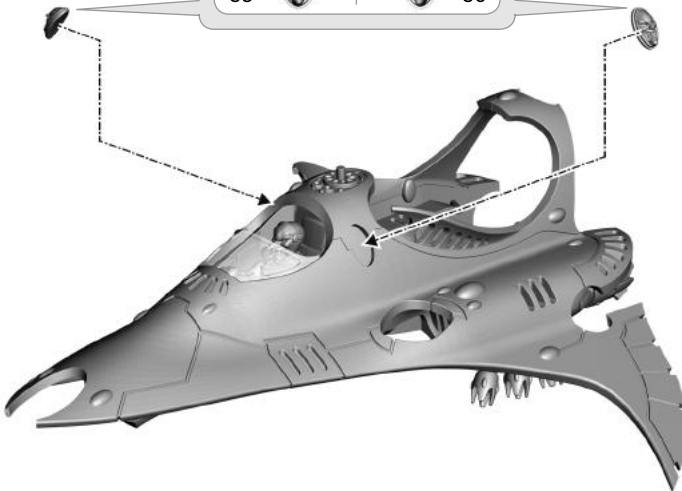

15 a

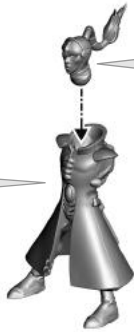
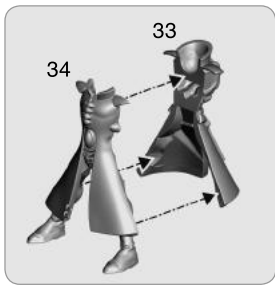

68 55

54 x3

56 57

58 59 60 61 62

63 64 65 66 67

15 b

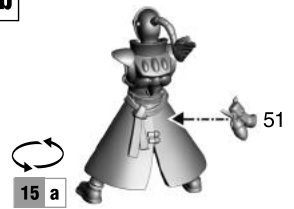

16 a

