



Free Downloads of Build Instructions,
Assembly Booklets & How To Guides

BuildInstructions.com

IMPERIAL™ ARMOUR

DEIMOS PATTERN PREDATOR EXECUTIONER

99590101249

DEIMOS PATTERN PREDATOR EXECUTIONER RESIN COMPONENTS LIST

1. Thick Hatch
2. Thin Hatch
3. Turret Hatch
4. Sponson Turret x2
5. Gun Shield x2
6. Sponson Retaining Plate x2
7. Heavy Bolter Ammo x2
8. Lascannon Lower Pivots x2
9. Heavy Bolter Lower Pivot x2
10. Lascannon Power Cables x2
11. Sponson Targeter x2
12. Heat Sinks
13. Beam Generator
14. Projector Array
15. Front Plate
16. Turret
17. Turret Ring
18. Plasma Executioner
19. Lascannon x2
20. Heavy Bolter x2
21. Right Hull
22. Left Hull
23. Sponson Ring x2
24. Power Generator
25. Ram
26. Exhausts x4

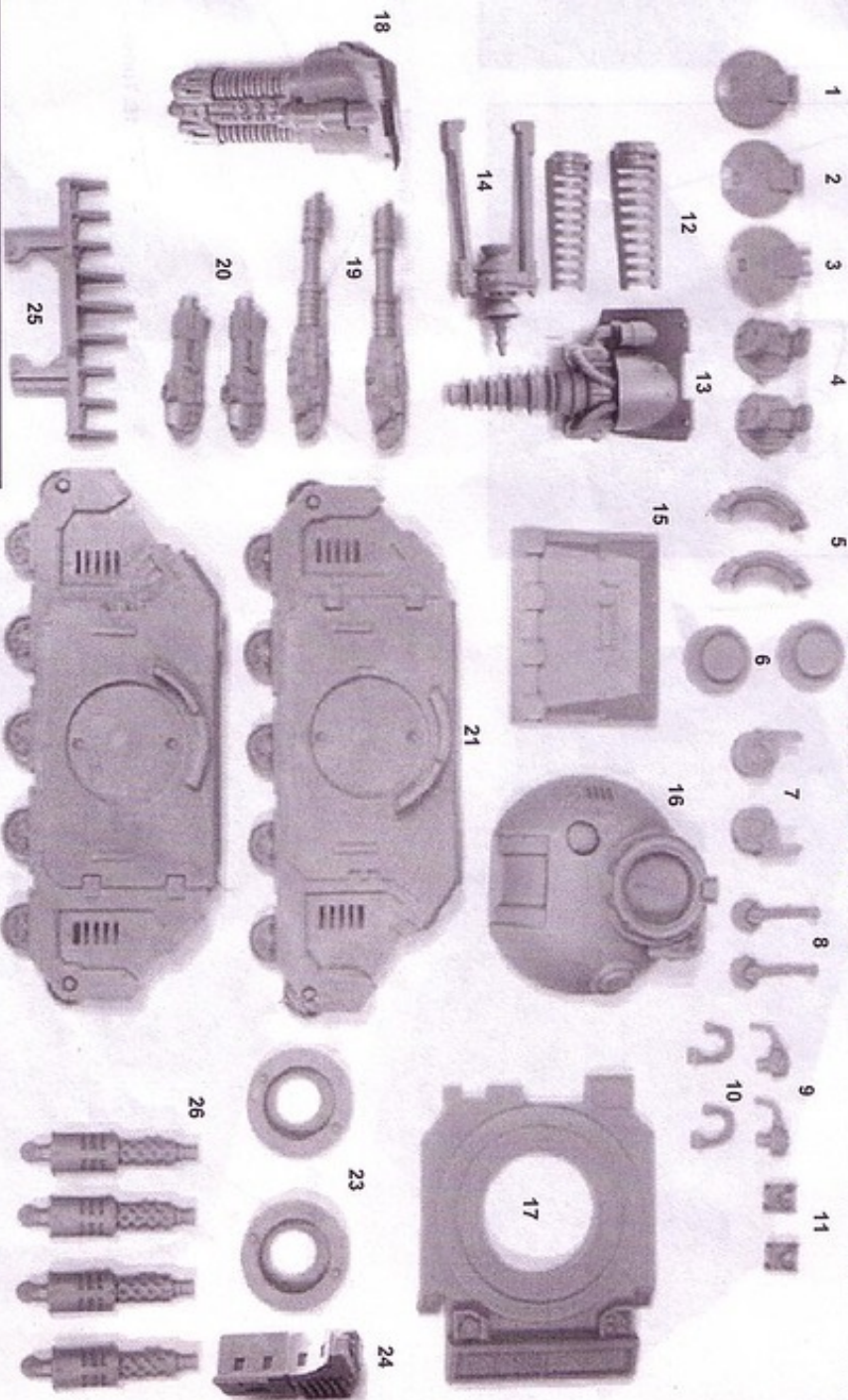

This kit contains all the pieces required to build the Deimos Pattern Predator Executioner
To glue the resin pieces together and to plastic kit parts
use Citadel Super Glue.

NOTE: We have cast this kit using the most advanced techniques
and the best quality resin, but due to the nature of the casting process your
model may contain very slight air bubbles. These can easily be filled with
model filler or super glue. Any slight warpage of thin parts can easily be
corrected by immersing the part in hot tap water for about 1 minute then
carefully bending it back into shape.

THIS IS NOT A TOY

Not suitable for children under 15 years of age.

WARNING: Resin dust can be harmful if inhaled. Always wear a dust
mask or respirator when sanding or sawing resin parts.

The copyright on the model designs and components within
this box is the exclusive property of Games Workshop Ltd.
Copyright Games Workshop Ltd, 2012. All rights reserved.

Build the Plastic Rhino kit up to this stage.

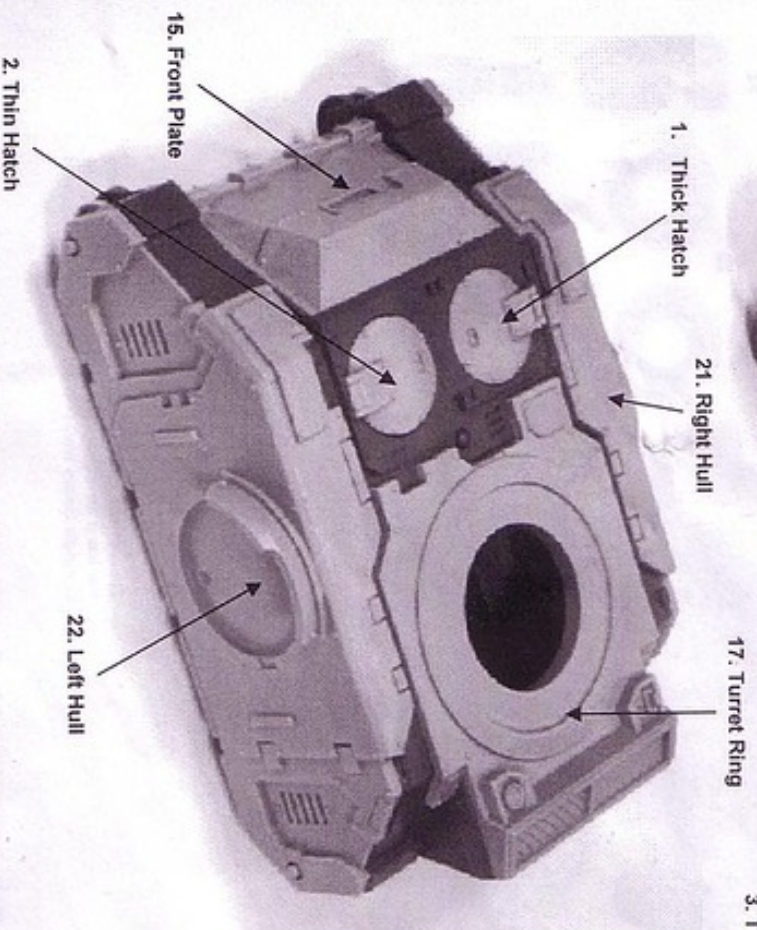
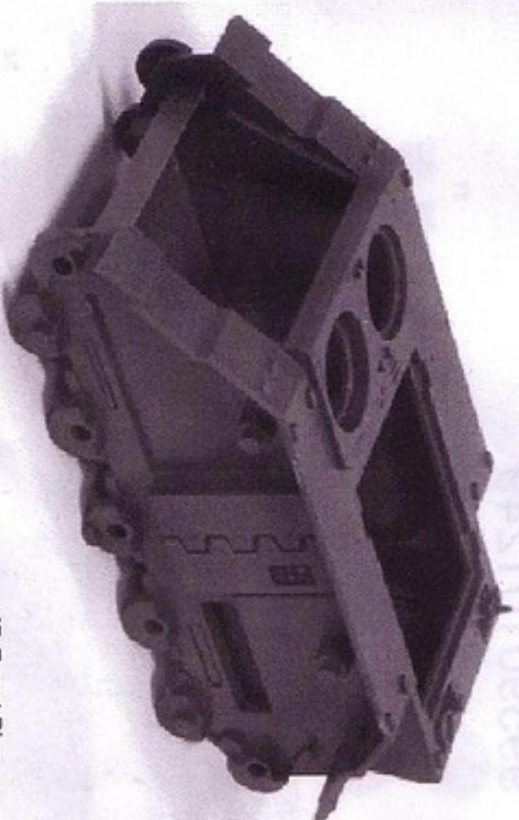

Remove the tip of the tail aerial from the sensor array and the two rivets and rectangles from the hull corners as shown.

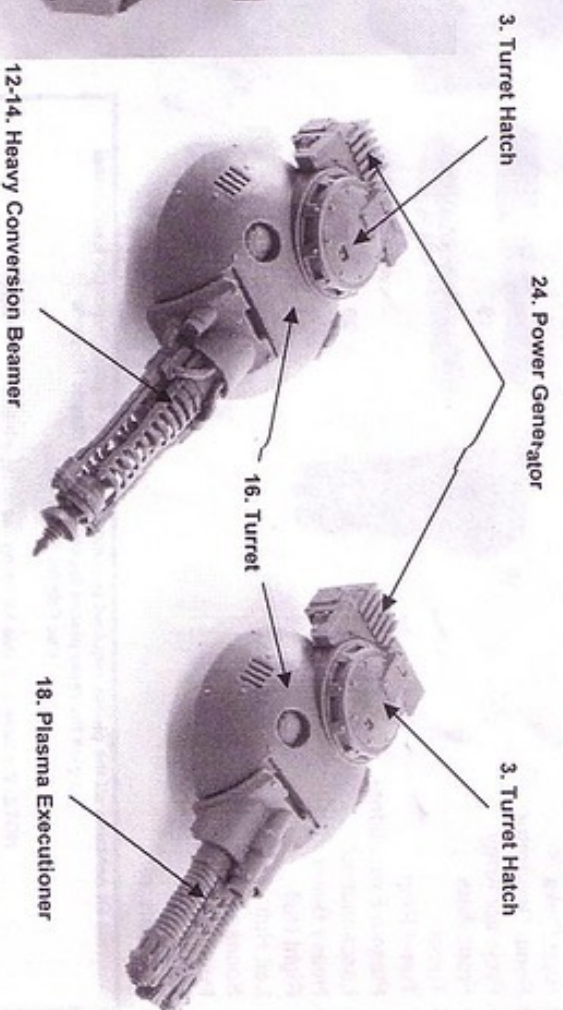
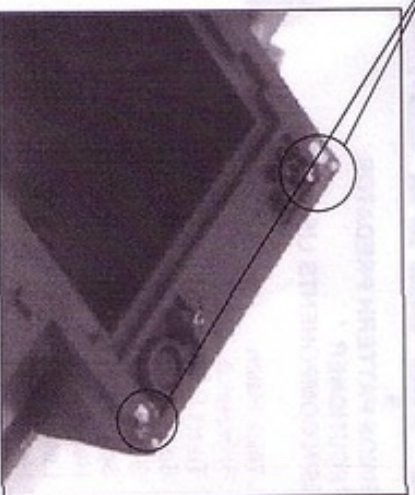
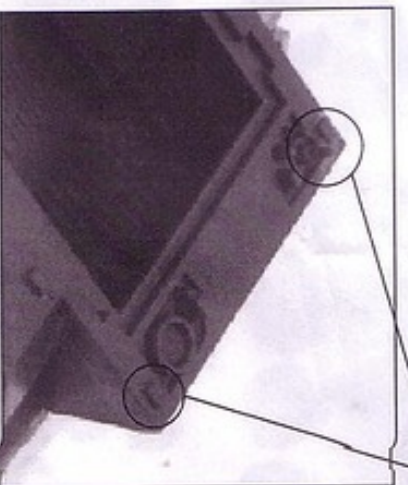

12-14. Heavy Conversion Beamer

- 6. Sponson Retaining Plate
- 23. Sponson Ring
- 4. Sponson Turret



Apply a small amount of glue here to stick the Sponson Turret

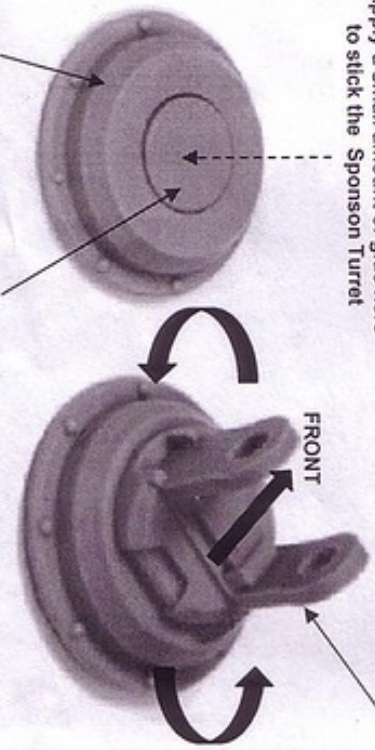

- 23. Sponson Ring
 - 6. Sponson Retaining Plate
- DO NOT GLUE

- 9. Heavy Bolter Lower Pivot
- 11. Sponson Targeter
- 20. Heavy Bolter

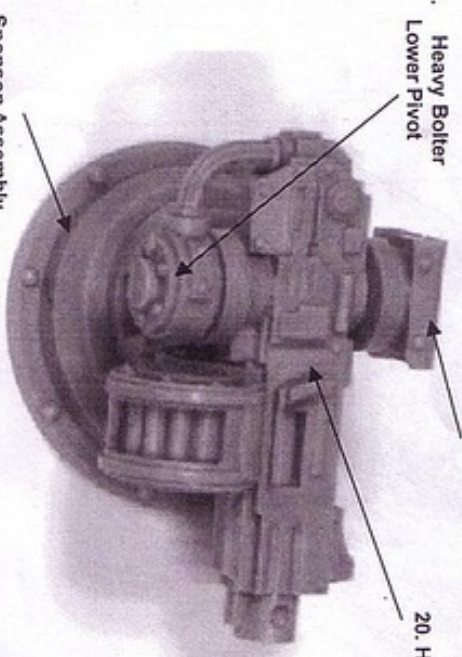

The Targeter and the lower pivot should be glued into the body of the chosen weapon. Avoid getting glue on the Turret Sponson so that the weapon will traverse.

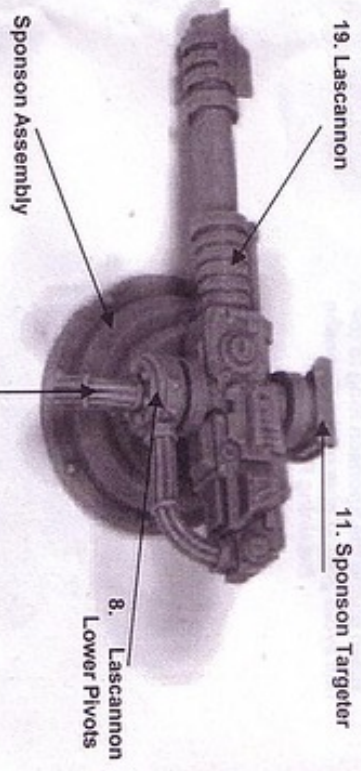

10. Lascannon Power Cables
Only glue square end to the Sponson Turrets, allowing Lower Pivot to rotate.

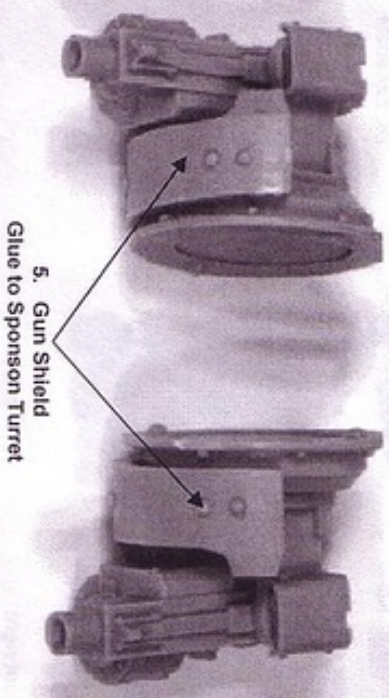
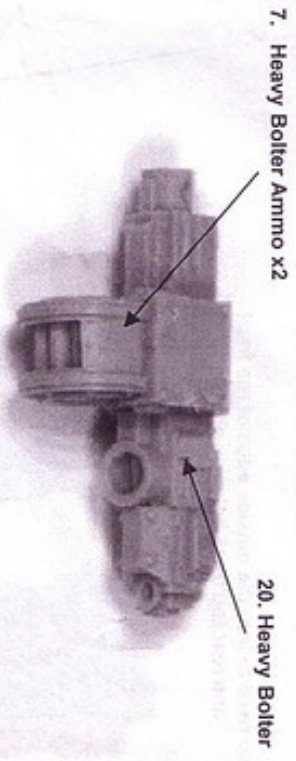

The Sponson Pivot can be loose so blutack or similar adhesive putty can be used, which should provide some resistance against the hull.

When gluing the Sponson Ring to the hull avoid getting glue on the Sponson Retaining Plate

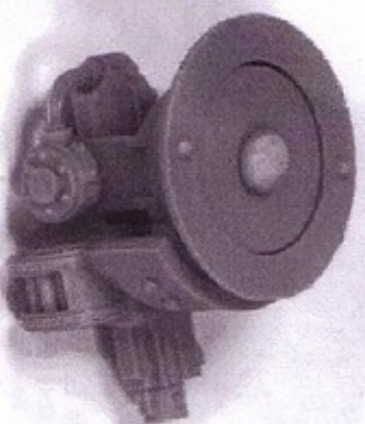

You need to trim the outside edge of the front and rear top track links, as shown



Rear right



Rear Left



Front right



Front Left

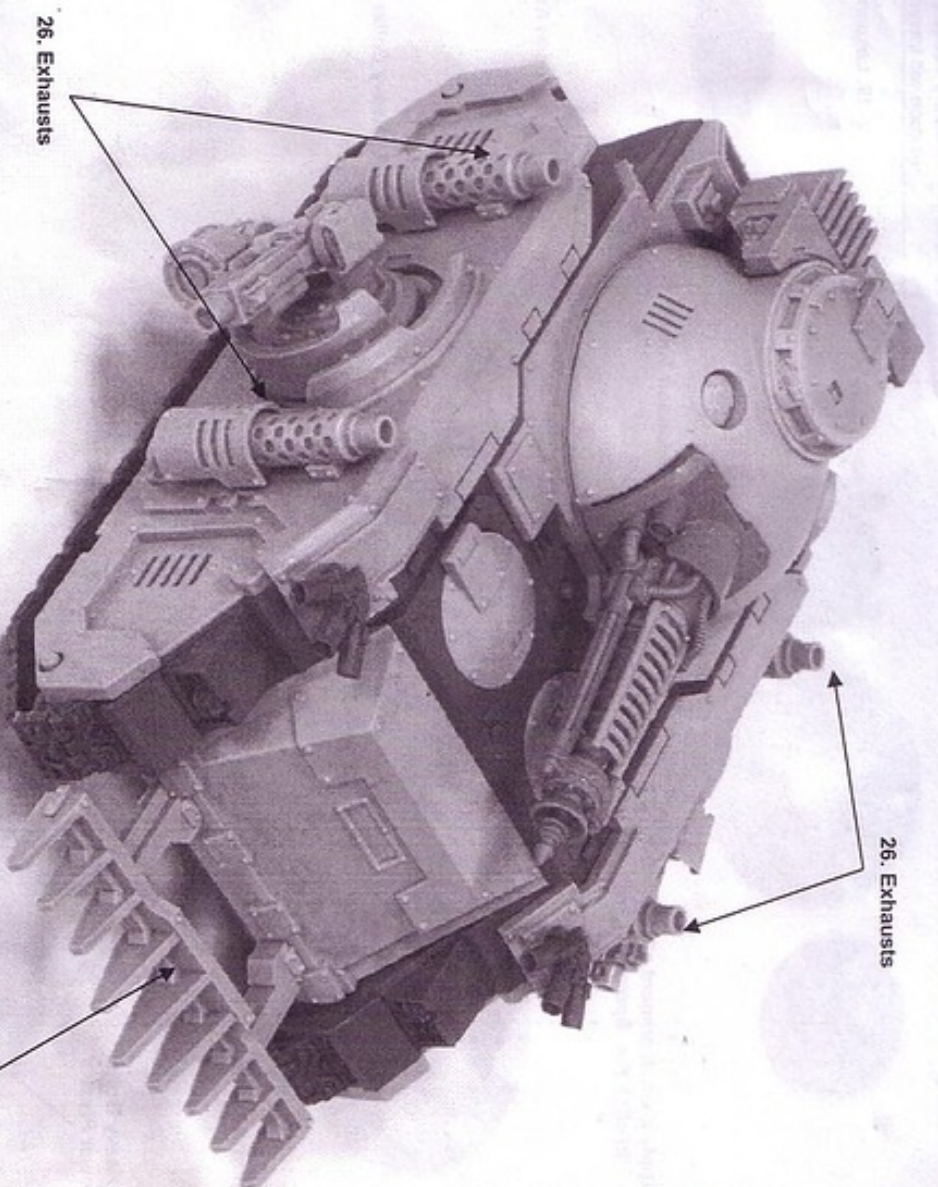

26. Exhausts

26. Exhausts

25. Ram